

Process ID# 43905

Ward of Naparima
County of Victoria
Cadastral Sheet 53.E.
BEL AIR 4/c

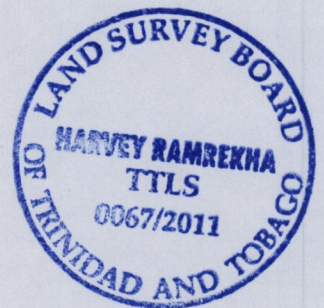
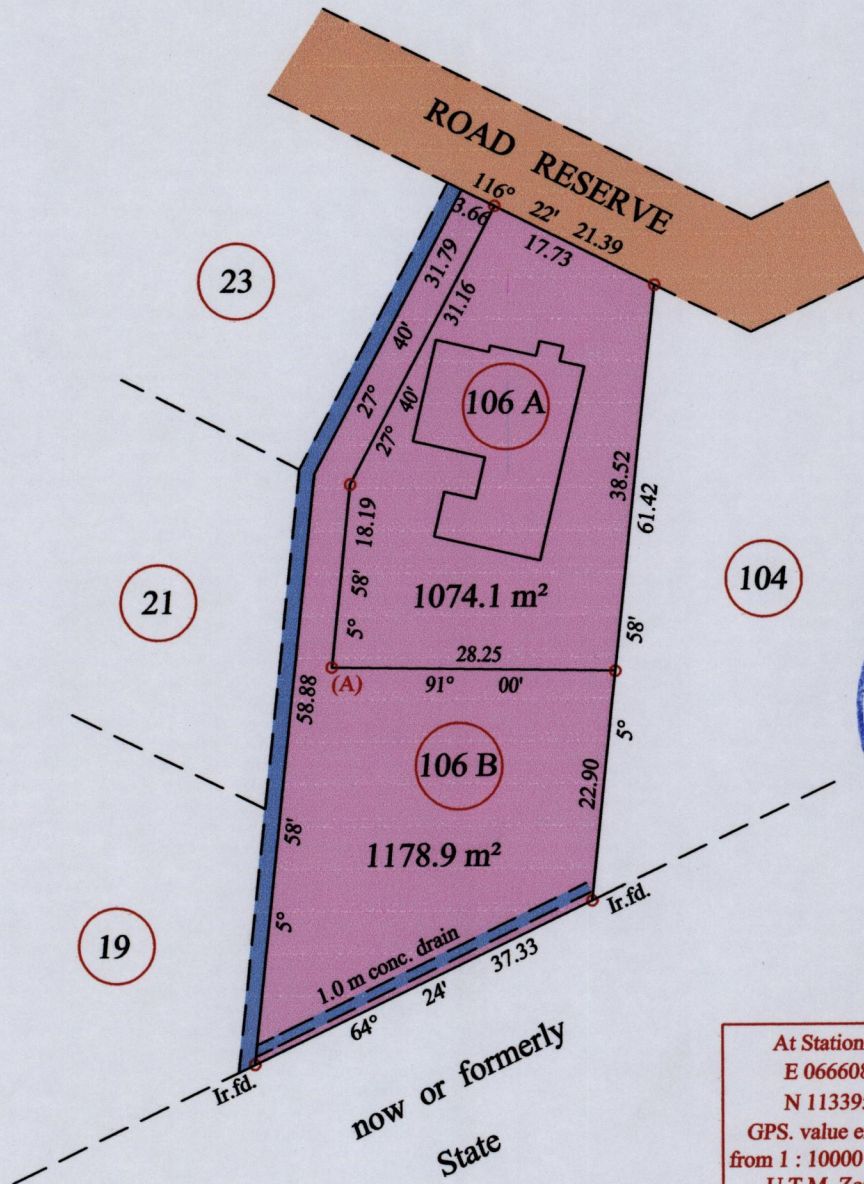

At Station (A)
E 0666088
N 1133959
GPS. value extracted
from 1 : 10000 wardsheet
U.T.M. Zone 20
Naparima
± 10 m.

Vide Plan. R.A. 27

○ Denotes Iron put except stated otherwise.

SCALE : 1:750

Note: Bearings are cassini grid based on solar observations

Distances are in metres

PLAN of 2 Parcel of land coloured pink in the Ward of Naparima

Containing together two thousand two hundred and fifty three point zero square metres

Surveyed by me, with due authority, in September 2011 for Mr. Rampersad Gopeesingh

In accordance with Regulation 25 (1) of the Land Surveyors' Regulations 1998,

I certify that this plan is correct.

Checked by

Entered on Trinidad & Tobago Land Surveyor 29.09 2011

