

Process ID# 43888

1548

61

Ward of Ortoire  
County of Victoria

Assesment No. X. 28

Cadastral Sheet ( G. 5 J. ) 54 E.  
4 / a

Z = N. 1135544 E. 684002  
U.T.M. Zone 20 Naparima +/- 5.00 m.  
Hand Held G.P.S.

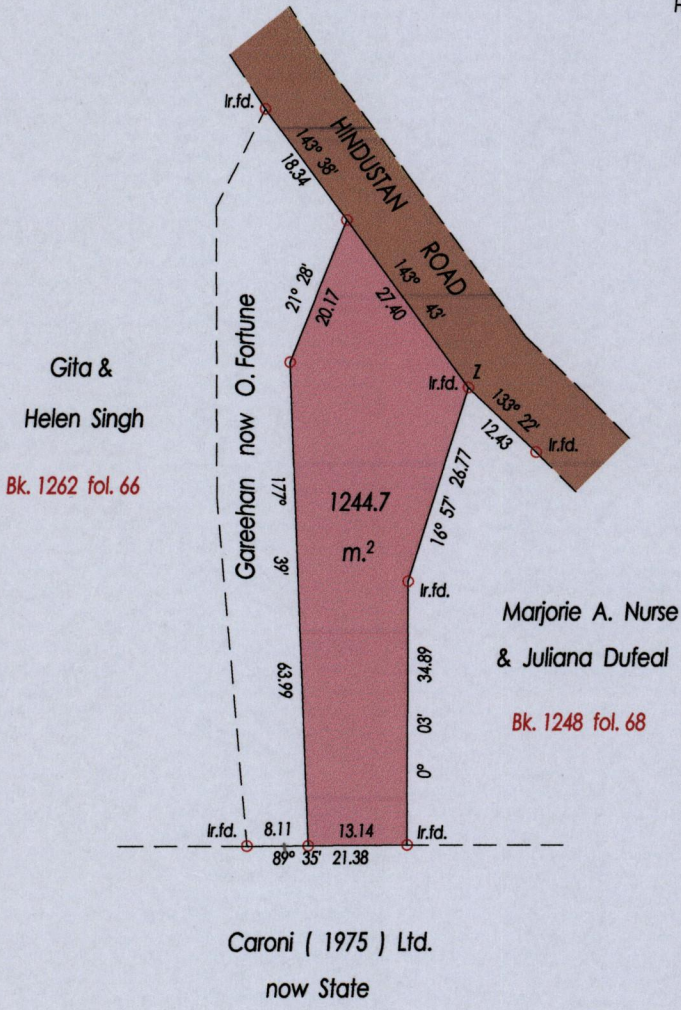

○ Denotes Iron Put Except Stated Otherwise

SCALE 1 : 1000

Bearings are Cassini Grid based on Solar Observations Distances are in Metres  
 PLAN of a Parcel of land coloured pink in the Ward of Ortoire  
 Containing one thousand two hundred and fouty four point seven sq. metres  
 Surveyed by me, with due authority in, Sept. 2011 at the request of J. Jankee  
 In accordance with Regulation 25 (1) of the Land Surveyors' Regulations 1998,  
 I certify that this plan is correct.

*[Handwritten Signature]*  
 19<sup>th</sup> September 2011

Entered on..... Trinidad & Tobago Land Surveyor..... 2011

