

Ward of Naparima  
 County of Victoria  
 Cadastral Sheet (G.9.F) 64.A.

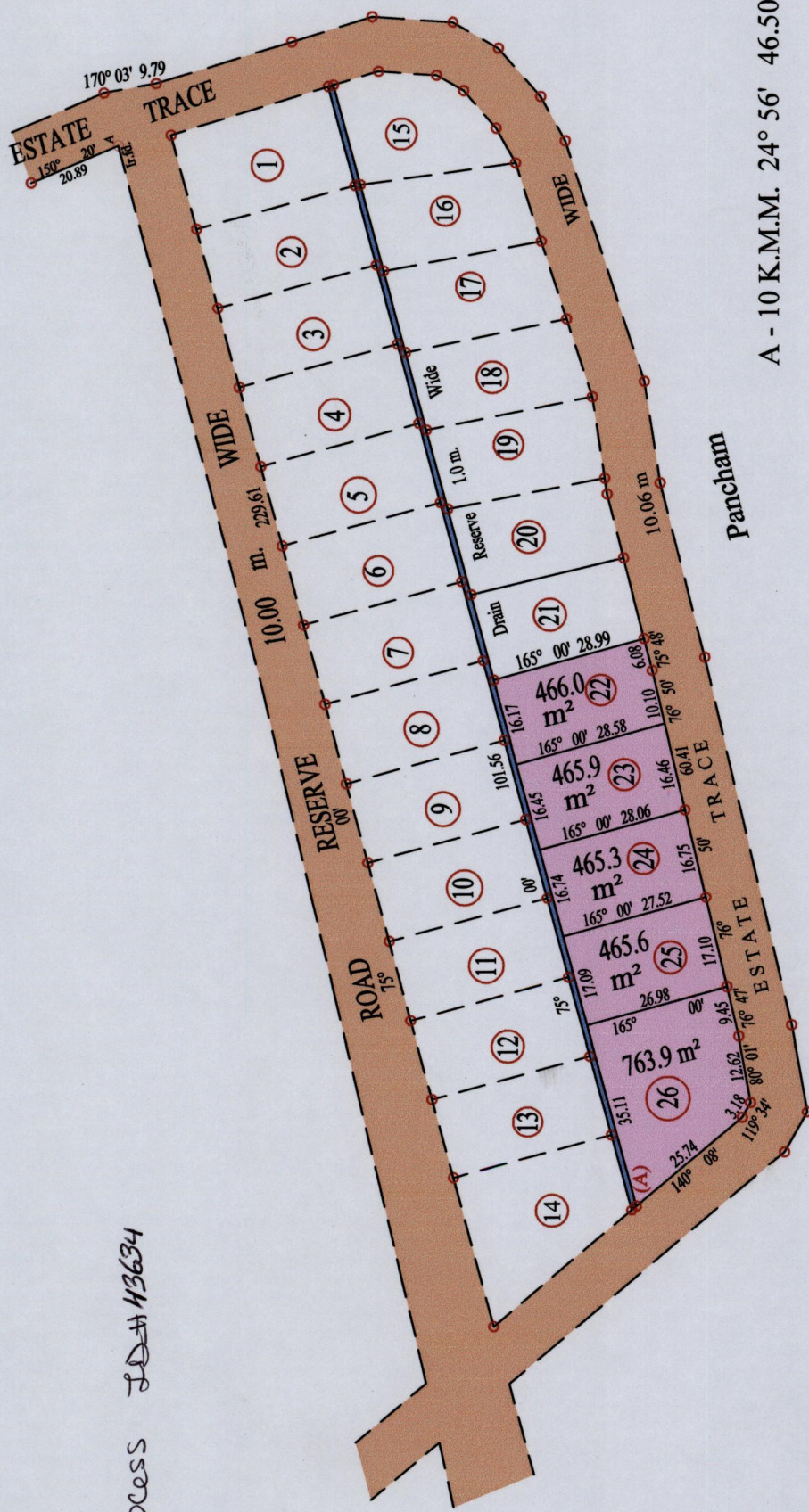
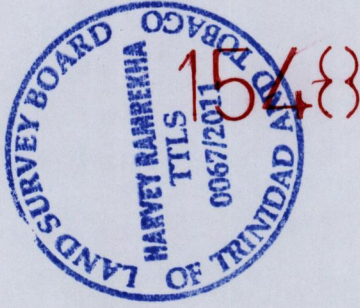
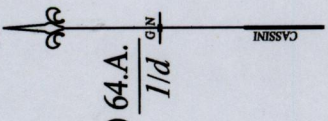

A - 10 K.M.M. 24° 56' 46.50

Vide Bk. 769 fol. 264

At Station (A)  
 E 0676326  
 N 1131414  
 Reading taken with  
 Handheld G.P.S.  
 U.T.M. Zone 20  
 Naparima  
 + 5 m.

Process ID # 43634

SCALE 1:1250

○ Denotes Iron put except stated otherwise.  
 Note: Bearings are cassini grid based on solar observations Distances are in metres  
**PLAN of 5 Parcels of land coloured pink in the Ward of Naparima**  
 Containing two thousand six hundred and twenty six point seven square metres  
 Surveyed by me, with due authority, in September 2009 Mrs. Pancham  
 In accordance with Rule 25 (1) of the Land Surveyors' Regulation 1998,  
 I certify that this plan is correct.

MINISTRY OF AGRICULTURE  
 Survey & Mapping Division  
 #132 SEP 16 2011  
 LANDS & MARINE RESOURCES

Checked by .....  
 Entered on ..... Trinidad & Tobago Land Surveyors ..... 2011