

Process ID# 49061

1548 City of San Fernando

34

R.D. No.:

County of Victoria

U.P.I.N. No.:

Cadastral Sheet 53C G.3.E.  
3/d

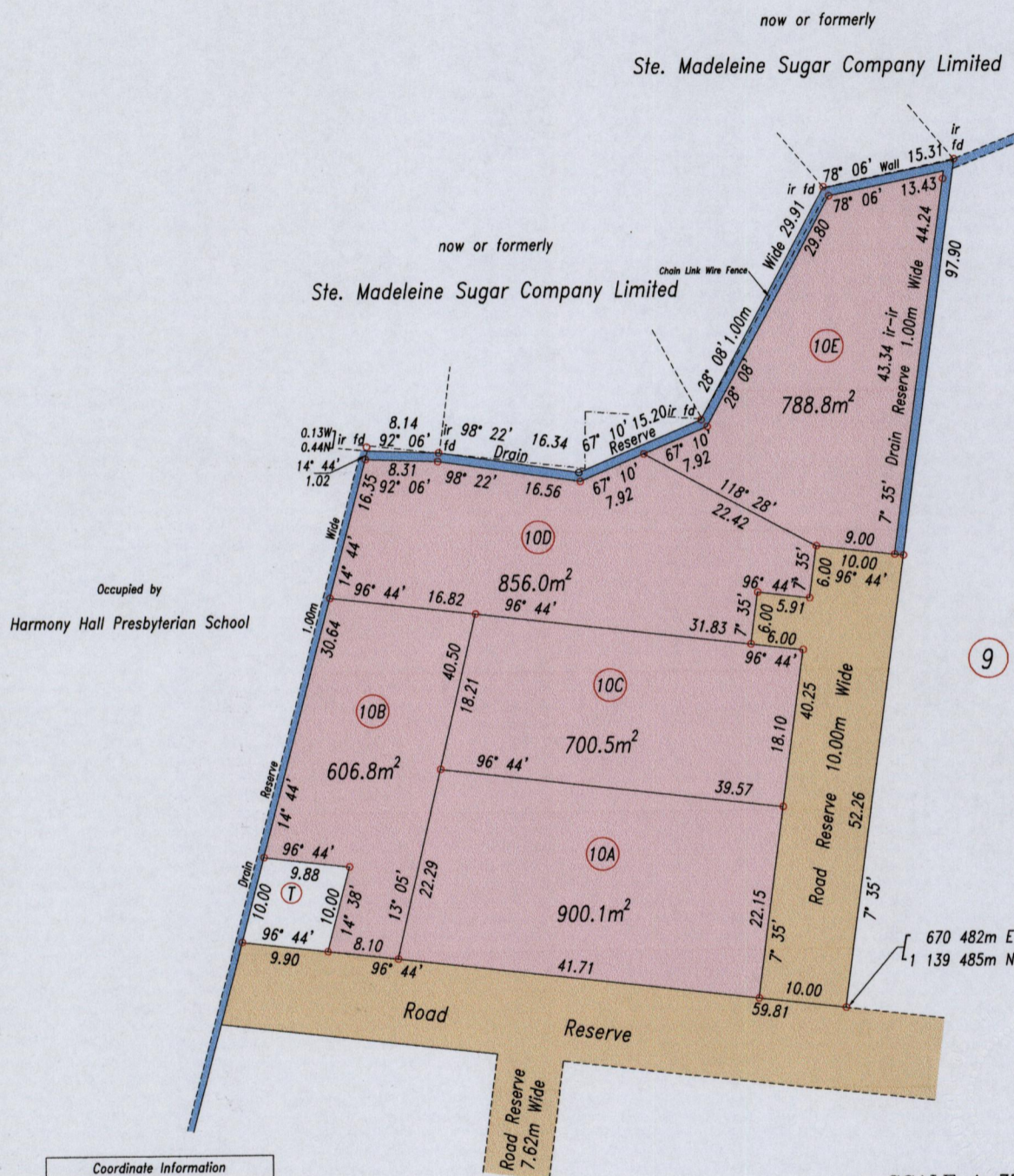

Coordinate Information
Source: GPS (Hand Held)
Error Statement: +/- 5m
Datum: UTM (Zone 20) Naparima

SCALE 1: 750

Distances are in metres

Denotes iron put except otherwise stated

Bearings are Cassini Grid based on Solar Observations

PLAN of 5 parcels of land coloured pink in the City of San Fernando  
 Containing together three thousand eight hundred and fifty two point two square metres  
 Surveyed by me, with due authority, in July & August 2009 at the request of Amzad Ali

In accordance with Regulation 25(1) of the Land Surveyors' Regulations 1998, I certify that this plan is correct.

Entered:

*L.A. Rippland*  
 Trinidad & Tobago Land Surveyor 12/2/2011

LANDS & MARINE RESOURCES  
 #267  
 1106 29 2011

