

U.P.R.N.....

Coordinates

Ir.fd. D : N 1137829
E 674062

Error Statement : ±4m

Datum Definition : U.T.M. Zone 20 Naparima

Source : Magellan Hand Held GPS

Process ~~14~~ 42810

Ward of Naparima
County of Victoria
Cadastral Sheet (G.4.E.), 53F
2/b
Parcel Address: Lp.#1B Chapie Street,
Mt. Stewart, Princes Town.

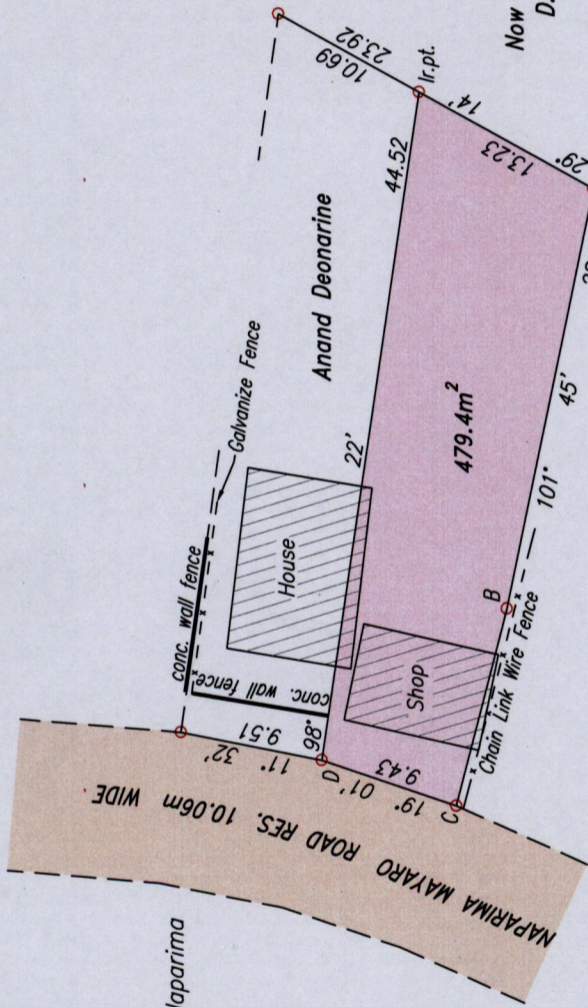

Now or Formerly
Philip Ramlogan

C-B 104° 27' 13.43

Ref: Deed No. 2132 of 1955

SCALE 1:500

Distances are in metres.

○ Denotes Iron found except stated otherwise.

Note: Bearings are U.T.M. Grid based on solar observations.

Plan of a Parcel of land coloured pink in the Ward of Naparima, containing four hundred and seventy nine point four square metres. Occupied by Anand Deonarine, Surveyed by me, with due authority, in November 2009 & February 2011 at the request of Anand Deonarine.

In accordance with Regulation 25(1) of the Land Surveyors' Regulations 1998,

I certify that this plan is correct.

Entered

Trinidad & Tobago Land Surveyor 10.A.S...2011



MINISTRY OF AGRICULTURE
Survey & Mapping Division

#203

AUG 23 2011

LANDS & MARINE RESOURCES

L & S SURVEYING SERVICES LIMITED

15483

24