

Process ID# 50925

1548

Ward of Naparima
County of Victoria
Cadastral Sheet G. 8 N.)

63 C.
3/c

2007

REDEFINITION SURVEY

Z = N. 1128487 E. 669345
U.T.M. Zone 20 Naparima +/- 5.00 m.
Hand Held G.P.S.

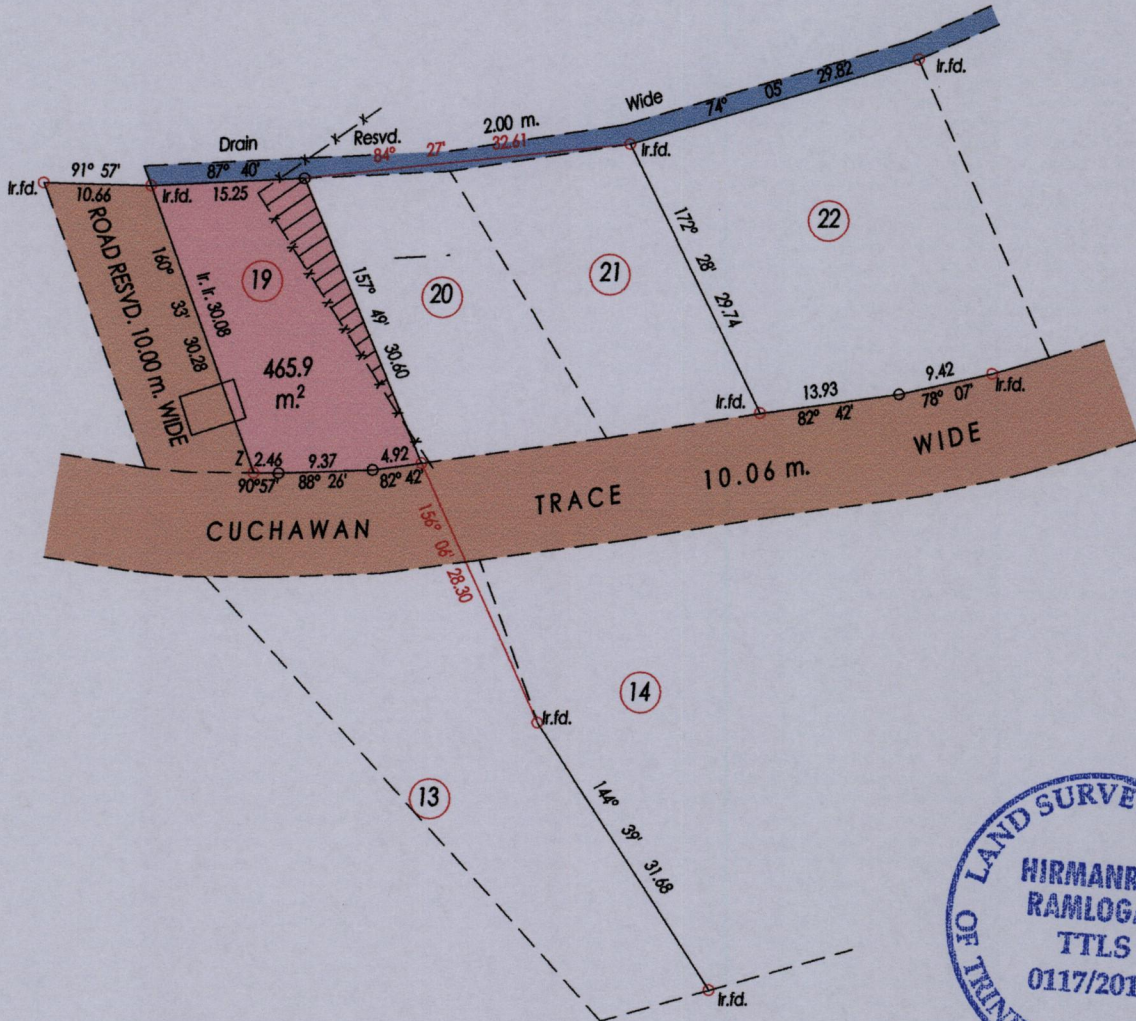
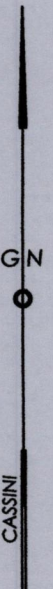

C.T. Vol. 1656 fol. 9

Hatched Portion Encroachment
Encroached Area 66.4 m.²

—x—x—x—x—x—x—x—
wire fence



○ Denotes Iron Put Except
Stated Otherwise

SCALE 1 : 750

Bearings are Cassini Grid based on Solar Observations Distances are in Metres
PLAN of a Parcel of land coloured pink in the Ward of Naparima
Containing four hundred and sixty five point nine sq. metres
Re-defined by me, with due authority in, March 2012 at the request of Sabita Harry
In accordance with Regulation 25 (1) of the Land Surveyors' Regulations 1998,
I certify that this plan is correct.

... *Hirmanram Ramlogan* ...

Entered on.....

Trinidad & Tobago Land Surveyor 14th March, ... 2012

