

Process ID# 50436

1548

Ward of Naparima

County of Victoria

Cadastral Sheet (G7C) 63 B  
1/b

2006

G.N

U.T.M.

N: 1132644  
E: 665245  
Hand Held GPS.  
Naparima Datum (+/-5m)  
UTM Zone 20.

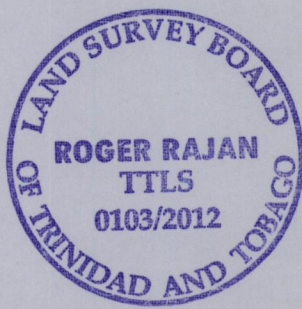
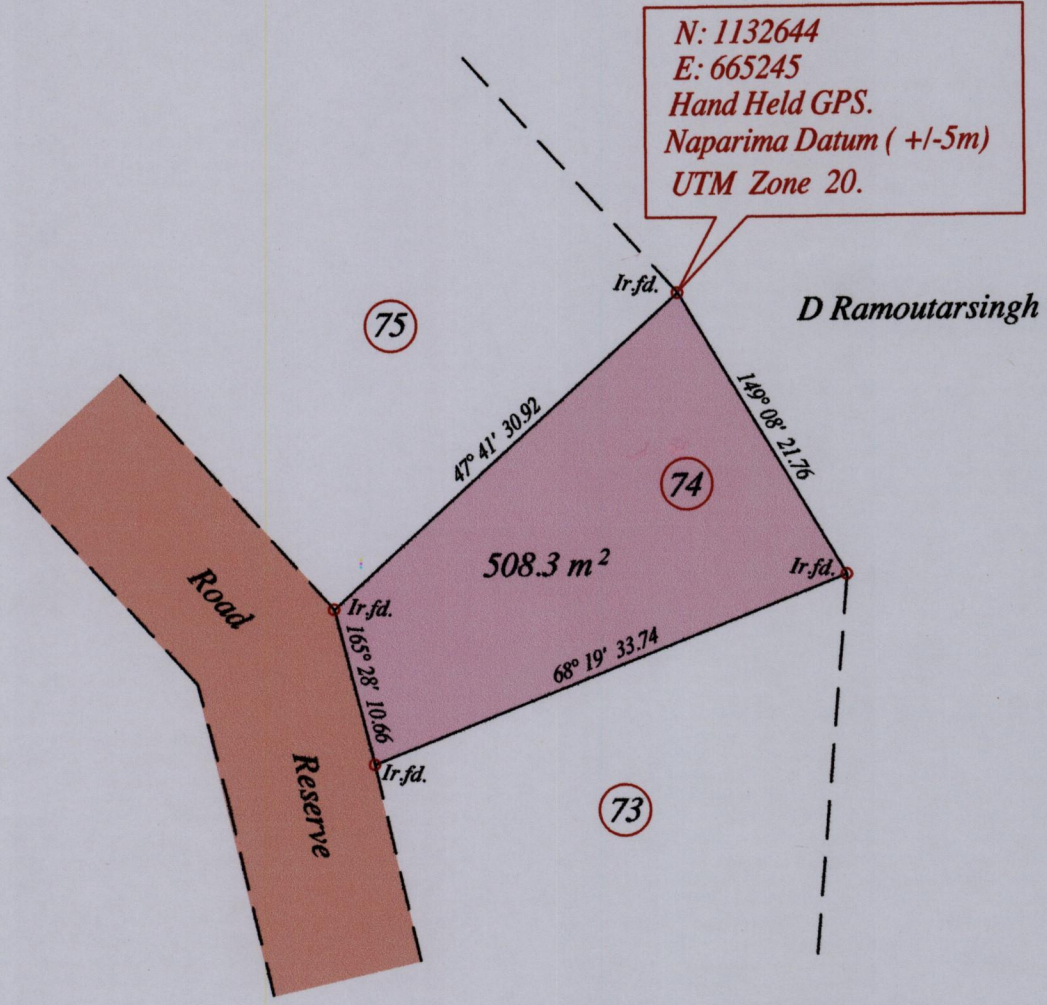

○ Denotes Iron put except stated otherwise.

SCALE : 1:500

Note: Bearings are U.T.M. grid based on solar observations Distances are in metres

PLAN of a Parcel of land coloured pink in the Ward of Naparima  
Containing five hundred and eight point three square metres  
Re-defined by me, with due authority, in March 2012 at the request of Gulf Real Estate Ltd.  
In accordance with Regulation 25 (1) of the Land Surveyors' Regulations 1998,  
I certify that this plan is correct.

*[Signature]*  
.....

MINISTRY OF FOOD PRODUCTION  
LAND AND MARINE AFFAIRS  
MAR 13 2012  
#132 RR  
Lands & Surveys Division

Entered on ..... Trinidad & Tobago Land Surveyor ..... 2012