

Process ~~IDA~~ 50465

1548

2012

U.P.I.N. No.:

Ward of Naparima

County of Victoria

Cadastral Sheet G.8.A. $\frac{53E}{4/c/4}$

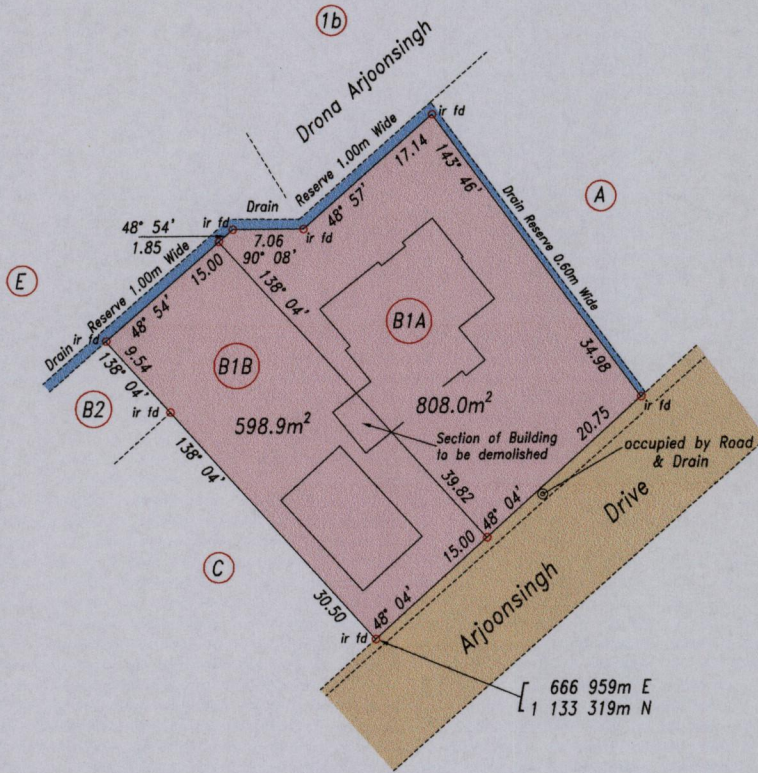
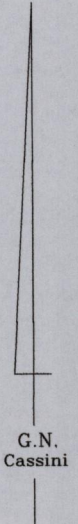

Source: GPS (Hand Held)
 Error Statement: +/- 5m
 Datum: Naparima, UTM (Zone 20).

SCALE 1: 750

Distances are in metres

o Denotes iron put except otherwise stated

Bearings are Cassini Grid based on Solar Observations

PLAN of 2 parcels of land coloured pink in the Ward of Naparima
 Containing together one thousand four hundred and six point nine square metres
 Surveyed by me, with due authority, in February 2012 at the request of Drona Arjoonsingh

In accordance with Regulation 25(1) of the Land Surveyors' Regulations 1998, I certify that this plan is correct.

Entered:

L.A. Roopchand
 28/2/2012
 Trinidad & Tobago Land Surveyor

MINISTRY OF FOOD PRODUCTION
 LAND AND MARINE AFFAIRS
 MAR - 9 2012
 472 GP
 Lands & Surveys Division

LAND SURVEY BOARD
 LYNN ROOPCHAND
 TTLS
 0071/2012
 OF TRINIDAD AND TOBAGO

442