

1548

20

U.P.I.N. No.:

Cadastral Sheet 63B  
2/b

Ward of Naparima

County of Victoria

Process ID# 42541

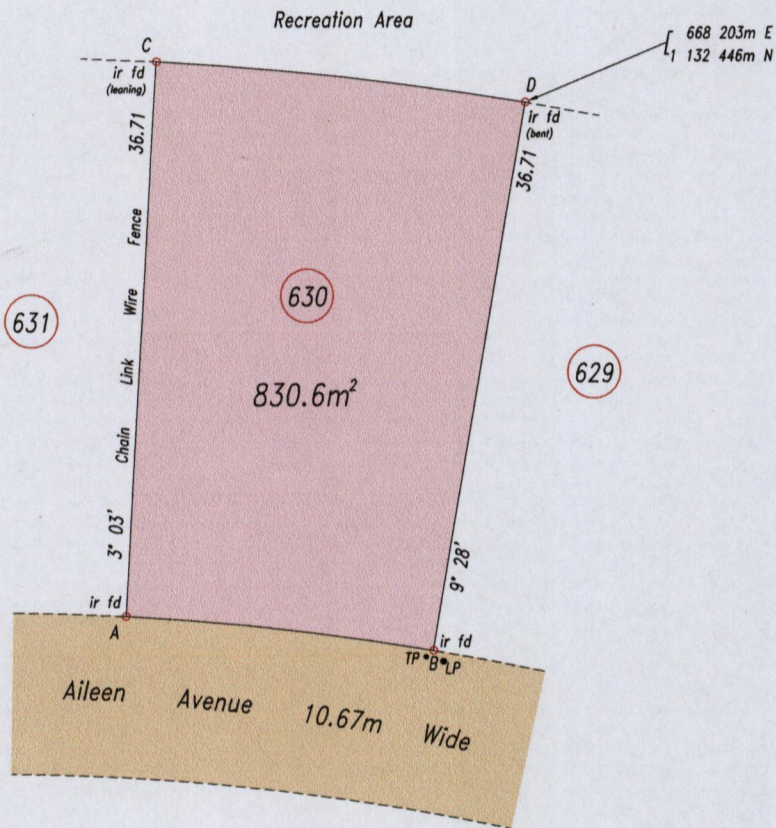
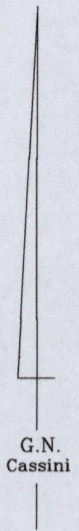

Coordinate Information	
Source:	GPS (Hand Held)
Error Statement:	+/- 5m
Datum:	UTM (Zone 20) Naparima

Sta. - Sta.	Chord Bearing	Chord Distance	Radius
A - B	96° 22'	20.56	179.96
C - D	96° 21'	24.67	216.67

Reference: Plan XE 75

SCALE 1: 500

Distances are in metres

o Denotes iron put except otherwise stated

Bearings are Cassini Grid based on Solar Observations

PLAN of a parcel of land coloured pink in the Ward of Naparima  
Containing eight hundred and thirty point six square metres

Surveyed by me, with due authority, in August 2011 at the request of Dr. Balaji Manduru

In accordance with Regulation 25(1) of the Land Surveyors' Regulations 1998, I certify that this plan is correct.

Entered:

*L.A. Piree*  
Trinidad & Tobago Land Surveyor 15/8/2011

MINISTRY OF AGRICULTURE  
Survey & Mapping Division  
#132  
AUG 15 2011

LANDS & MARINE RESOURCES

