

Process JDA 49614

DE 2000158770BF

1548

Ward of Naparima

County of Victoria

Cadastral Sheet 63 B.
2/a

196

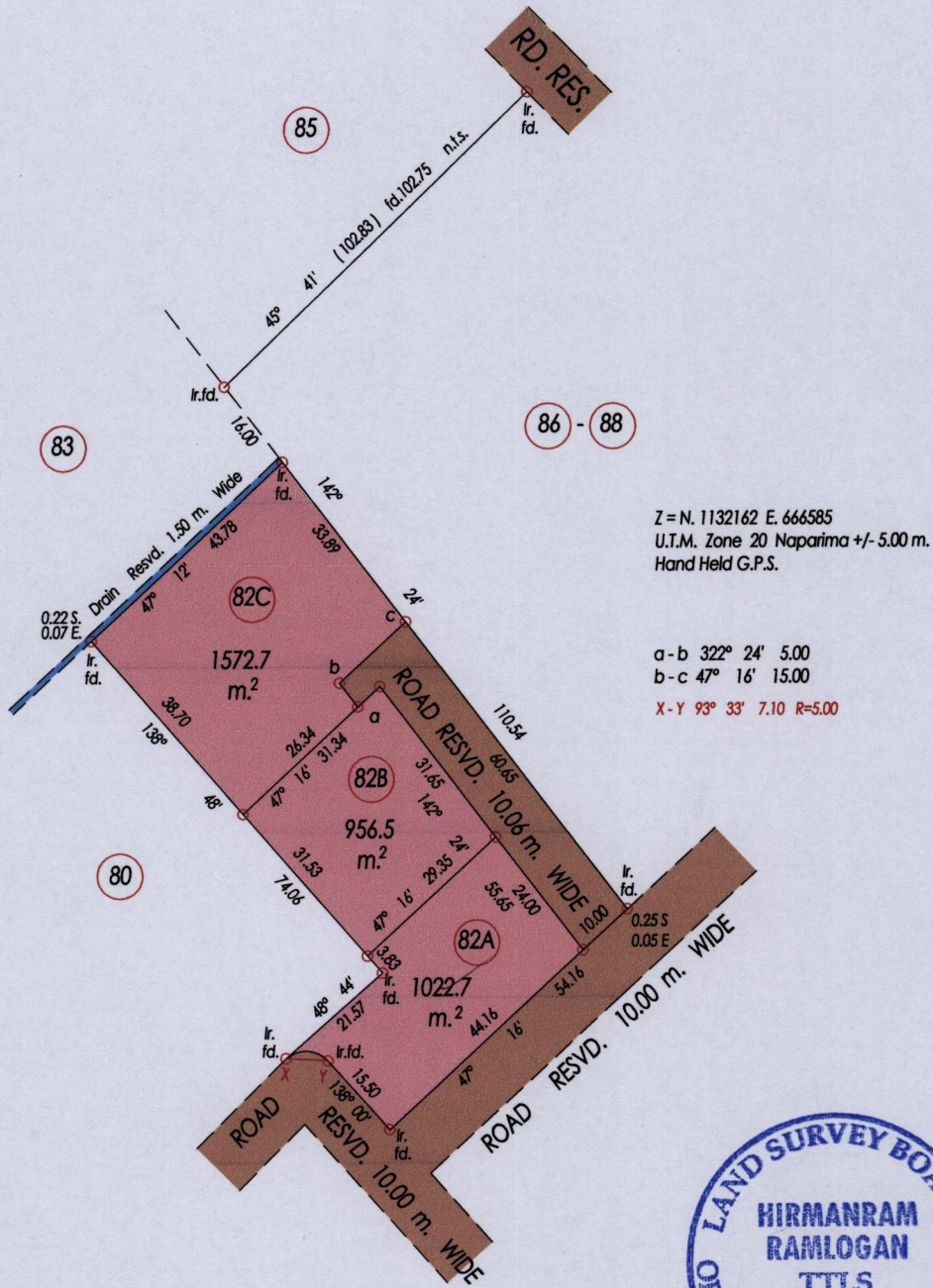

○ Denotes Iron Put Except Stated Otherwise

SCALE 1 : 1250

Bearings are Cassini Grid based on Solar Observations Distances are in Metres
 PLAN of 3 Parcels of land coloured pink in the Ward of Naparima
 Containing three thousand five hundred and fifty one point nine sq. metres
 Surveyed by me, with due authority in, Feb. 2012 for B. Seepaul.
 In accordance with Regulation 25 (1) of the Land Surveyors' Regulations 1998,
 I certify that this plan is correct.

Hirmanram Ramlogan

Entered on.....

Trinidad & Tobago Land Surveyor 27th February, 2012

