

Process ID# 47864

1548

156

Amended Plan

Cadastral Sheet G.4.J. 54D
3/b

Reg. Deed No. 2163/1933

Ward of Naparima

County of Victoria

Malgretoute

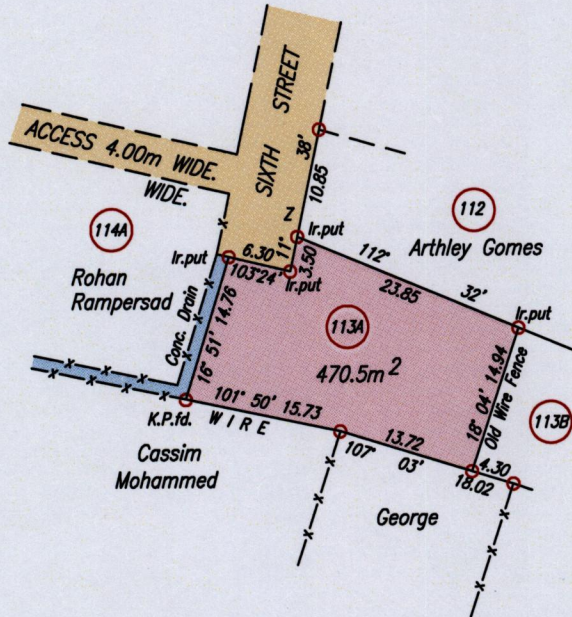
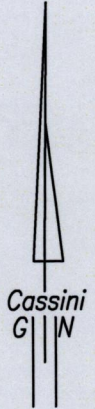

Point Z : 676294mE, 1135612mN
(U.T.M. 20, WGS 84 (+/-5m))
Coordinates obtained from
hand held GPS.



SCALE 1:750

Distances are in metres

- x-x-x- Denotes Wire Fence
- o Denotes Iron found except otherwise stated
- Bearings are Cassini Grid based on Solar Observations
- PLAN of a Parcel of land coloured pink in the Ward of Naparima
- Containing four hundred and seventy point five square metres
- Surveyed by me, with due authority, in December, 2011 for Ramsaran Moonan
- In accordance with Regulation 25 (1) of the Land Surveyors' Regulations 1998,
- I certify that this plan is correct.

Winston Ramcharan

Entered on.....

Trinidad & Tobago Land Surveyor. . 23rd Dec 2011.

