

1548

15

Process ID# 42457

Ward of Naparima

County of Victoria

Cadastral Sheet ( G.8.P )  $\frac{63.C.}{4/d}$

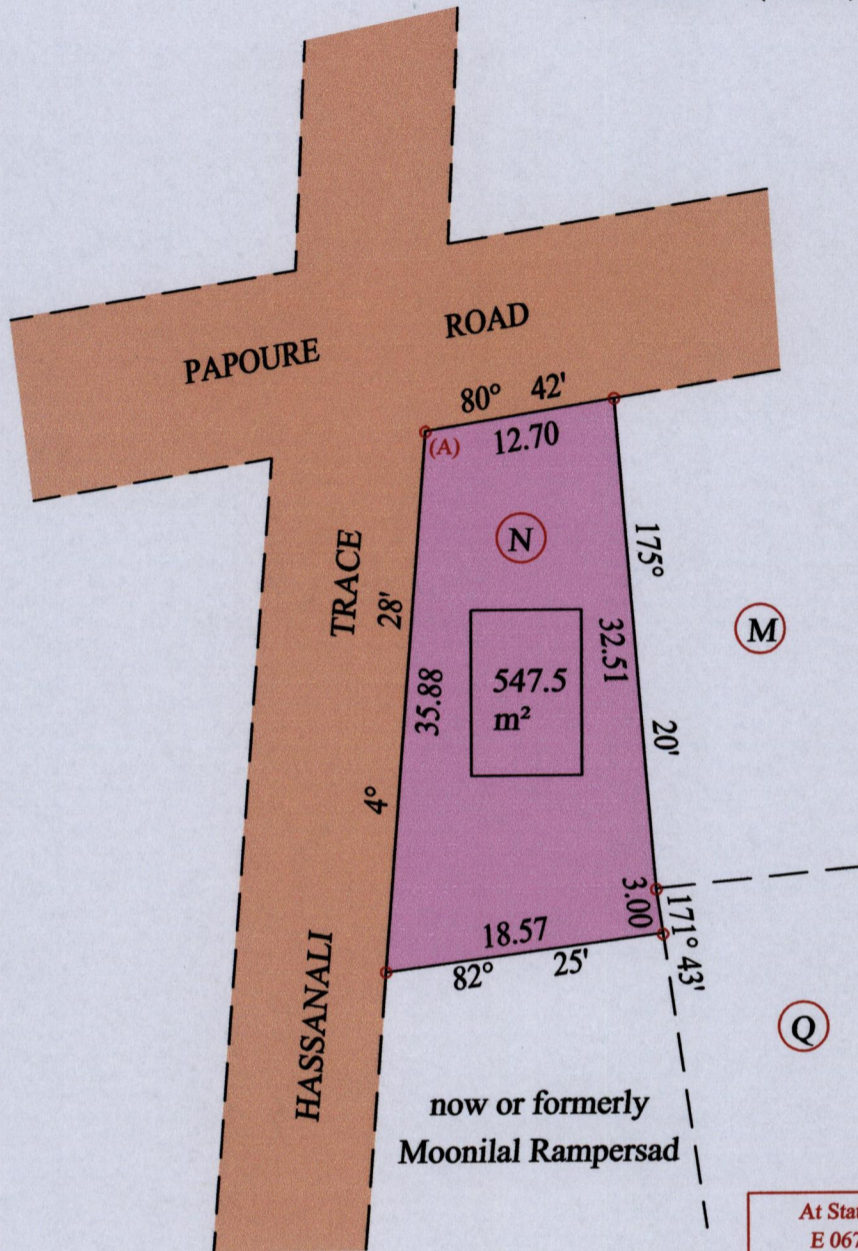

At Station (A)  
 E 0673835  
 N 1128550  
 Reading taken with  
 Handheld G.P.S.  
 U.T.M. Zone 20  
 Naparima  
 ± 10 m.

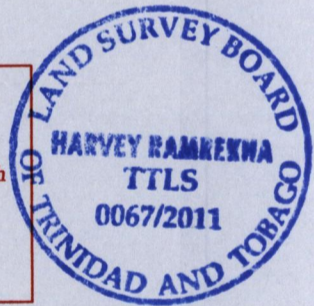

Vide Plan J. C. 93

○ Denotes Iron put except stated otherwise.

SCALE : 1:500

Note: Bearings are cassini grid based on solar observations Distances are in metres

PLAN of a Parcel of land coloured pink in the Ward of Naparima  
 Containing five hundred and forty seven point five square metres  
 Surveyed by me, with due authority, in January 2007 for Moonilal Rampersad  
 In accordance with Regulation 25 (1) of the Land Surveyors' Regulations 1998,  
 I certify that this plan is correct.

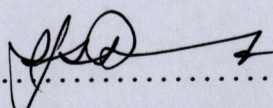
Checked by .....  .....

Entered on ..... Trinidad & Tobago Land Surveyor ..... 10 . 08 . 2011

