

Process ~~SD#~~ 42408

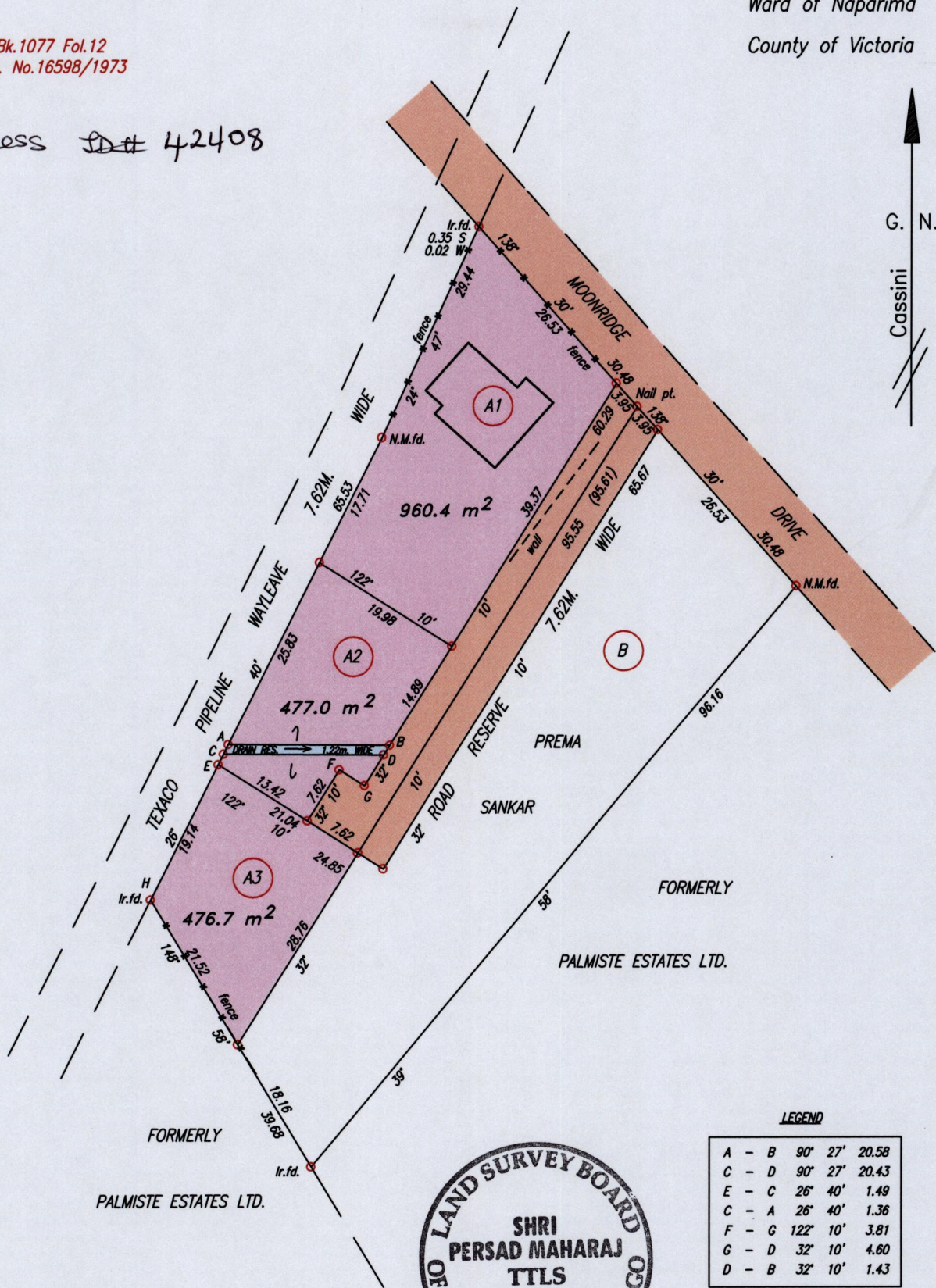

LEGEND

A - B	90° 27'	20.58
C - D	90° 27'	20.43
E - C	26° 40'	1.49
C - A	26° 40'	1.36
F - G	122° 10'	3.81
G - D	32° 10'	4.60
D - B	32° 10'	1.43



Point "H" = N 1132214, E 668815
Coordinates obtained by Hand Held GPS.
U.T.M. 20, NAPARIMA (+/-5.0m.)

SCALE 1:750

Distances are in metres

o Denotes Iron put except where otherwise stated

Bearings are based on Solar Observations

PLAN of 3 Parcels of land coloured pink in the Ward of Naparima

Containing together one thousand nine hundred and fourteen point one square metres

Surveyed by me, with due authority, in March 2007 & November 2009 for Ramessar Singh

In accordance with Regulation 25 (1) of the Land Surveyors' Regulations 1998,

I certify that this plan is correct.

Checked by

Shri Persad Maharaj

Entered on.

Trinidad & Tobago Land Surveyor. 4th August 2011.

