

Cadastral Sheet G.8.P., 63C
4/a

Ward of Naparima
County of Victoria

Vide: Bk.1186 Fol.116
Bk.1021 Fol.62

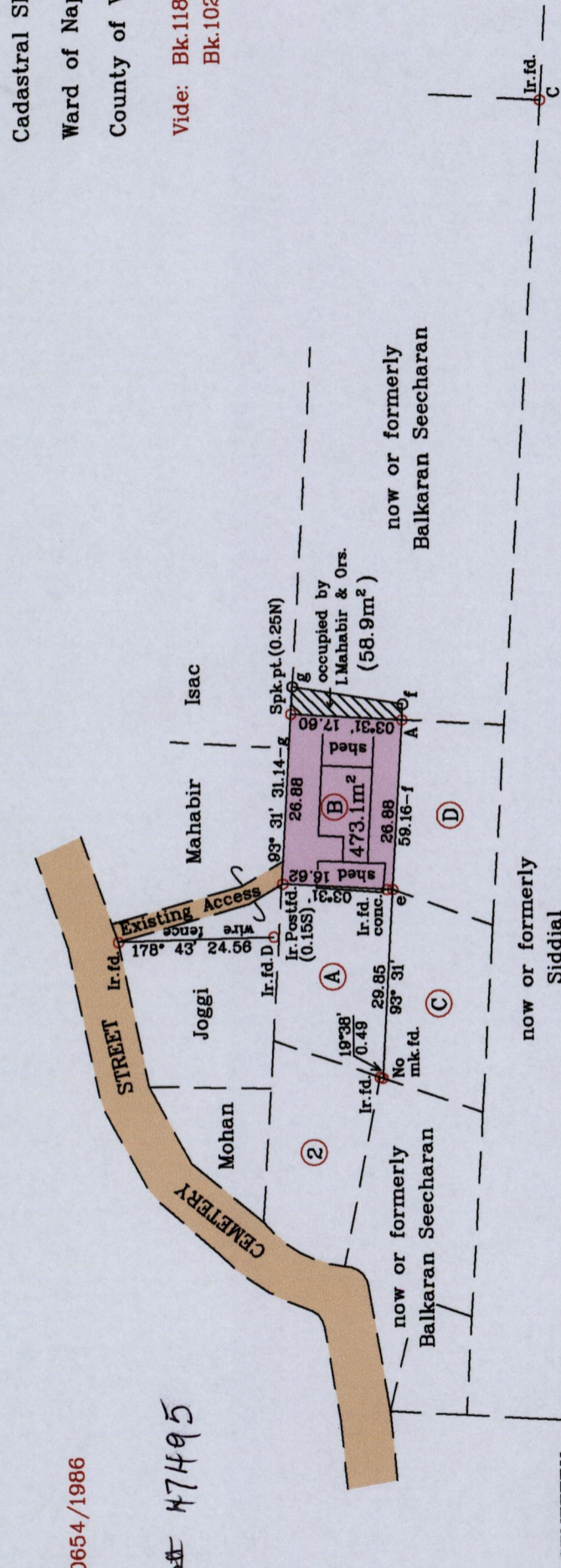
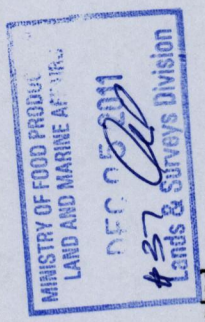
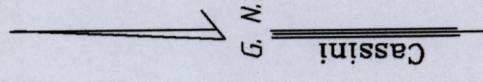

f-g 09° 27' 17.69
Ir.f.d.conc.-e 183° 31' 0.98

D-Ir.post 100° 05' 8.48

A-C 103° 06' 100.07
A-B 240° 18' 131.29(n.t.s.)

SCALE 1/1000

Distances are in metres

- o Denotes peg
- o Denotes Iron put unless otherwise stated
- Bearings are Cassini Grid based on Solar Observations

Ir.pt. A - 673012mE
- 1129235mN
UTM. Zone20,WGS84(+/-5.0m)
Hand Held G.P.S. Coordinates.

Plan of a Parcel of land coloured pink in the Ward of Naparima
Containing four hundred and seventy three point one square metres
Surveyed by me, with due authority in November 2011 for Indrawatie Mahabir & Ors.
In accordance with regulation 25 (1) of the Land Surveyors' Regulations 1998,
I certify that this plan is correct.

U.P.R.N. No.
Reg.Deed No.10654/1986

Process ~~184~~ 47495

Entered on.....
Trinidad and Tobago Land Surveyor..... 05/12/2011

Gerard Buchun