

Process ID # 47249

1548

133

U.P.R.N.....

Ward of Naparima  
County of Victoria  
Cadastral Sheet (G.3.P), 53F  
4/C

**Coordinates**

Ir.pt. A : N 1133315  
E 672144

Error Statement : ±4m

Datum Definition : U.T.M. Zone 20 Naparima

Source : Magellan Hand Held GPS

Parcel Address: #50 Peterloo Street,  
Friendship Village,  
Cipero Road

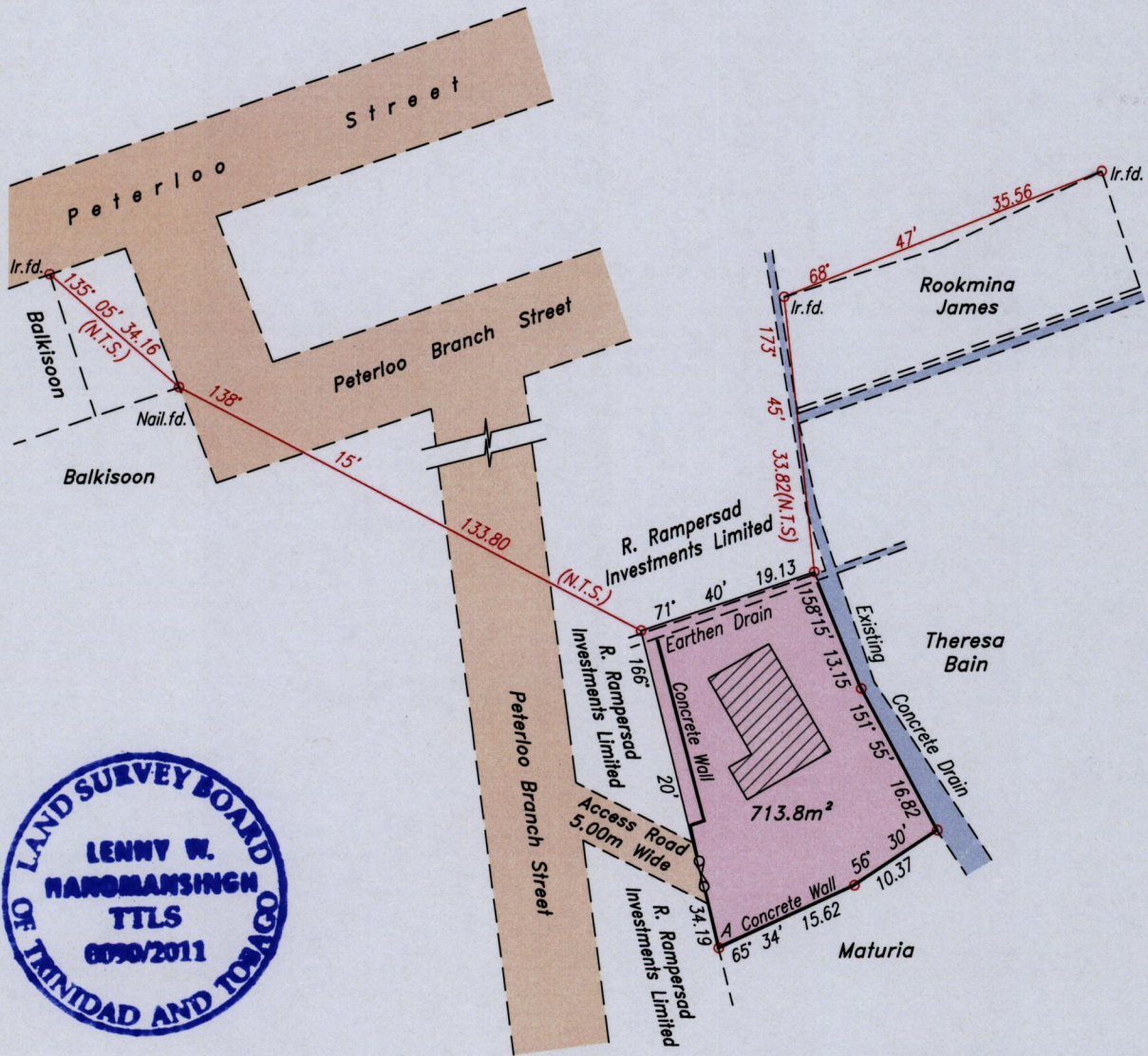
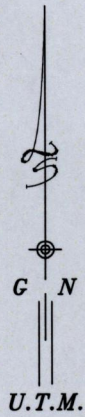

- Concrete Wall
- Building
- Gate

○ Denotes Iron put except stated otherwise.

SCALE: 1:750

Note: Bearings are U.T.M. Grid based on solar observations.

Distances are in metres.

Plan of a Parcel of land coloured pink in the Ward of Naparima  
Containing seven hundred and thirteen point eight square metres occupied by Roopchan Rajpat.  
Surveyed by me, with due authority, in May 2011 at the request of Roopchan Rajpat.  
In accordance with Regulation 25(1) of the Land Surveyors' Regulations 1998,  
I certify that this plan is correct.

*Lenny W. Ramnansingh*  
.....

Entered .....

Trinidad & Tobago Land Surveyor ..... 28/11/2011

