

Process ID# 42401

1548

Cadastral Sheet G.9.G. <sup>64A</sup>/<sub>1/d</sub>

12

Ward of Naparima

County of Victoria



G N  
Cassini

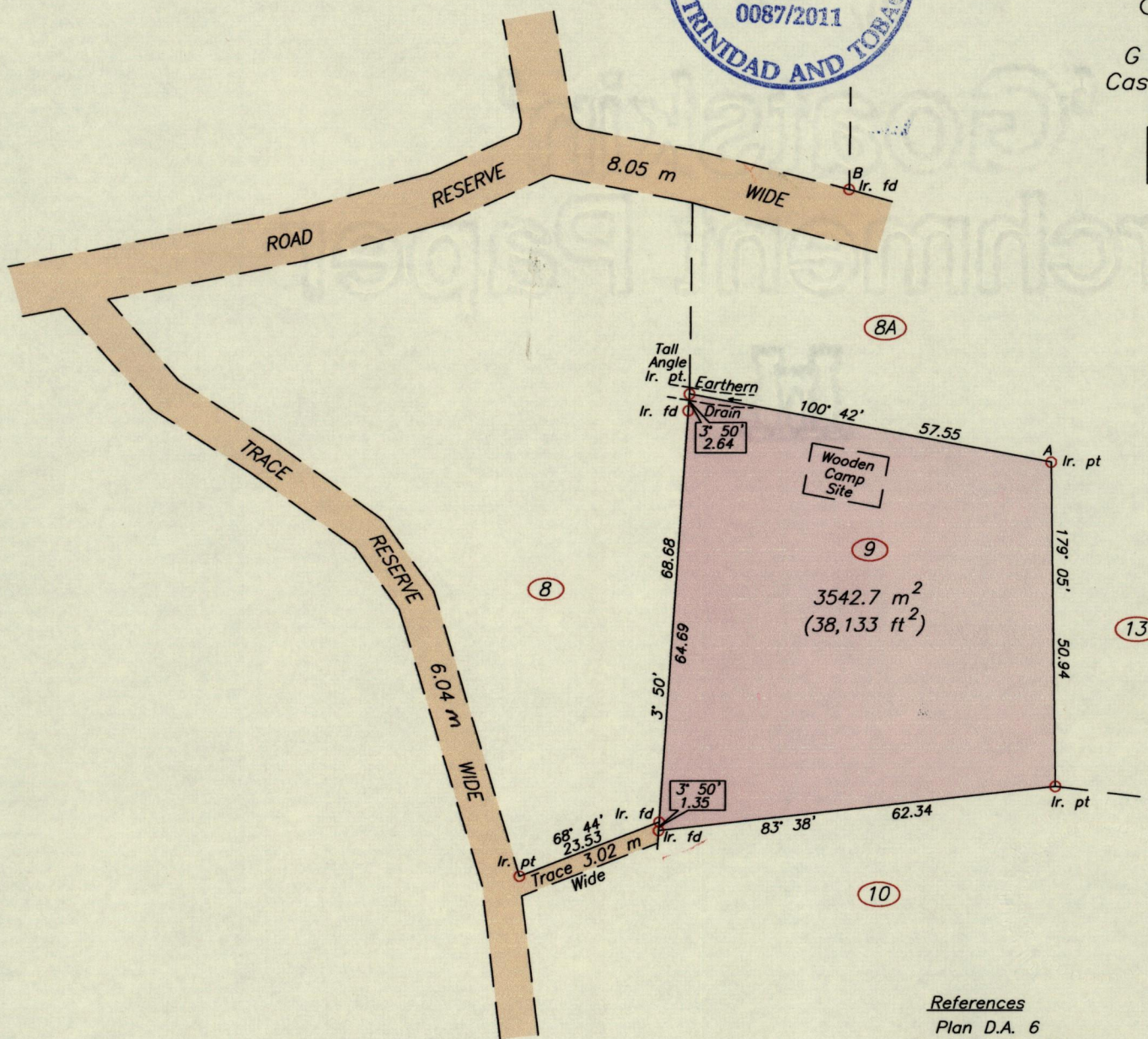

References

- Plan D.A. 6
- Bk. 1224 Fol. 69
- Bk. 1226 Fol. 19
- Bk. 1226 Fol. 20

A - B 323° 28' 53.21

A - N 1131113  
E 677033

Derived From Hand-Held GPS (+/-5 m)  
UTM Zone 20 Naparima Co-ordinates

SCALE 1:1000  
Distances are in METRES

Bearings are Cassini Grid based on Solar observations

PLAN of a Parcel of land coloured pink in the Ward of Naparima  
Containing three five four two point seven square metres  
Surveyed by me, with due authority, on 8th August, 2011 at the request of Joan Weekes  
In accordance with Regulation 25 (1) of the Land Surveyors' Regulations 1998,  
I certify that this Plan is correct.

Entered:

*Brian Moses*

Trinidad & Tobago Land Surveyor (T.T.L.S.)

8th Aug 2011

MINISTRY OF AGRICULTURE  
Survey & Mapping Division  
#60 RR  
AUG 08 2011  
LANDS & MARINE RESOURCES