

Process ID# 42245  
Vide Plan XG 54

1548

Ward of Naparima  
County of Victoria  
Cadastral Sheet (G. 8 A.)  $\frac{53 E.}{4 / c}$

118

REDEFINITION SURVEY

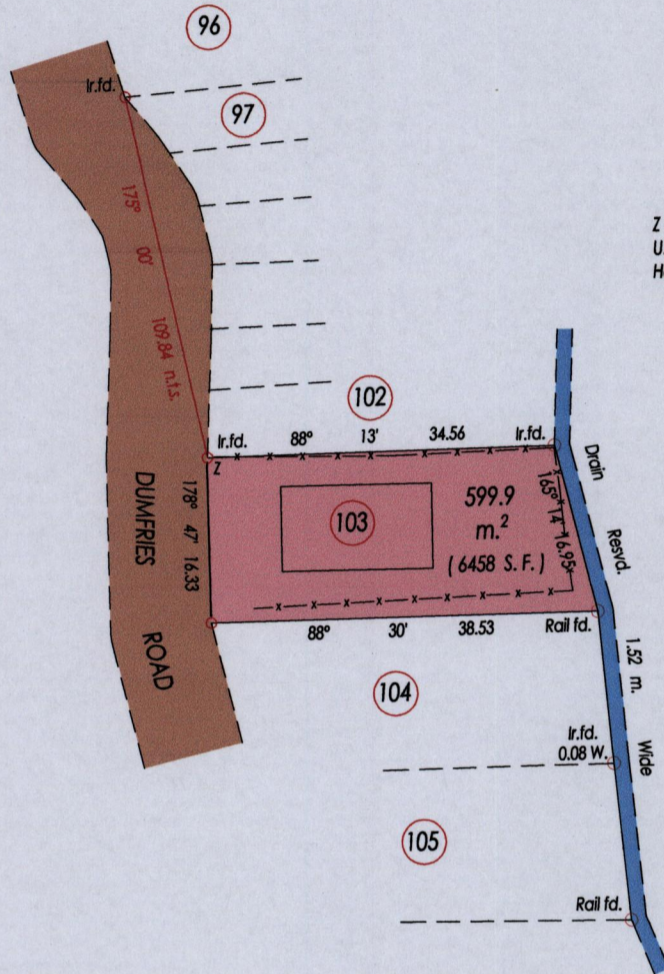

Z = N. 1133503 E. 666952  
U.T.M. Zone 20 Naparima +/- 5.00 m.  
Hand Held G.P.S.

wire fence  
-x-x-x-x-x-

Now or  
formerly  
Palmiste Estate Ltd.  
Field 29



○ Denotes Iron Put Except Stated Otherwise

SCALE 1 : 750

Bearings are Cassini Grid based on Solar Observations Distances are in Metres  
**PLAN** of a Parcel of land coloured pink in the Ward of Naparima  
 Containing five hundred and ninety nine point nine sq. metres  
 Re-defined by me, with due authority in, July 2011 for Kishore Chablal  
 In accordance with Regulation 25 (1) of the Land Surveyors' Regulations 1998,  
 I certify that this plan is correct.

*[Handwritten Signature]*  
25 Apr

Entered on..... Trinidad & Tobago Land Surveyor .....2011

MINISTRY OF AGRICULTURE  
Survey & Mapping Division  
AUG 03 2011  
LANDS & MARINE RESOURCES