

H.C. CLAIM No. C.V. 2011 - 01188

Process ~~SDT 46743~~
AMENDED PLAN

Cadastral Sheet G.9.N. $\frac{64A}{3/b}$

Ward of Naparima
County of Victoria

E 676-436
N 1128 110
Nap. Dist. 2-5

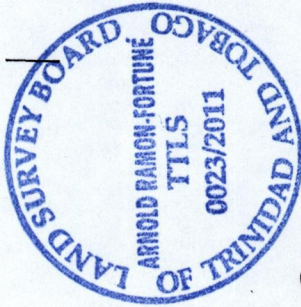
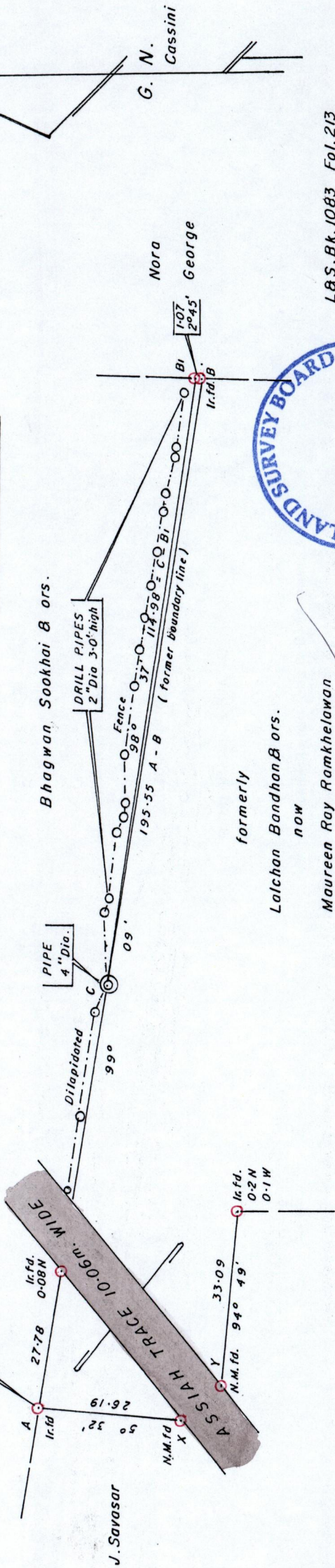

See Fol. 99

L.S. Bk. 1083 Fol. 213
X - Y = 139° 06' 10.06

SCALE : 1 / 1000
Distances are in metres

Bearings are based on Solar Observations

Plan showing a row of Drill Pipes supporting a Dilapidated Fence

In relation to Boundary Lines (i) A - C 99° 09' 80.45 & (ii) C - B 98° 37' 114.98 (new boundary lines)

Surveyed by me, with due authority in August 2011, at the request of the Honorable Mr. V. Kokaram.

In accordance with Regulation 25(i) of the Land Surveyors' Regulations 1998,

I certify that this plan is correct.

Checked by

Entered

Arnold Ramon-Fortune

Trinidad & Tobago, Land Surveyor *14th November 2011*



1548

1100

FOR H.C. ORDER
SEE OVERLEAF

REPUBLIC OF TRINIDAD AND TOBAGO
 DEPARTMENT OF LANDS AND SURVEY
 IN THE HIGH COURT OF JUSTICE
 CLAIM No. CV2011-01188

MAUREEN RAMKHELAWAN

BHAGWAN SOOKHAI
BHADOOR SOOKHAI
KHEMRAJ SOOKHAI
DAVE SOOKHAI
GAYAPERSAD RAMNARINE

Claimant

APPEAL URGENT

Before the Honourable Mr. Justice Vashesth Kokaram
Dated the 14th day of October, 2011

UPON this matter coming up for a Case Management Conference

AND UPON HEARING Attorney-at-Law for the Claimant and in person and Attorney-at-Law for the Defendant and in person.

IT IS HEREBY ORDERED BY CONSENT that:

- The common boundary between the parties respective parcels of land described in their respective deeds do run from point A as shown on the survey plan of Arnold Ramon Fortune dated 29th day of August, 2011 in an Easterly direction at 99° 09' to a pipe on the said line referred to in the plan as a pipe 4 inches in diameter (referred to as 'C') and then to continue to run in an Easterly direction to a point 3.5 feet North of Point B as shown on the said plan (referred to as 'B1').
- The parties to submit to the Court on or before the 24th day of October, 2011 a revised survey plan by Arnold Ramon Fortune showing the common boundary described in paragraph 1 of this Order.



DATE/TIME: 18/28 09:17
 3. PARTIES are at liberty to construct a fence on the common boundary between their respective parcels of land as shown on the said plan (referred to as 'B1'). The Defendant is at liberty to construct a fence on the common boundary consistent with the survey plan 'B1' to 'C'.
 4. There be no order as to costs.

MAUREEN RAMKHELAWAN

High Court Judge
Supreme Court of Trinidad and Tobago

TO: ~~Melvine E. Blake~~
Attorney-at-Law for the Claimant
MESSRS. C.E. BLAIZE & COMPANY
NO. 36 SCOTT BUSHNE STREET,
PORT OF SPAIN.

TO: Pream Persad Maharaj
Attorney-at-Law for the Defendant
9 KEATE ST SAN FERNANDO,
SAN FERNANDO.

