

KELLY VILLAGE - CARONI

Process ID# 42998

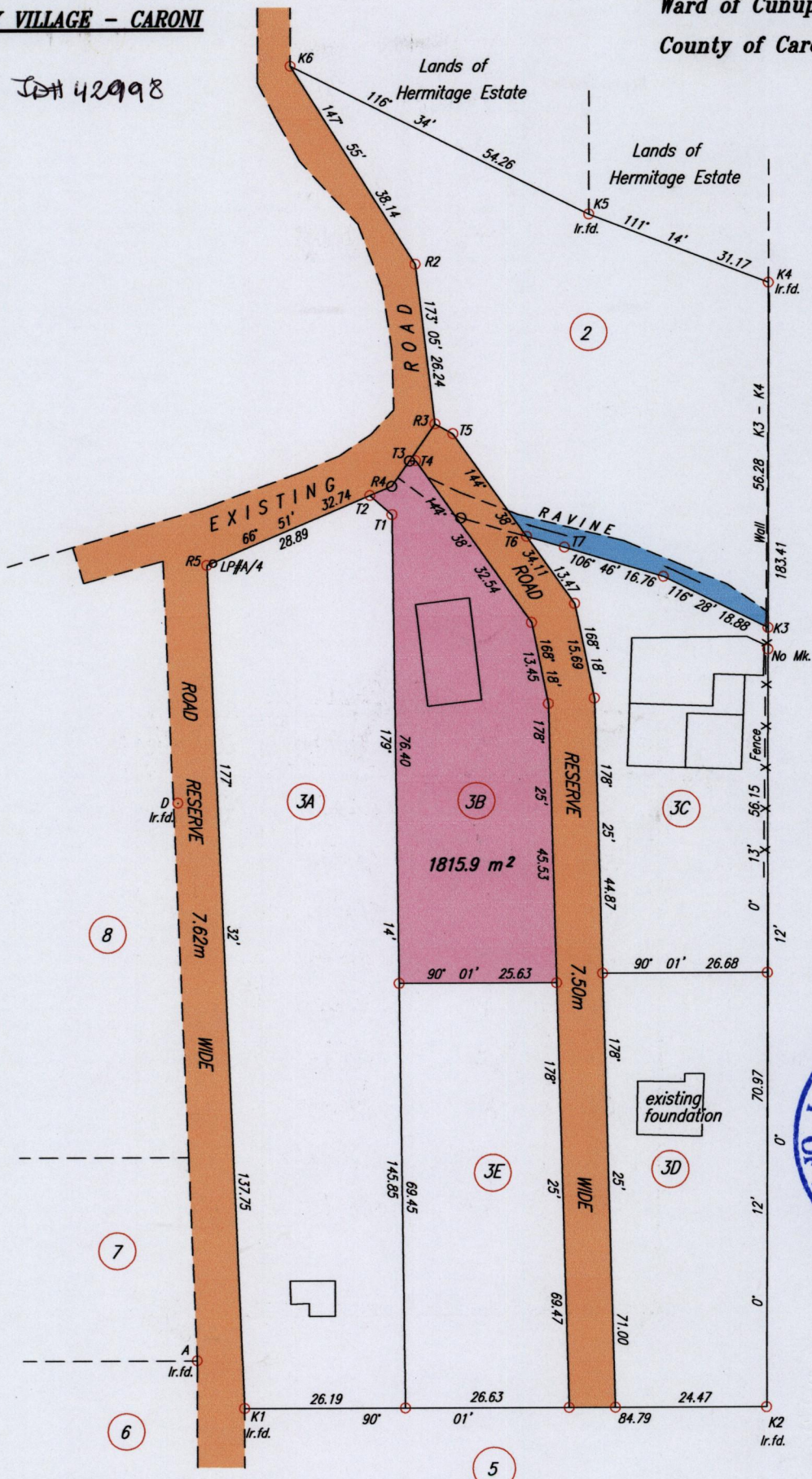

Coordinates of A (lr. fd.): 0679716mE, 1170346mN
 UTM 20 WGS 84 (+/- 5m)
 G.P.S. Direct Observation using handheld GPS

SCALE 1:1000

Distances are in METRES

○ Denotes Iron put except where otherwise stated
 Bearings are Cassini Grid based on Solar Observations

PLAN of a Parcel of land coloured pink in the Ward of Cunupia

Containing one thousand eight hundred and fifteen point nine square metres

Surveyed by me, with due authority, on the 27th March and 30th June 2011 for Sunita Chaitram

In accordance with Regulation 25 (1) of The Land Surveyors Regulations 1998,

I certify that this plan is correct.

Entered:

[Handwritten signature]
 TTLS

MINISTRY OF AGRICULTURE
 Survey & Mapping Division
 #238
 AUG 26 2011
 LANDS & MARINE RESOURCES

LEGEND

<i>From</i>	<i>To</i>	<i>Bearing</i>	<i>Distance</i>
A	K1	135°33'	10.97
R5	LP#A/4	71°45'	1.04
T1	T2	311°10'	4.79
T2	R4	66°51'	3.85
R4	T3	35°05'	5.06
T3	T4	89°13'	0.98
T3	R3	35°05'	7.27
R3	T5	118°44'	3.32
T6	T7	106°17'	6.41

