

1500-31

1500

31

R.P.O. Vol. 108

Fol. 447

Cadastral Sheet G.13.C.  $\frac{63F}{1/b}$

C.T. Vol. 1950

Fol. 311

Ward of Naparima

Vide Bk. 395 fol. 63

County of Victoria

Debe

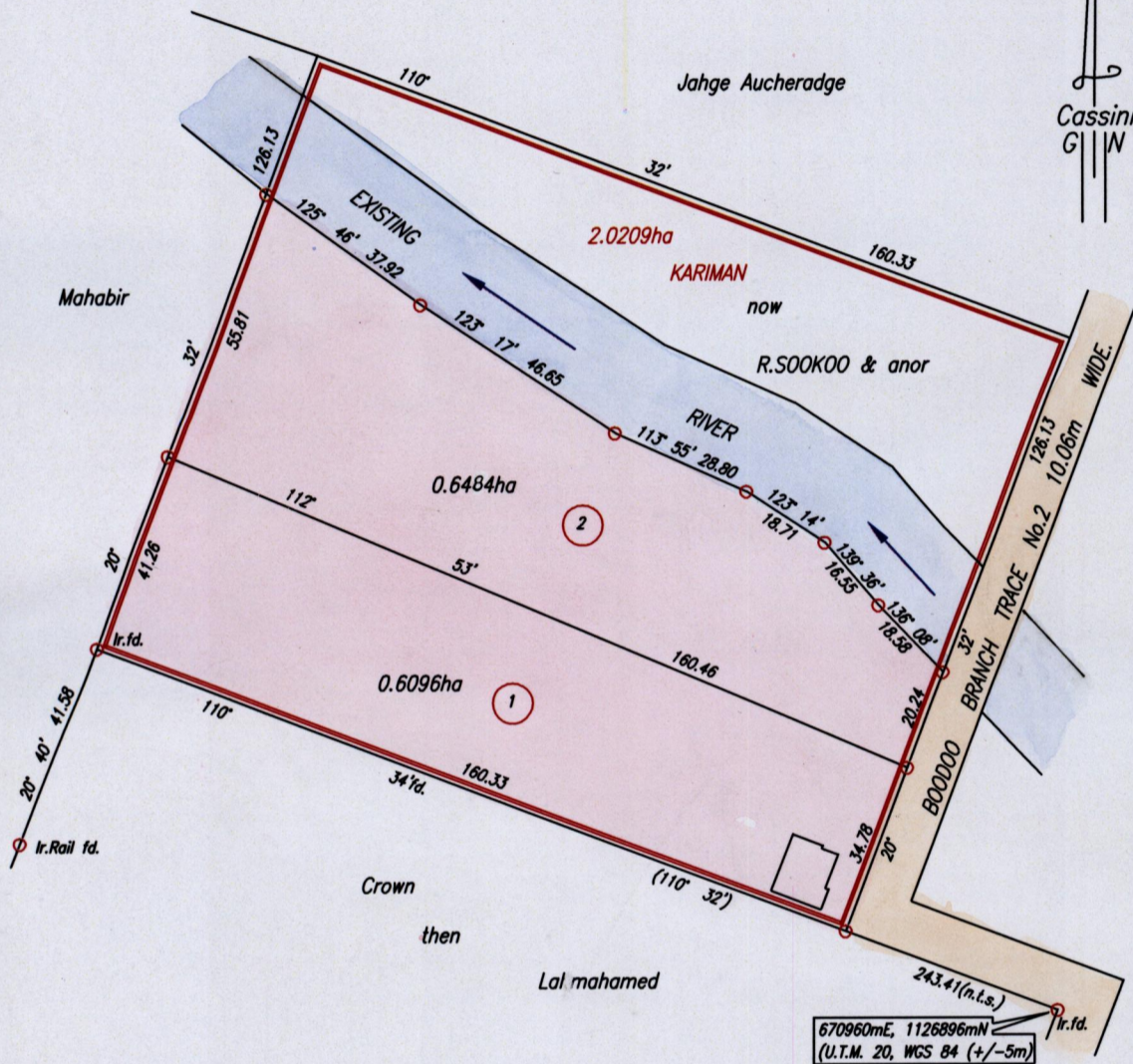

Approved

*Roopchand Deenanani*  
Director of Surveys

2009-4-9

Coordinates obtained from hand held GPS.

○ Denotes Iron put except otherwise stated

Bearings are Cassini Grid based on Solar Observations

PLAN of 2 Parcels of land coloured pink in the Ward of Naparima

Containing together one point two five eight zero hectares

Surveyed by me, with due authority, in July, 2007

In accordance with Regulation 25 (1) of the Land Surveyors' Regulations 1998,

I certify that this plan is correct.

Checked by *M.M. 5/4/09*

*R. Deenanani*

Entered on . . . . .

Trinidad & Tobago Land Surveyor. . . . . 28 November 2008.

PATH = EV700 C:\Drawings08\Sookoo1.dwg.

SCALE 1:1500

Distances are in metres





1500/31