

1500

175

R.P.O. Vol. 49 Fol. 671

C.T. Vol. 1859 Fol. 359

Vide Plan D.C. 80

Vide Plan D.H. 6

Cadastral Sheet G.12.G. & H. 63E
Ward of Siparia
County of St.Patrick.
Penal

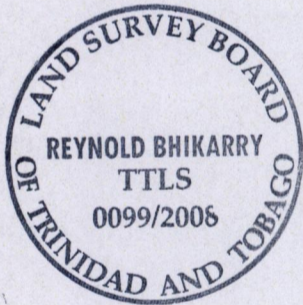
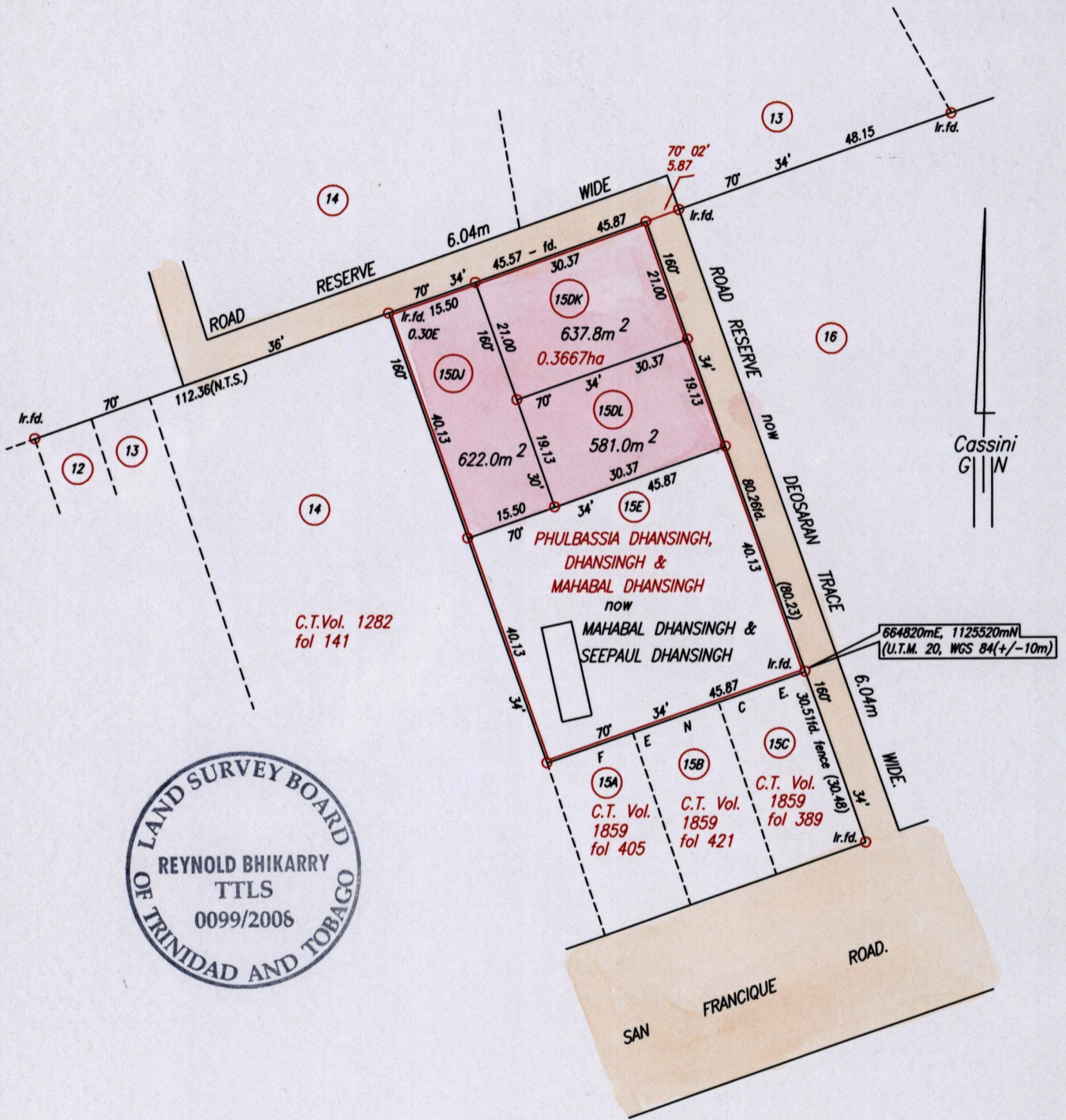

Approved *[Signature]*
Director of Surveys 2009-8-28

Coordinates scaled from Ward Sheet

○ Denotes Iron put except otherwise stated.
Bearings are Cassini Grid based on Solar Observations.

SCALE 1:1000
Distances are in Metres

PLAN of 3 Parcels of land coloured pink in the Ward of Siparia
Containing together one thousand, eight hundred and forty point eight square metres.
Surveyed by me, with due authority, in March, 2007
In accordance with Regulation 25(1) of the Land Surveyors' Regulations 1998,
I certify that this plan is correct.

Checked by *[Signature]* 15/12/08

Entered Trinidad & Tobago Land Surveyor . 15th December . . . 2008

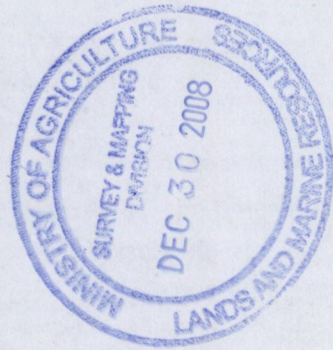

1300/175