

1500/142

1500

142

R.P.O. Vol. 1 Fol. 435

C.T. Vol. 4087 Fol. 139

Ward of Savana Grande

County of Victoria

Cadastral Sheet G.9.P., 64B
3/a

VIDE Bk.1273 fol.83

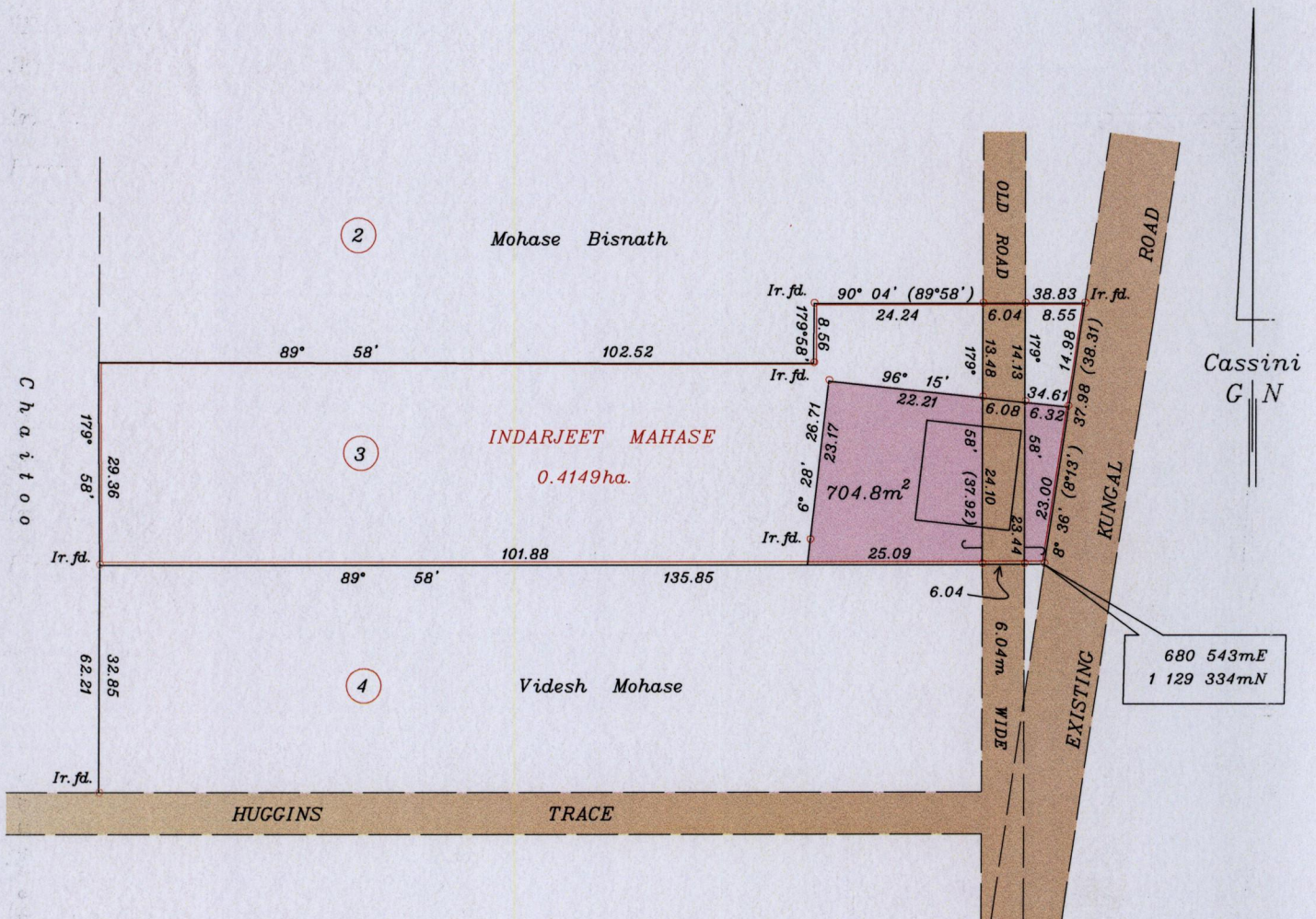

Co-ordinates are U.T.M. Zone 20 Naparima Datum +/-5m
obtained from handheld G.P.S.

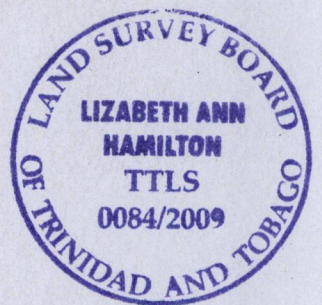

Approved

Director of Surveys

2009.8.17

SCALE 1:1000

o denotes Ir.pt. unless otherwise stated

Bearings are Cassini Grid based on Solar Observations

Distances are in metres

PLAN of a Parcel of land coloured pink in the Ward of Victoria

Containing seven hundred and four point eight square metres

Surveyed by me, with due authority, in September 2005

In accordance with Regulation 25(1) of the Land Surveyors' Regulations 1998

I certify that this plan is correct.

Checked by M.M. 12/8/09

Lizabekth Ann Hamilton

Entered

Trinidad & Tobago Land Surveyor March 13 2009

