

Remaining Portion

R.P.O. Vol. 14 Fol. 449  
C.T. Vol. 1254 Fol. 321

15000 Cadastral Sheet G.13.B. 63C & 63F 119  
Ward of Naparima 3/c 1/b  
County of Victoria.  
Debe Village

Vide Bk. 1414 fol. 193  
Vide Bk. 1289 fol. 228  
Vide Bk. 903 fol. 152  
Plan AE 63

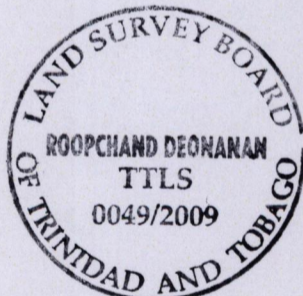
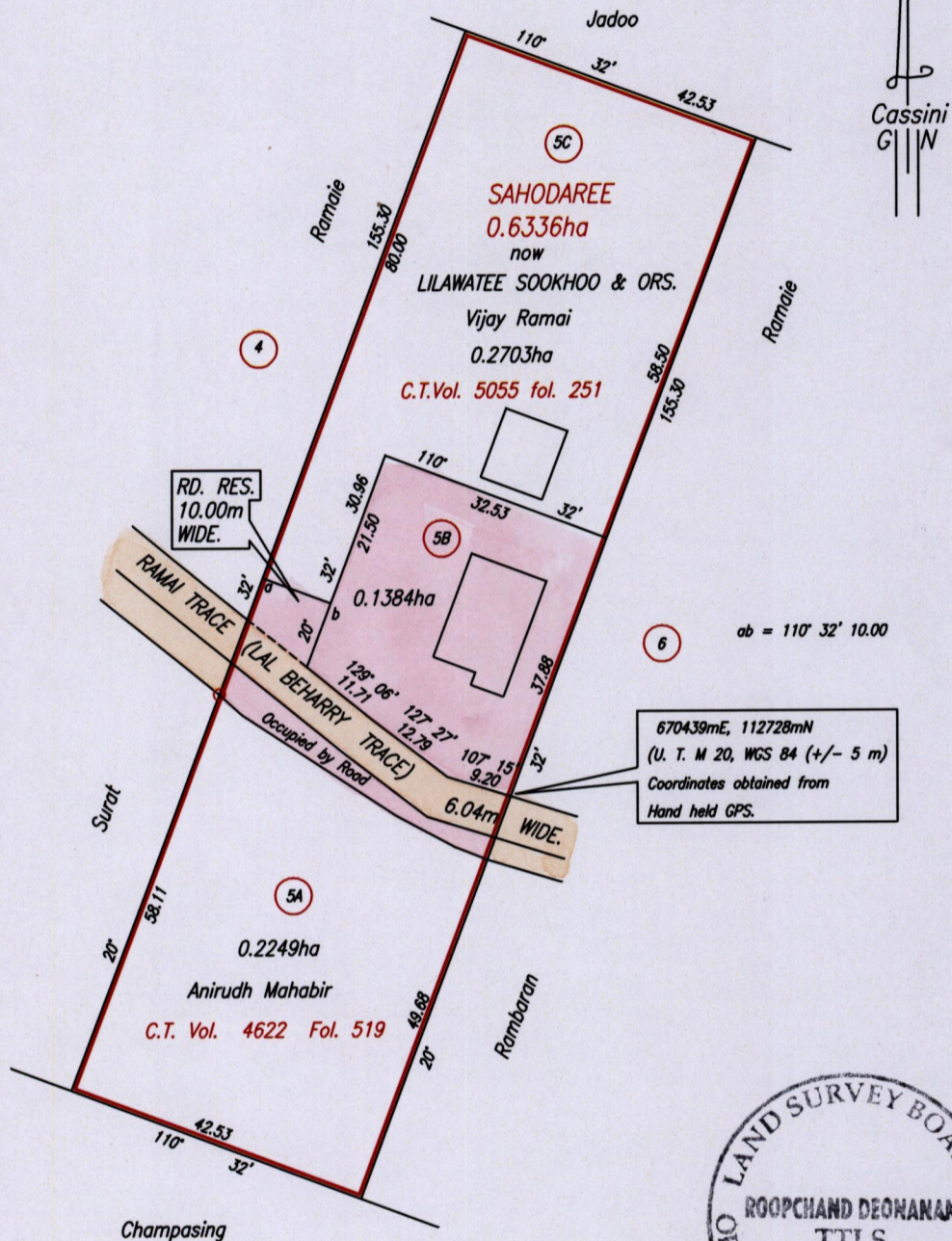

Approved *[Signature]*  
Director of Surveys  
2009.7.23

SCALE 1:1000  
Distances are in Metres

Bearings are Cassini Grid based on Solar Observations.  
This is a true copy of a diagram of a parcel of land in the Ward of Naparima  
Containing zero point six three three six hectare originally transferred to SAHODAREE  
Showing a portion coloured pink and containing zero point one three eight four hectare being the  
Remainder after two previous transfers of other portions of the land  
In accordance with Regulation 25(1) of the Land Surveyors' Regulations 1998,  
I certify that this plan is correct.

Checked by: *[Signature]* 2009/07/20

Entered on . . . . . Trinidad & Tobago Land Surveyor . . . . . 3<sup>rd</sup> July . . . . . 2009  
PATH = EV700 C:\Drawings08\NSookoo2.dwg.

