

1500

10

R.P.O. Vol. 308 fol. 633
 C.T. Vol. 4554 fol. 495
 Vide Bk. 1271 fol. 293
 Vide Bk. 1010 fol. 135
 Vide Bk. 980 fol. 23
 Vide Bk. 427 fol. 178
 Vide Plan J.L. 21

Cadastral Sheet G.13.G. $\frac{63F}{1/b,1/d}$
 Ward of Naparima
 County of Victoria
Debe

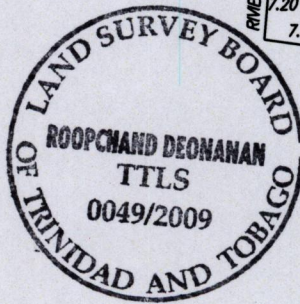
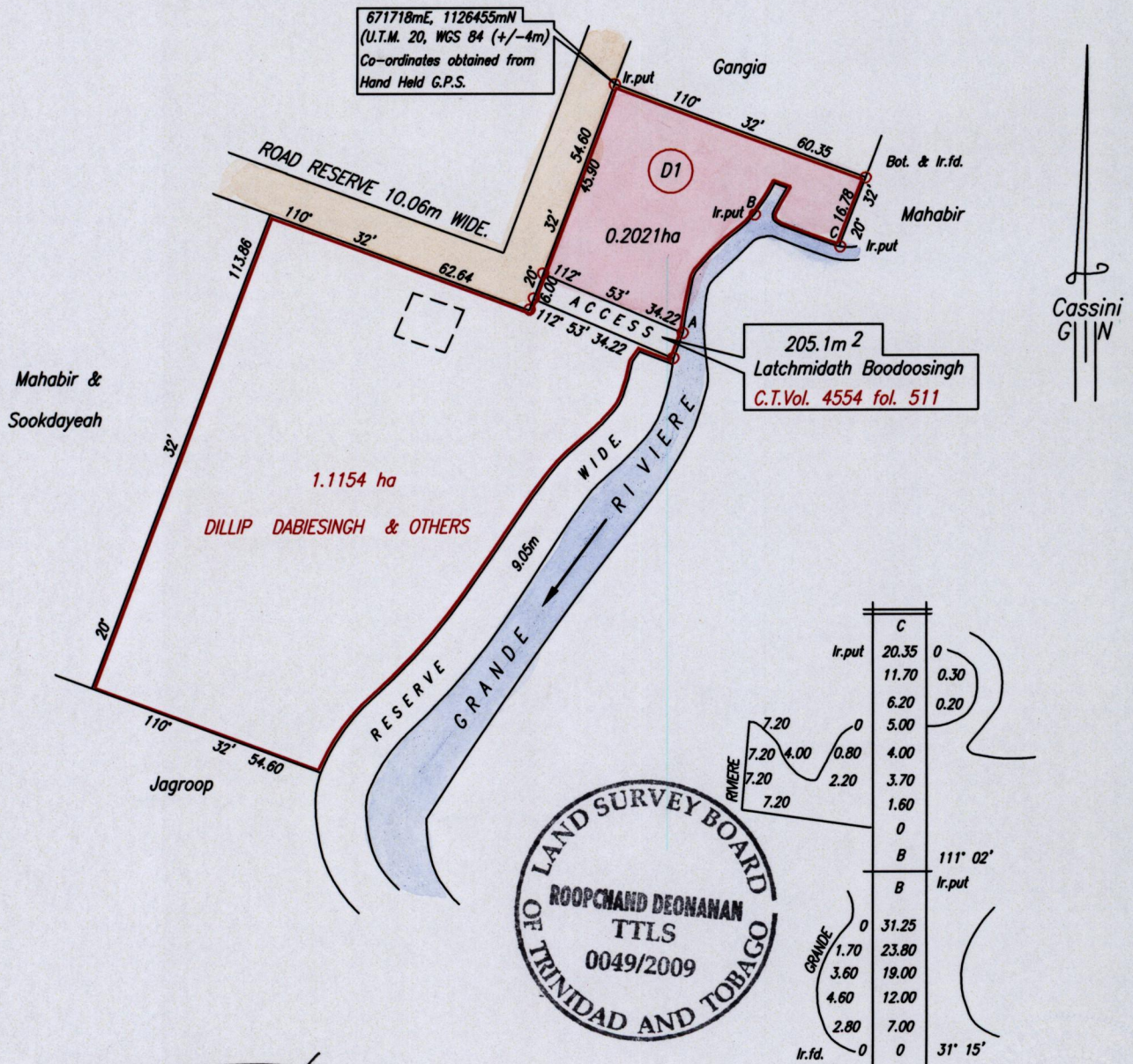

Approved *[Signature]*
 Director of Surveys
 2009.3.26

○ Denotes Iron found except otherwise stated.
 Bearings are Cassini Grid based on Solar Observations
 Plan of a Parcel of land coloured pink in the Ward of Naparima
 Containing zero point two zero two one hectare
 Surveyed by me, with due authority, in September, 2008
 In accordance with Regulation 25(1) of the Land Surveyors' Regulations 1998,
 I certify that this plan is correct.

SCALE 1:1500
 Distances are in Metres

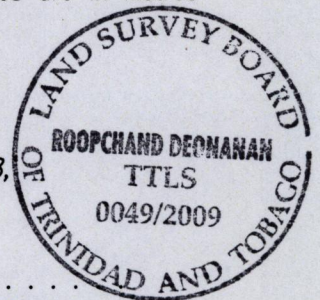

Checked by *[Signature]* 23/2/09

Entered

Trinidad & Tobago Land Surveyor *[Signature]* 23rd January 2009
 PATH = E:\700 D:\Drawings\08\Dabesingh.dwg.

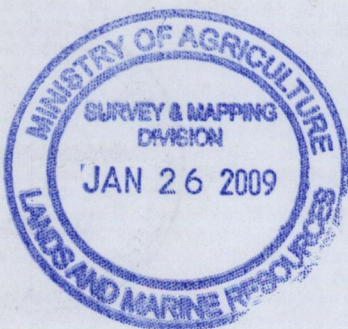

1500/10