

R.P.O. Vol. 183 Fol. 295
 C.T. Vol. 1210 Fol. 245
 C.T. VOL 5227 FOL 325 -
 U.P.I.N.:

REMAINING PORTION

Ward of Siparia
 County of St. Patrick
 Cadastral Sheet G.11.G. & K. 62F
 4/b

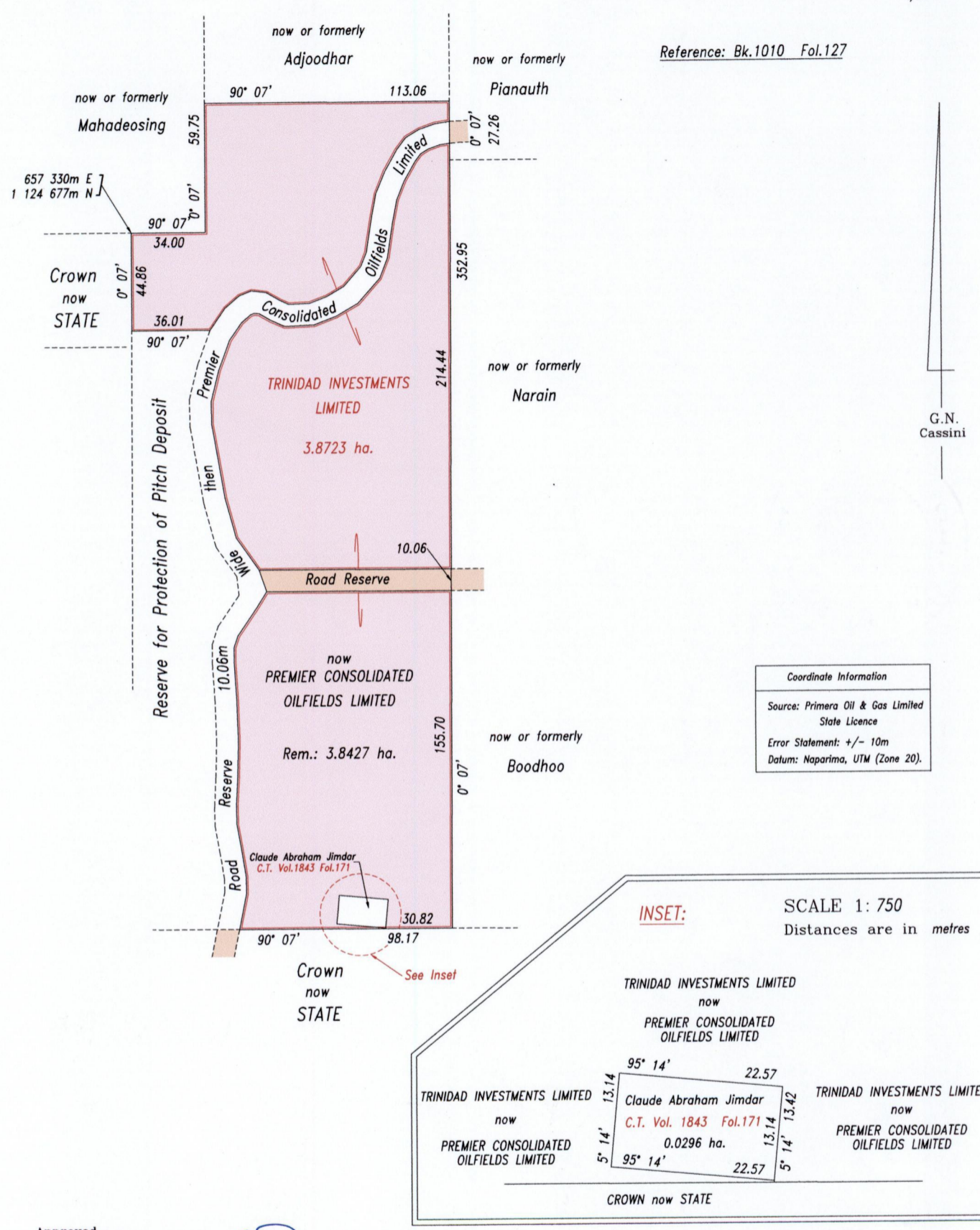

Reference: Bk.1010 Fol.127

Coordinate Information
Source: Primera Oil & Gas Limited State Licence
Error Statement: +/- 10m
Datum: Naparima, UTM (Zone 20).

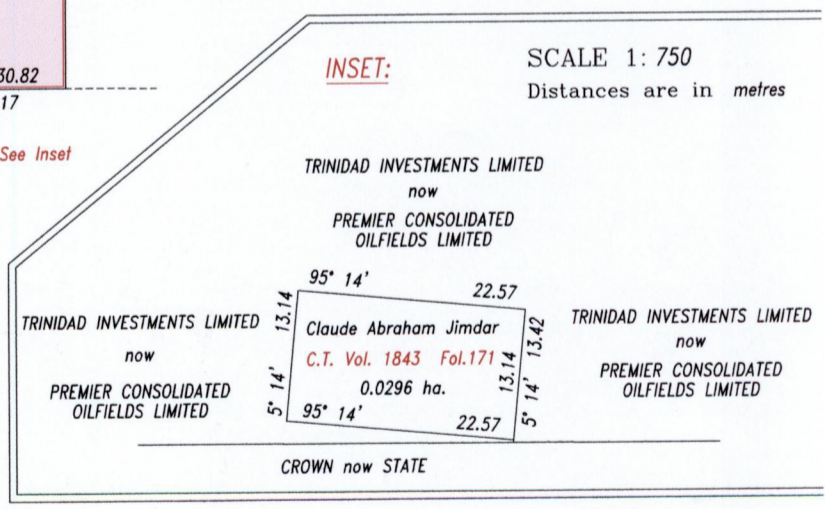

Approved
[Signature]
 Director of Surveys 2010.3.23

SCALE 1: 2500
 Distances are in metres

This is a true copy of a diagram of three point eight seven two three hectares originally transferred to TRINIDAD INVESTMENTS LIMITED, showing a portion coloured pink and containing three point eight four two seven hectares being the remainder after one (1) previous transfer of another portion of the land. In accordance with Regulation 25(1) of the Land Surveyors' Regulations 1998, I certify that this plan is correct.

Checked by *[Signature]* 8/3/10
 Entered
[Signature]
 Trinidad & Tobago Land Surveyor 2/12/2009

