

1439

1383/181

66

REMAINING PORTION

R.P.O. Vol. 125 Fol. 667

C.T. Vol. 3584 Fol. 219

U.P.I.N. No.:
C.T. VOL 5276 Fol. 493.

Ward of Siparia

County of St. Patrick

Cadastral Sheet G.17.B. 73A
2/a

Coordinate Information
Source: GPS (Hand Held)
Error Statement: +/- 5m
Datum: Naparima, UTM (Zone 20)

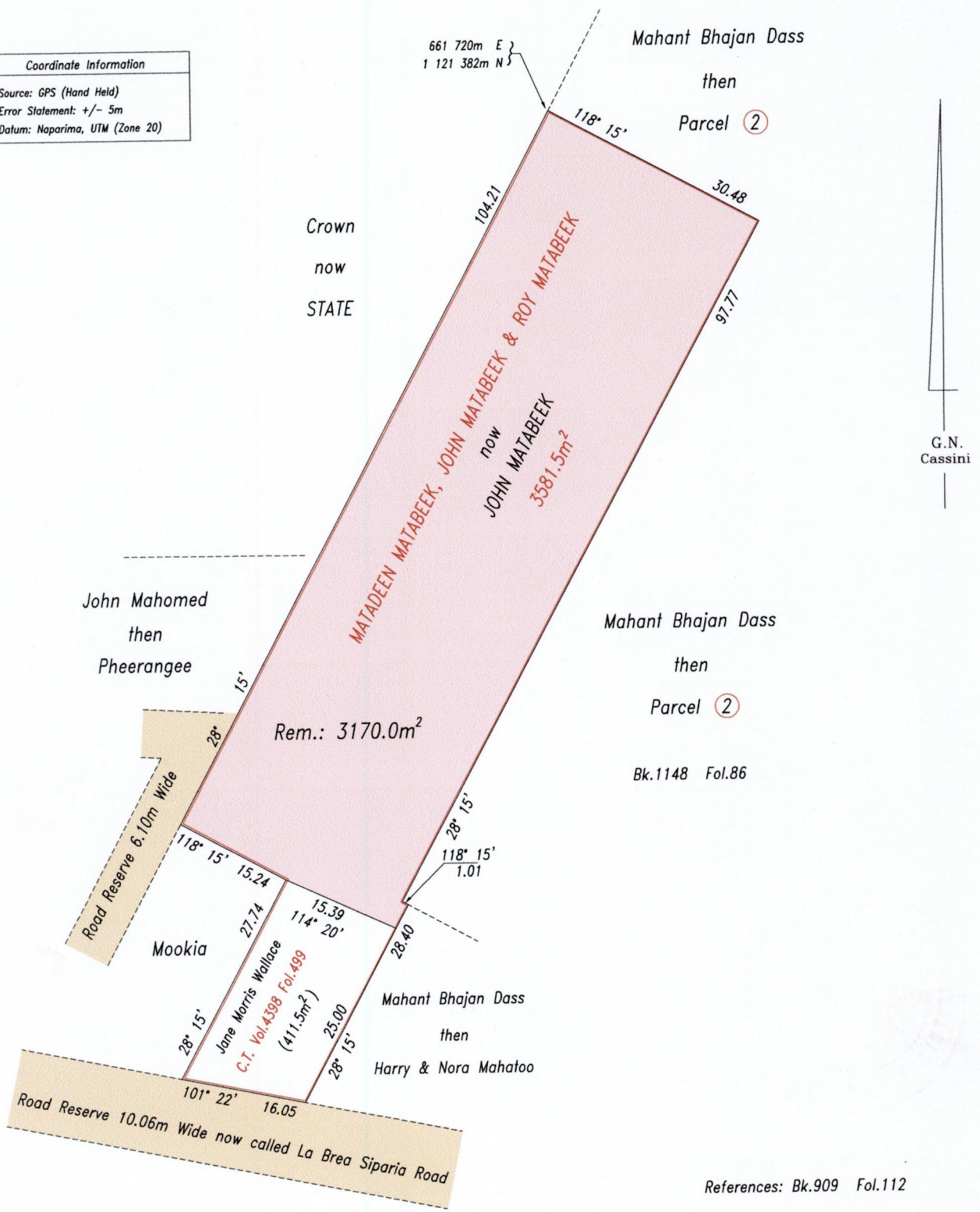

G.N. Cassini

Mahant Bhajan Dass
then
Parcel 2
Bk.1148 Fol.86

References: Bk.909 Fol.112

Approved
[Signature]
Director of Surveys 20/04/10

SCALE 1: 750

Distances are in metres

This is a true copy of a diagram of three thousand five hundred and eighty one point five square metres originally transferred to MATADEEN MATABEEK, JOHN MATABEEK & ROY MATABEEK, showing a portion coloured pink and containing three thousand one hundred and seventy point zero square metres being the remainder after one (1) previous transfer of another portion of the land. In accordance with Regulation 25(1) of the Land Surveyors' Regulations 1998, I certify that this plan is correct.

Checked by *[Signature]* 6/4/10
Entered
Trinidad & Tobago Land Surveyor *[Signature]* 26/3/2010

