

1439

65

CONSOLIDATION PLAN

Cadastral Sheet G.13.B, 63F
County of Victoria 1/a
Ward of Naparima
Debe

Refs. : Bk 1010 Fol 192 & 6
Plan E.K. 8
Plans J.L.102 & J.L.103
CT VOL 5267 Fol 277.

Cassini
G.N.

Lot#	Area	CT Vol & Fol	Owner
7A	289.3m ²	5145:187	Edward Moodie & Devica Roopnarine
7B	222.5m ²	5145:139	Edward Moodie & Devica Roopnarine

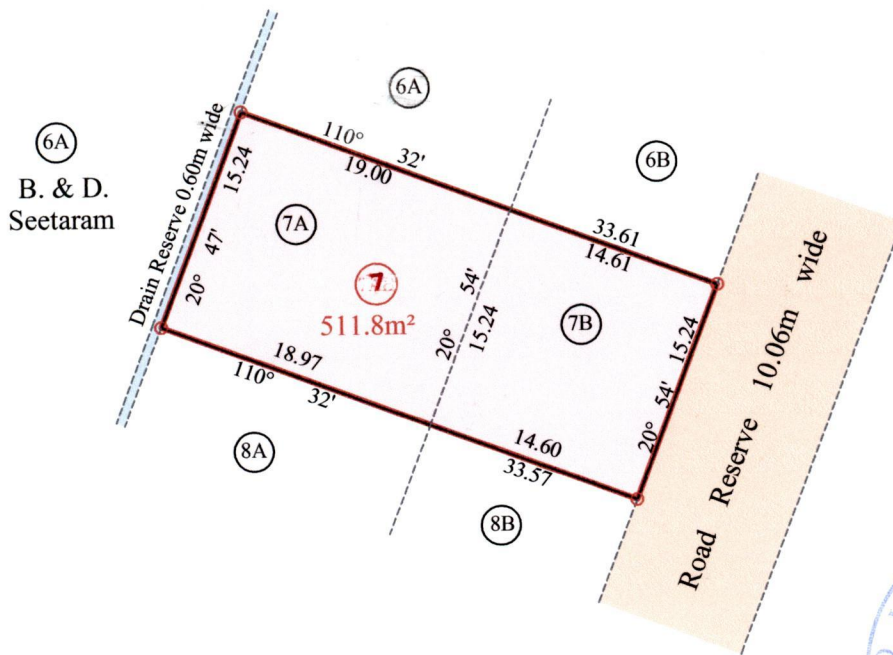

Approved

[Signature]
Director of Surveys 2009.12.14

o denotes Iron put except otherwise stated
Bearings are Cassini Grid based on Solar Obs.
Distances are in METRES
SCALE 1/500

PLAN of a parcel of land coloured pink in the Ward of Naparima
Comprising five one one point eight square metres.

Prepared by me, with due authority, from surveys done by Ron Gajadhar in September 2006.
In accordance with Regulation 25 (1) of the Land Surveyors' Regulations 1998,
I certify that this plan is correct.

Entered on.....
Checked by *[Signature]* 20/5/09

[Signature]
Trinidad and Tobago Land Surveyor..... 13/5 2009

LOT #	CT. VOL & FOLIO	NAMES
7A	CT. VOL 5267 fol 277	Edward Moodie & Devica Roopnarine
7B	CT. VOL 5267 fol 277	Edward Moodie & Devica Roopnarine.



new 1439/65
1333/43