

CONSOLIDATION PLAN

Cadastral Sheet G.13.B, 63F
County of Victoria 1/a
Ward of Naparima
Debe

Refs. : Bk 1010 Fol 192 & 6
Plan E.K. 8
Plans J.L.102 & J.L.103

C.TVOL 5267 fol 281

Cassini
G.N.

| Lot# | Area | CT Vol & Fol | Owner |
|------|---------------------|--------------|-----------------------------------|
| 11A | 375.9m ² | 5145:203 | Edward Moodie & Devica Roopnarine |
| 11B | 253.5m ² | 5145:147 | Edward Moodie & Devica Roopnarine |

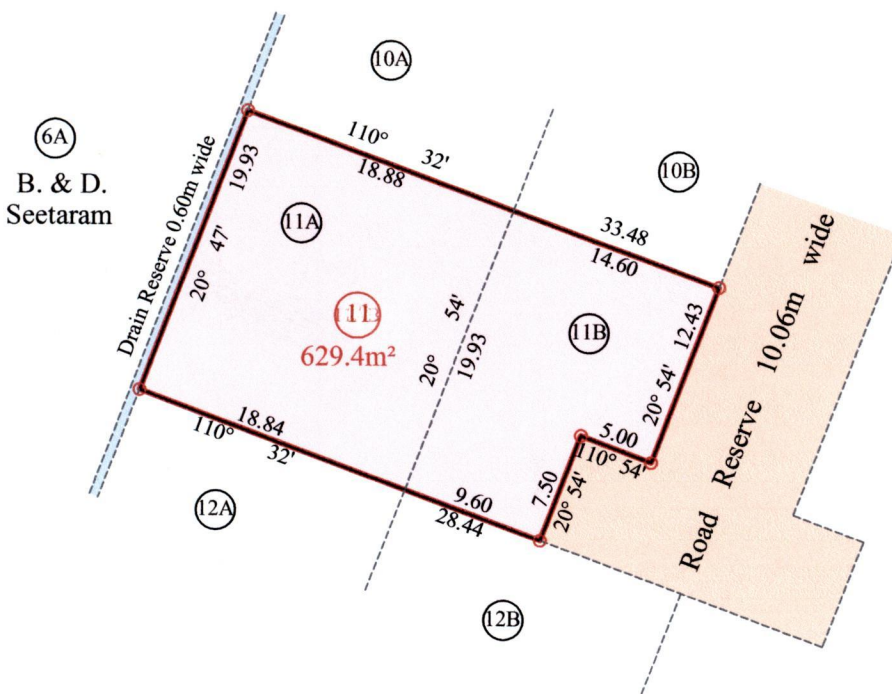

Approved

[Signature]
Director of Surveys 2009.12.14

o denotes Iron put except otherwise stated
Bearings are Cassini Grid based on Solar Obs.
Distances are in METRES
SCALE 1/500

PLAN of a parcel of land coloured pink in the Ward of Naparima
Comprising six two nine point four square metres.

Prepared by me, with due authority, from surveys done by Ron Gajadhar in September 2006.
In accordance with Regulation 25 (1) of the Land Surveyors' Regulations 1998,
I certify that this plan is correct.

Entered on.....
Checked by *[Signature]* 22/5/109

[Signature]
Trinidad and Tobago Land Surveyor..... 13/52009

| LOT# | CT-VOL'S, FOL | NAMES. |
|------|---------------|------------------------------------|
| 11A | 5267 fol 283 | Edward Moodie s, Devica Roopnarine |
| 11B | 5267 fol 283 | Edward Moodie s, Devica Roopnarine |
| | | |
| | | |
| | | |
| | | |



1001439/54
 1333/47