

Vol. 5278 Fol. 287
R.P.O. Vol. 372 Fol. 507
C.T. Vol. 630 Fol. 487

Cadastral Sheet G.12.P. 63E
4/c
Ward of Siparia.
County of St.Patrick.
Syne Village.

Vide Bk. 991 fol. 107

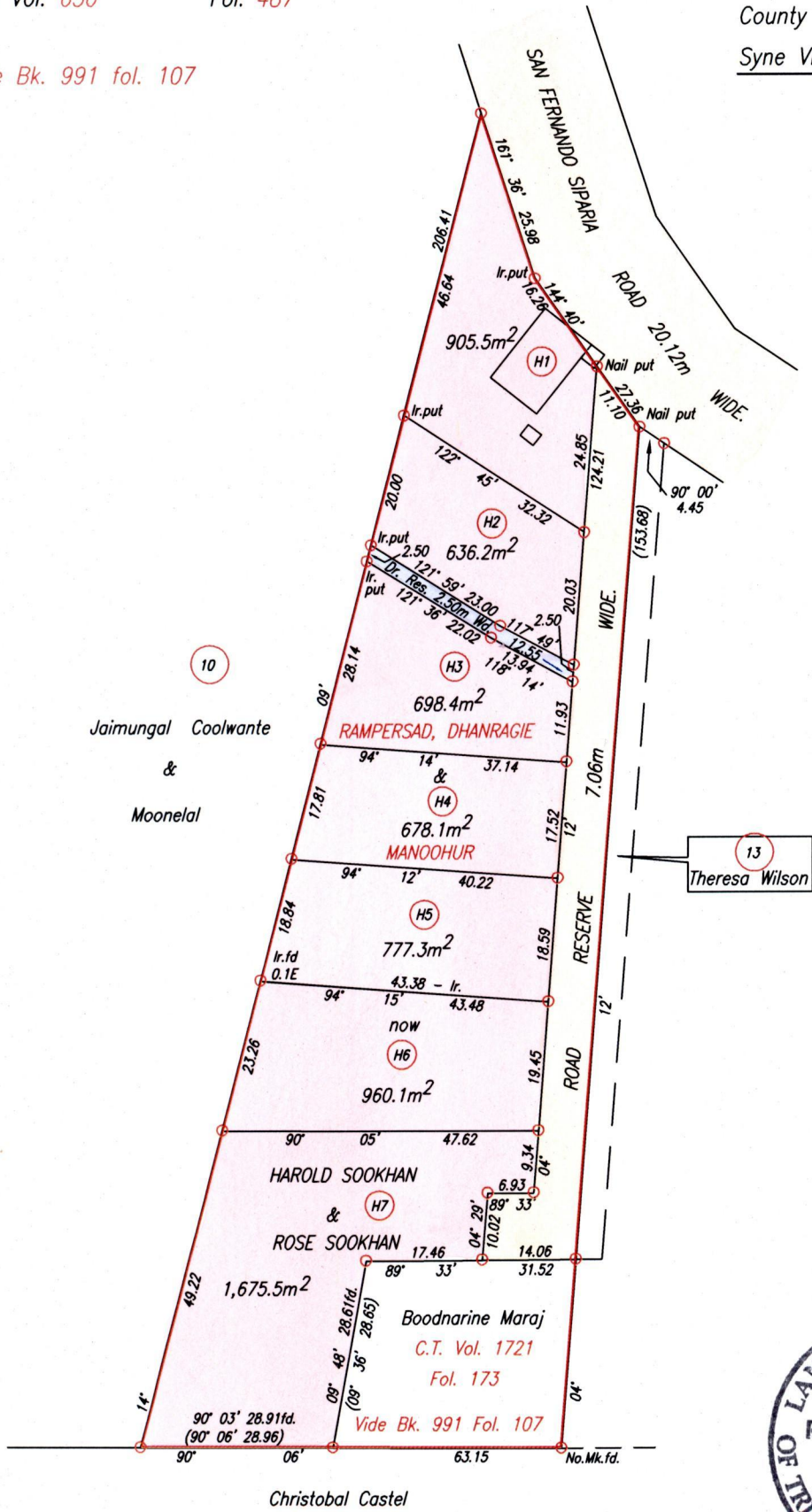

Approved *[Signature]*
Director of Surveys 2010-8-30

SCALE 1:1000
Distances are in metres

○ Denotes Iron found except otherwise stated
Bearings are Cassini Grid based on Solar Observations
PLAN of 7 Parcels of land coloured pink in the Ward of Siparia
Containing together six thousand, three hundred and thirty one point one square metres.
Surveyed by me, with due authority, in May, 2010
In accordance with Regulation 25 (1) of the Land Surveyors' Regulations 1998,
I certify that this plan is correct.

Checked by *[Signature]*

[Signature]

Entered on Trinidad & Tobago Land Surveyor. . . 20th June . . 2010.

| LOT No. | CT. VOLUME & FOLIO | NAMES |
|---------|--------------------|---|
| H1 | 5278 fol. 293 | INDRA & ALESTER LEON BEHARRY |
| H2 | 5278 fol. 301 | INDRA & SHANE BEHARRY |
| H3 | 5278 fol. 309 | INDRA & SHANE BEHARRY |
| H4 | 5539 fol. 391 | INDRA & SHANE BEHARRY |
| H5 | 5539 fol. 399 | CANDICE ALYANA LOWKIE & SANDRA LOWKIE |
| H6 | | |
| H7 | 5539 fol. 415 | HAROLD SOOKHAN, SHARRAN & DARIAN BALLOSINGH |