

At Station (A)  
 E 0665759  
 N 1125695  
 Reading taken with  
 Handheld G.P.S.  
 Garmin 76S  
 U.T.M. Zone 20  
 Naparima  
 ± 10 m

Ward of Siparia  
 County of St. Patrick  
 Cadastral Sheet ( G.12.H ) 63.E.  
 1/d

Vol. 5427 Fol. 281  
 R.P.O. Vol. 121 Fol. 585  
 C.T. Vol. 4374 Fol. 415

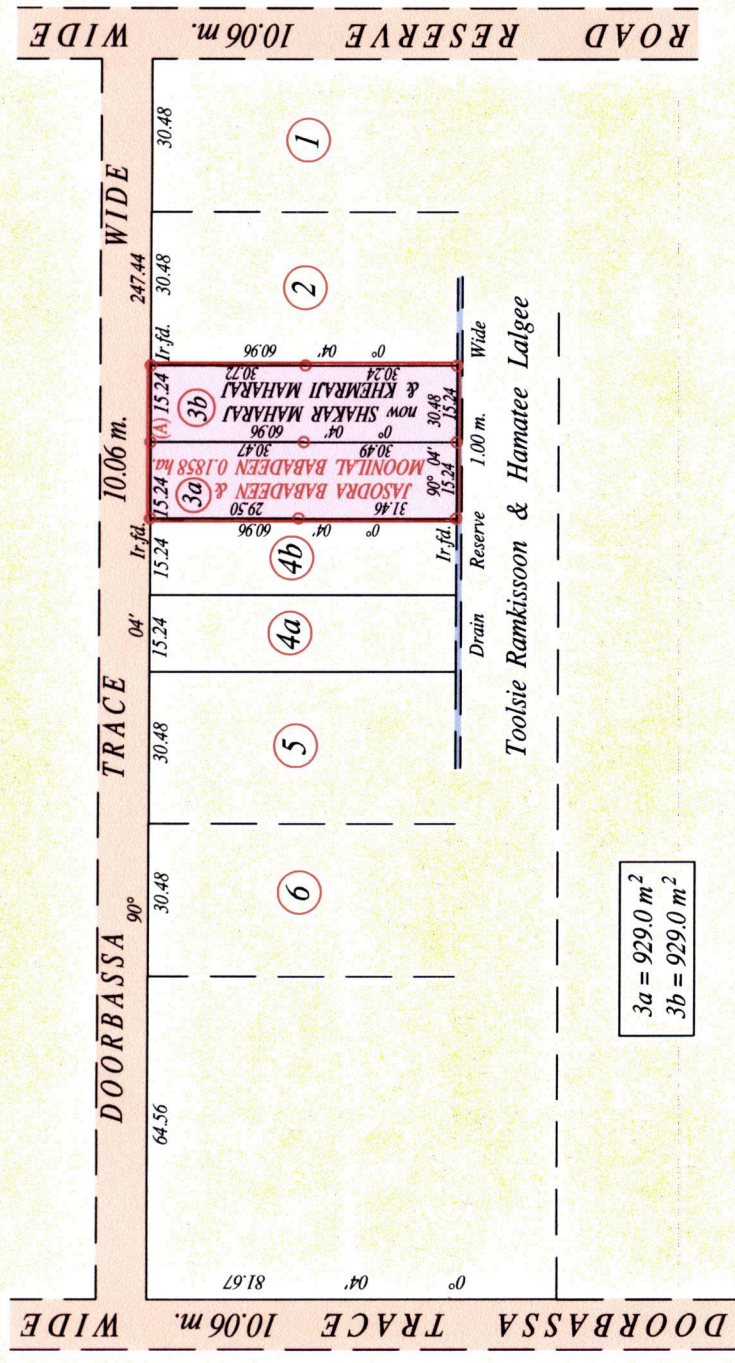

3a = 929.0 m<sup>2</sup>  
 3b = 929.0 m<sup>2</sup>

Approved *[Signature]*  
 Director of Surveys 2010. 3. 23

○ Denotes Iron put except stated otherwise.

Note: Bearings are cassini grid based on solar observations Distances are in metres  
 PLAN of 2 Parcels of land coloured pink in the Ward of Siparia  
 Containing together one thousand eight hundred and fifty eight point zero square metres  
 Surveyed by me, with due authority, in December 2008  
 In accordance with Regulation 25 (1) of the Land Surveyors' Regulations 1998,  
 I certify that this plan is correct.

Vide Bk. 1145 fol. 131  
 Vide Bk. 1163 fol. 183

Checked by *[Signature]*  
 15/3/10

Entered on ..... Trinidad & Tobago Land Surveyor ..... 10-03.....2010

SCALE : 1:1500



1333/1118  
Nov 14 39/218

Lot 3B - CT. VOL. 5427 FOL. 289 INDR MAHARAI & ADIMARIA VIOLANTE  
PREIRA MAHARAI

Lot 3A - CT. VOL. 5427 FOL. 295 SHAKAR & KHEMRAI MAHARAI