

1439

1839

Vol. 5346 Fol. 333

R.P.O. Vol. 144 Fol. 607

C.T. Vol. 1497 Fol. 421

Cadastral Sheet G.16.H. 73A
1/c

Ward of Siparia

County of St. Patrick.

SANTA FLORA

Vide Bk.936 Fol.286

Bk.948 Fol.249

Bk.976 Fol.10

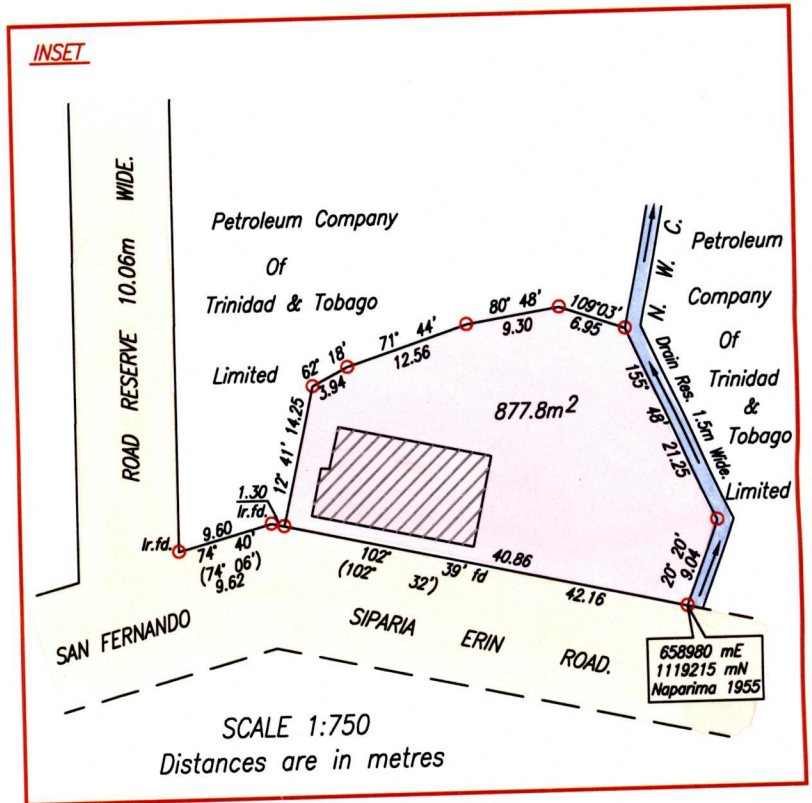
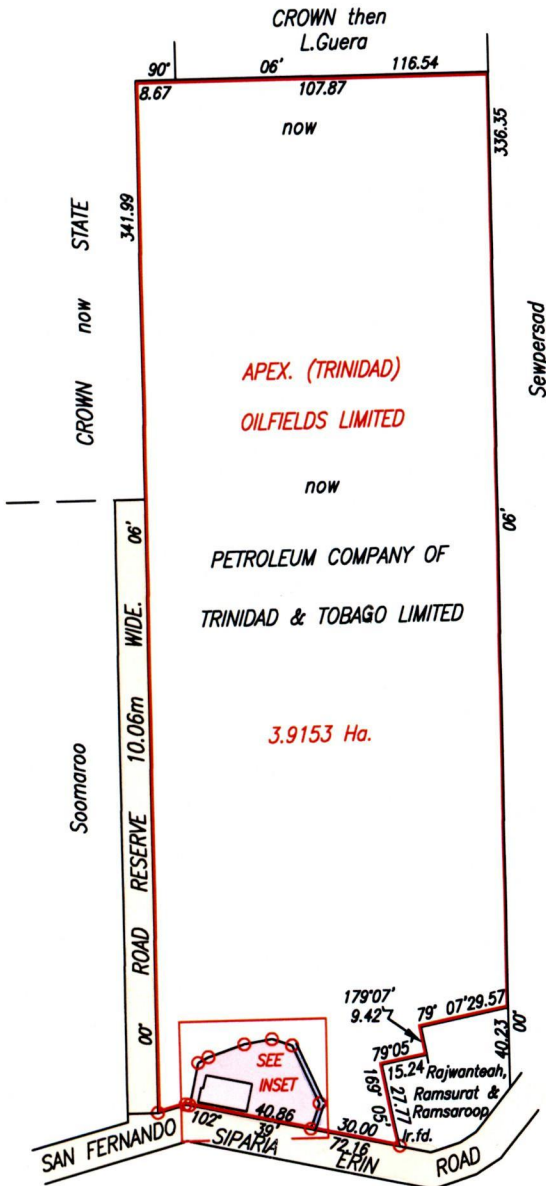

Coordinates obtained from Topo Data

Approved *[Signature]*
Director of Surveys 2010.7.1

SCALE 1:2500
Distances are in metres

○ Denotes Iron put except otherwise stated
Bearings are Cassini Grid based on Solar Observations
PLAN of a Parcel of land coloured pink in the Ward of Siparia
Containing eight hundred and seventy seven point eight square metres
Surveyed by me, with due authority, in September, 2007
In accordance with Regulation 25 (1) of the Land Surveyors' Regulations 1998,
I certify that this plan is correct.

Checked by *[Signature]* 2/16/10

[Signature]

Entered on

Trinidad & Tobago Land Surveyor. 19th May 2010.
PATH = ADA004 D:/DEO/MANSON DWG



CT. VOL. 5346 FOL. 335 MATTHEW & RADICA MASON.



REC'D 1439/189
1336/51