

R.P.O. Vol. 882 Fol. 553

C.T. Vol. 3339 Fol. 361

VOL. 5335 FOL. 401

1439

Ward of Cocal

County of Nariva

Cadastral Sheet (E 12 M) 45 C

1/d

Lot # 45 Biche Village Settlement

G.N

U.T.M.

Hand held GPS, +/-10m.

A - 1153250 mN.

703900 mE.

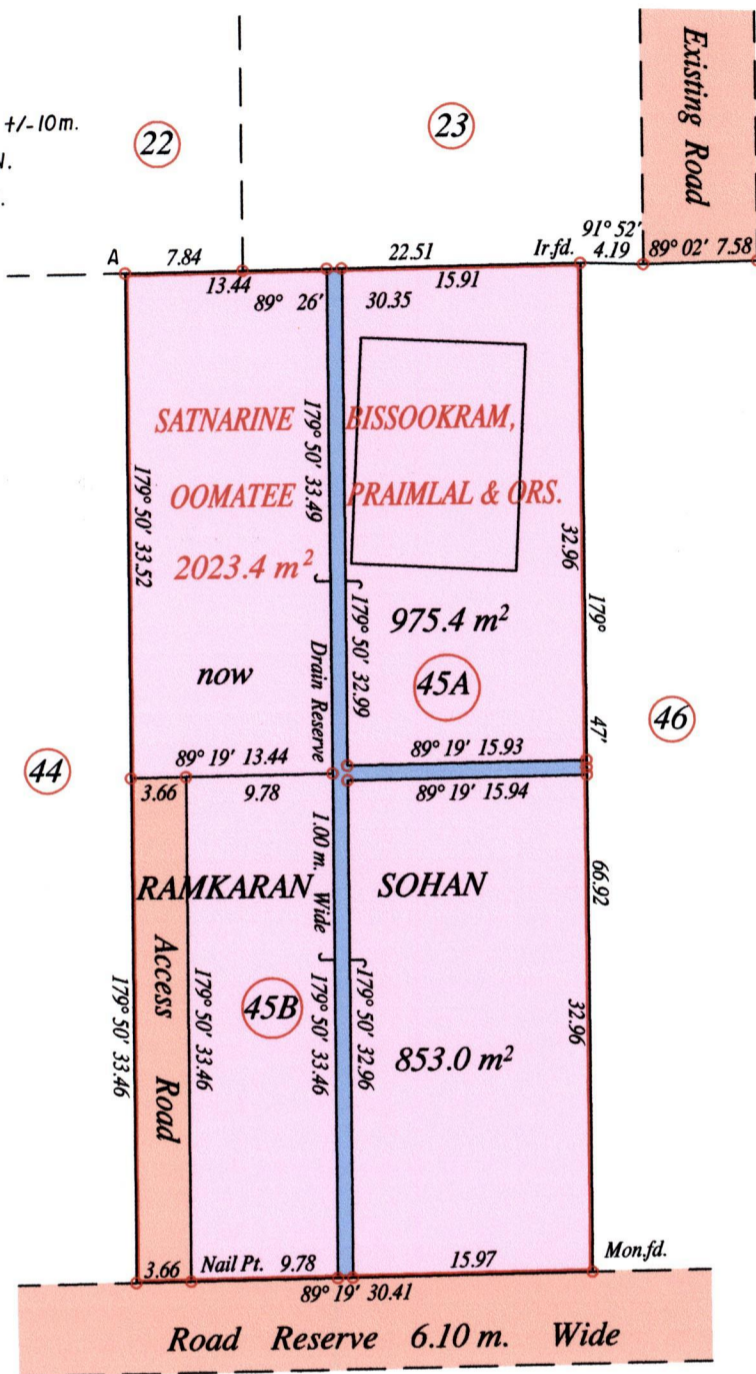

Approved *[Signature]*
Director of Surveys 2010.7.29

Vide Plan K D 1

o Denotes Iron put except stated otherwise.

SCALE : 1:500

Note: Bearings are U.T.M. grid based on solar observations

Distances are in metres

PLAN of 2 Parcels of land coloured pink in the Ward of Cocal

Containing together one thousand eight hundred and twenty eight point four square metres
Surveyed by me, with due authority, in March 2009

In accordance with Regulation 25 (1) of the Land Surveyors' Regulations 1998,
I certify that this plan is correct.

Checked by *[Signature]* 2010-07-27

Entered on Trinidad & Tobago Land Surveyor ... 9th July ... 2010

LOT 45 A CT. VOL. 5400 FOL. 187 ZAINOOL KHAN

LOT 45 B - CT. VOL. 5335 FOL. 409 ESTHER & LATCHMAN GOOLCHARAN



10000 1439/182
1336/83