

1439

179

R.P.O Vol. 192 Fol. 189  
C.T. Vol. 5086 Fol. 413  
C.T. Vol 5331 Fol 393.

Ward of Naparima.  
County of Victoria.  
Cadastral Sheet G.13.C. 63F

2/a



X  
1126574mN, 671893mE  
UTM 20, WGS 84 (+/- 5.0m)  
GPS Handheld Direct Obs.

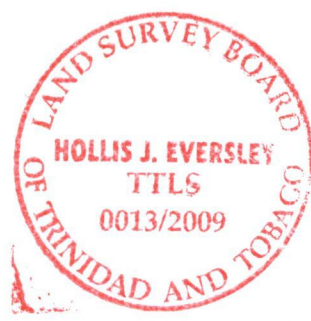
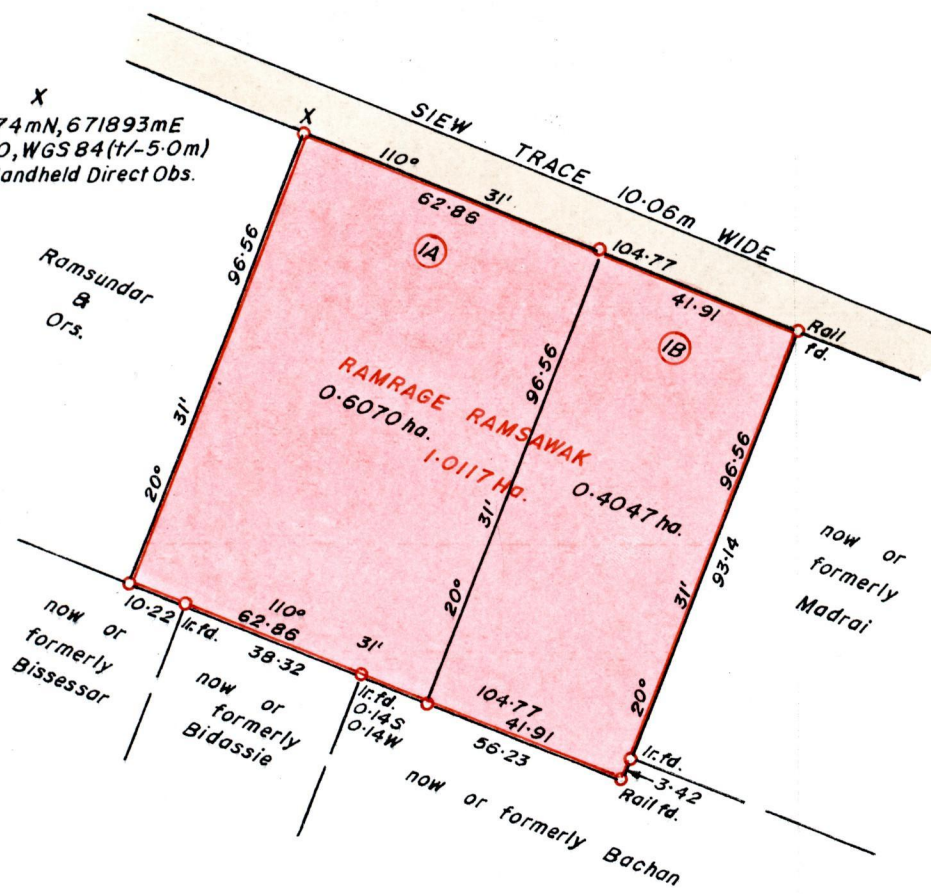

Bk. 886 : 271.

SCALE 1:1500.

Distances are in METRES

o Denotes Iron Put except otherwise stated  
Bearings are Cassini Grid based on Solar Observations.

Approved... *[Signature]*  
Director of Surveys. 2010.3.16

**PLAN of 2 Parcels of land coloured in PINK in the Ward of Naparima.  
Containing together one point zero one one seven hectares.  
Surveyed by me, with due authority, in July 2009.  
In accordance with Reg. 25(1) of the Land Surveyors' Regulations 1998,  
I certify that this plan is correct.**

Checked by... *[Signature]* 27/2/10

*[Signature]*  
Trinidad and Tobago Land Surveyor

Entered ..... Trinidad and Tobago Land Surveyor ..... 2009.

Lot #	C.T. Vol & Folio	Names.
1A	5331 fol 403	Sockraj & Myra Meenoo
1B	5331 fol 405	Sockraj & Myra Meenoo.



1439/179  
+333/109