

Vol. 5421 Fol. 423

1439

1699

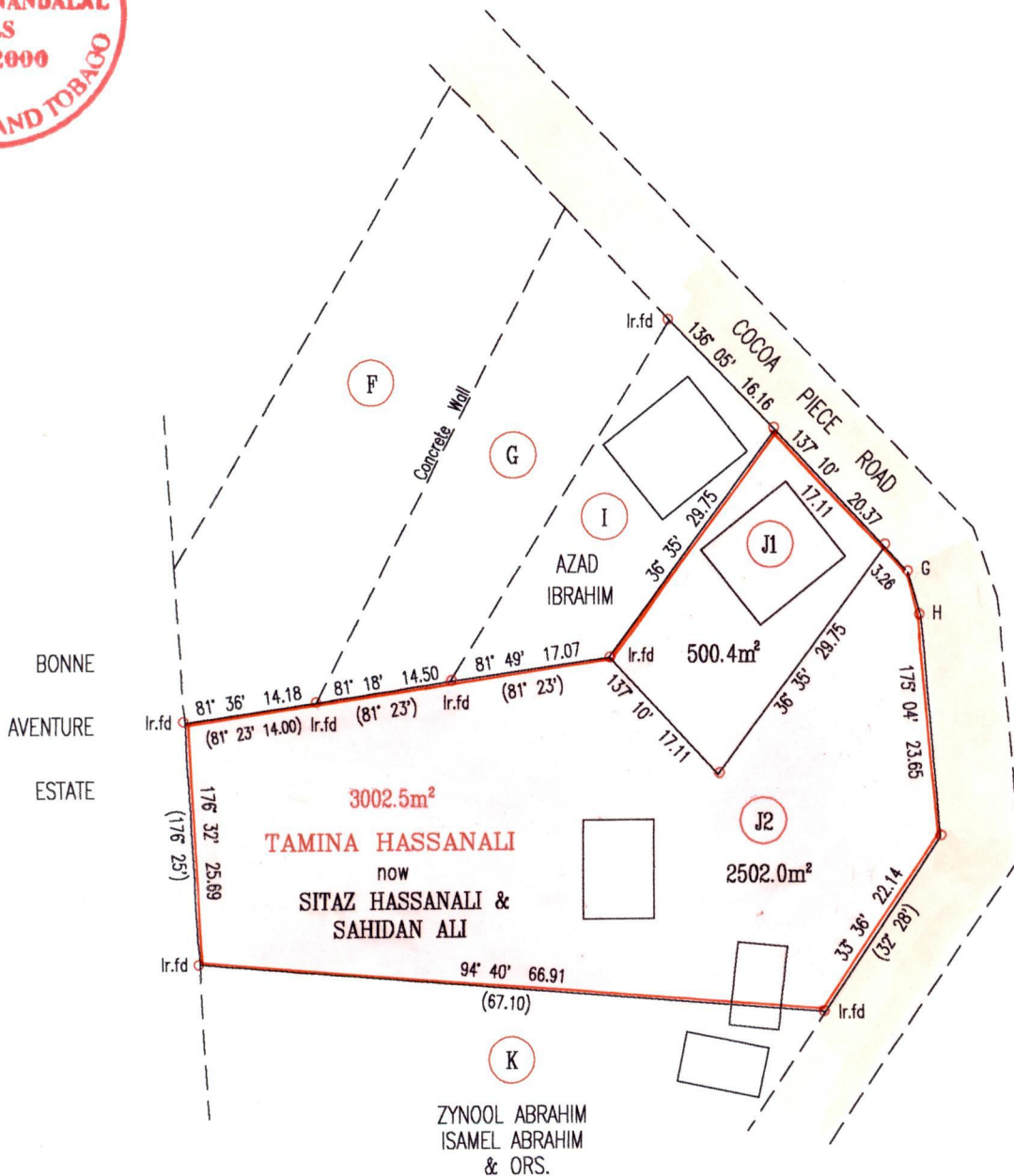

PLAN J.A. 160

LINE	BEARING	DIST.
G - H	161° 05'	5.00

Approved

[Signature]
Director of Surveys
2007.05.21

Bearings are Cassini Grid based on Solar Obs.

○ Denotes Iron Put unless otherwise stated

Plan of 2 Parcels of land coloured pink in the Ward of Pointe a Pierre
Containing together three thousand and two point four square metres
Surveyed by me, with due authority, in November 2000

In accordance with Rule 25(1) of the Land Surveyors' Regulations 1998, I certify that this plan is correct.

Checked by *[Signature]* 26 March 01

[Signature]

Entered on

Trinidad & Tobago Land Surveyor/..... 2000

SCALE 1:750

Distances are in Metres

Original Plan J.A 160

LOT. II CT. VOL. 5421 FOL. 435 - SAHIDAN ALI ALSO CALLED SAHIDAN MUMENA
& MOONTARGE ALI

LOT I2 CT. VOL. 5421 FOL. 433 - SUMINTRA HASSANALI



3008 2000
TAMBAH HASSANALI

30 NOV 2000
Lands and
Surveys
Division

Now 1A39/169
1267/9