

R.P.O. Vol. 8 Fol. 294

C.T. Vol. 1366 Fol. 153

Vide Bk. 926 fol 129

Vide Bk. 1128 fol 30

CT VOL 5181 fol 179

Cadastral Sheet G.13.C. 63F  
1/7b

Ward of Naparima

County of Victoria

Debe

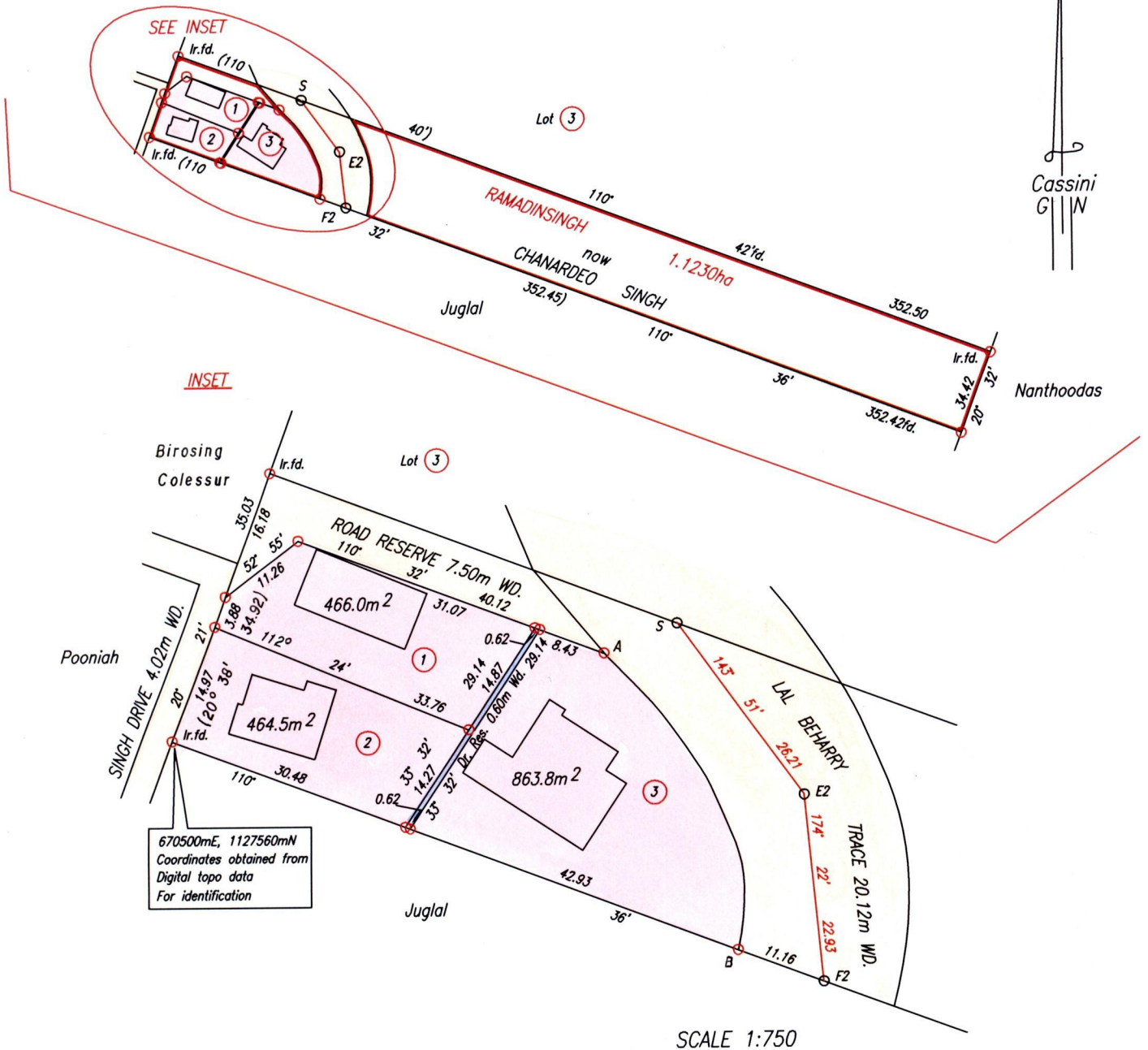

670500mE, 1127560mN  
Coordinates obtained from  
Digital topo data  
For identification

SCALE 1:750

NOTE: Lal Beharry Trace scaled from Bk. 926 fol. 129

LAL BEHARRY TRACE WIDE	B	Ir.put.
0.00	39.88	
3.80	32.30	
5.00	27.00	
5.10	23.00	
4.80	17.00	
3.50	10.00	
0.00	0	156° 02'
	A	Ir.put

Approved *[Signature]*  
Director of Surveys  
2009.8.27



SCALE 1:2500  
Distances are in Metres

○ Denotes Iron put except otherwise stated.  
Bearings are Cassini Grid based on Solar Observations.  
PLAN of a Parcel of land coloured pink in the Ward of Naparima  
Containing together one thousand, seven hundred and ninety four point three square metres.  
Surveyed by me, with due authority, in June, 2004  
In accordance with Regulation 25(1) of the Land Surveyors' Regulations 1998,  
I certify that this plan is correct.

Checked by *[Signature]* 27/8/09

Entered . . . . . Trinidad & Tobago Land Surveyor *[Signature]* 10<sup>th</sup> July . . . . . 2009  
PATH = EV700 E:\Drawings09\Singh(Ramai Trace)

LOT#	C.T VOL. §, Fol	NAMES.
1		
2		
3		
4		
5		
6		



1439/138  
#500/72