

R.P.O. Vol. 152 Fol. 185
C.T. Vol. 2835 Fol. 33
C-T VOL 5313 Fol 421

Cadastral Sheet G.29.E. & F. 74A
1/c
Ward of Siparia
County of St.Patrick.
8 M.M.,
Penal Rock Road

Bk.1137 fol 211
Bk.724 fol 149

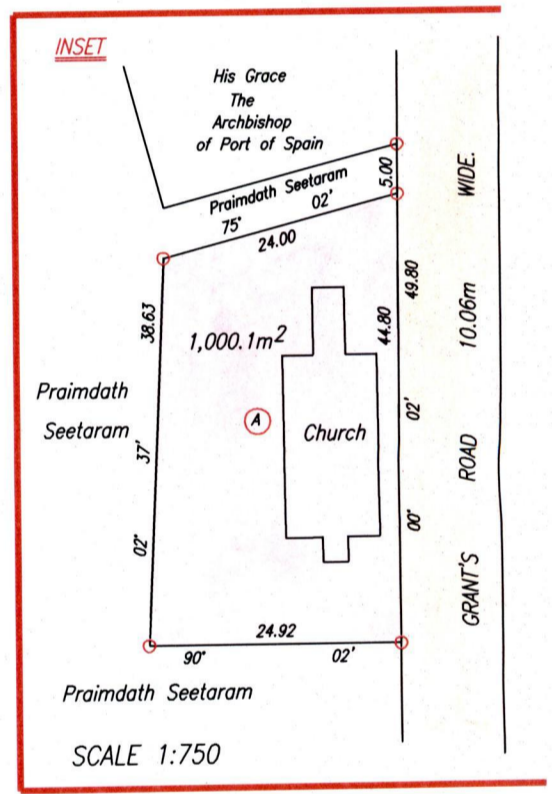
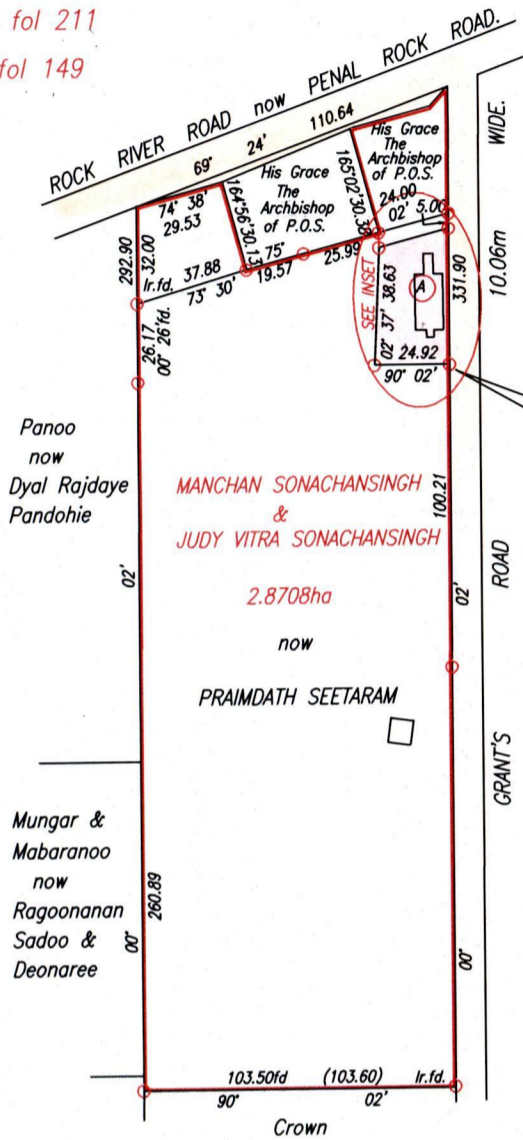

Approved 
Director of Surveys 2010.5.20

SCALE 1:2500
Distances are in metres

○ Denotes Iron put except where otherwise stated
Bearings are based on Solar Observations
PLAN a Parcel of land coloured pink in the Ward of Siparia
Containing one thousand point one square metres
Surveyed by me, with due authority, in December, 2009
In accordance with Regulation 25 (1) of the Land Surveyors' Regulations 1998,
I certify that this plan is correct.

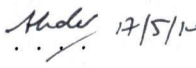
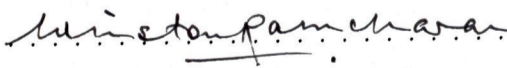

Checked by  17/5/10 

Entered on Trinidad & Tobago Land Surveyor. 6th May 2010.