

1439

1183

R.P.O Vol. 63 Fol. 301
C.T. Vol. 3431 Fol. 493
Vol. 5308 fol. 293

Ward of Naparima.
County of Victoria.
Cadastral Sheet G.13.F. 63F
1/d,2/c,3/b,4/a.

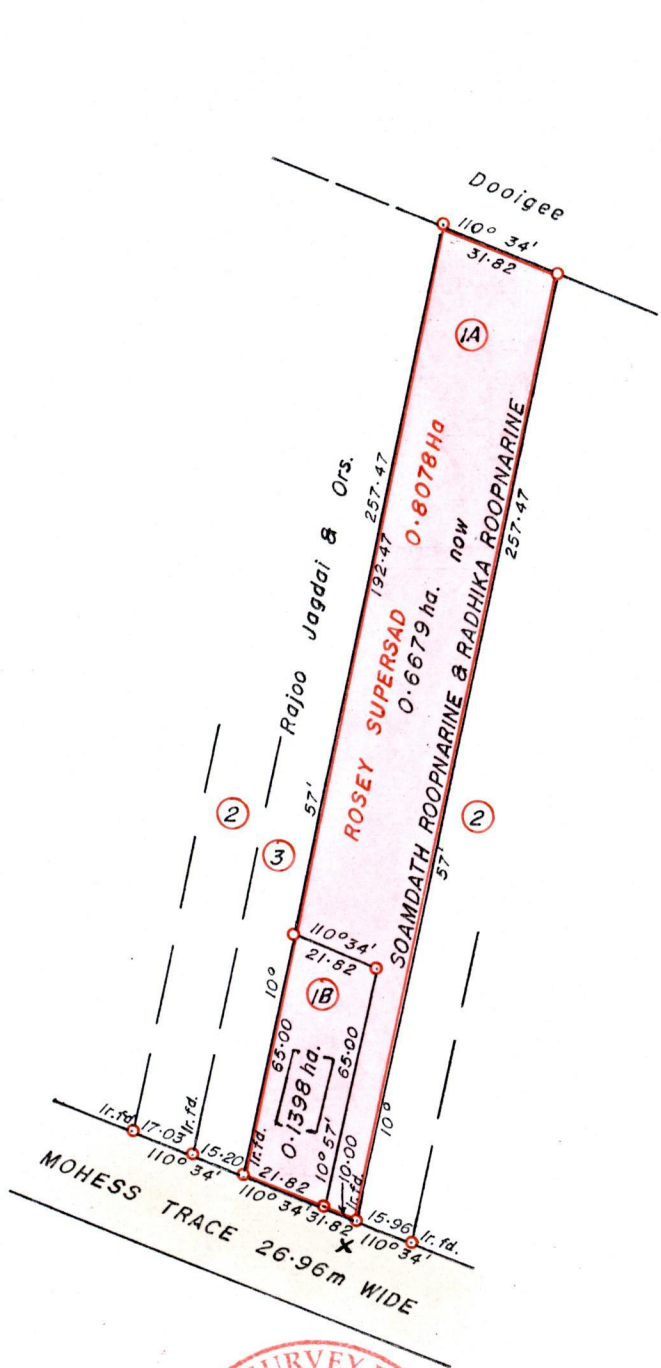

670360mE, 1126207mN.
X- U.T.M. 20, W.G.S. 84 (+/- 5.0m)
G.P.S. direct Obs.

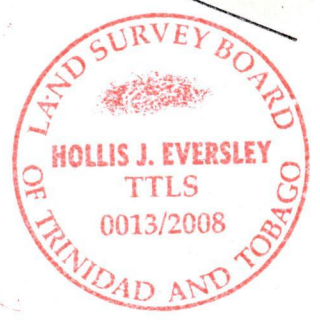

Bk. 1197 : 14
SCALE 1 : 2000.

Approved: [Signature]
Director of Surveys. 2010.5.21

Distances are in METRES
o Denotes Iron Put except otherwise stated
Bearings are Cassini Grid based on Solar Observations.

**PLAN of 2 Parcels of land coloured in PINK in the Ward of Naparima.
Containing together zero point eight zero seven seven hectare.
Surveyed by me, with due authority, in May 2008.
In accordance with Reg. 25(1) of the Land Surveyors' Regulations 1998,
I certify that this plan is correct.**

Checked by [Signature] 18/5/10

[Signature]
25 September 2008

Entered Trinidad and Tobago Land Surveyor 2008.

| Lot No. | Ct. Volume & Folio | Names |
|---------|--------------------|---|
| 1A | 5308 fol. 297 | SOAMDATH & VEENA ROOPNARINE, ASHA ROOPNARINE-SEEGULAM |
| 1B | 5308 fol. 303 | VEENA ROOPNARINE RAMROOP & VIRENDRA LAL |



NOW 1439/118
-1336/10