

1439

1

1E  
6/b/2

C.T. Vol. 2193 Fol. 67  
C.T. Vol. Fol.  
CT VOL. 5229 FOL 55

Cadastral Sheet 1.21.B  
Ward of Tobago  
Parish of St. Patrick

Vide

Plan FA 148  
C.T. Vol. 2193 fol 63  
C.T. Vol. 2193 fol 65  
C.T. Vol 2168 fol 207

Frank Lewis Latour  
&  
Charles Adrian Latour

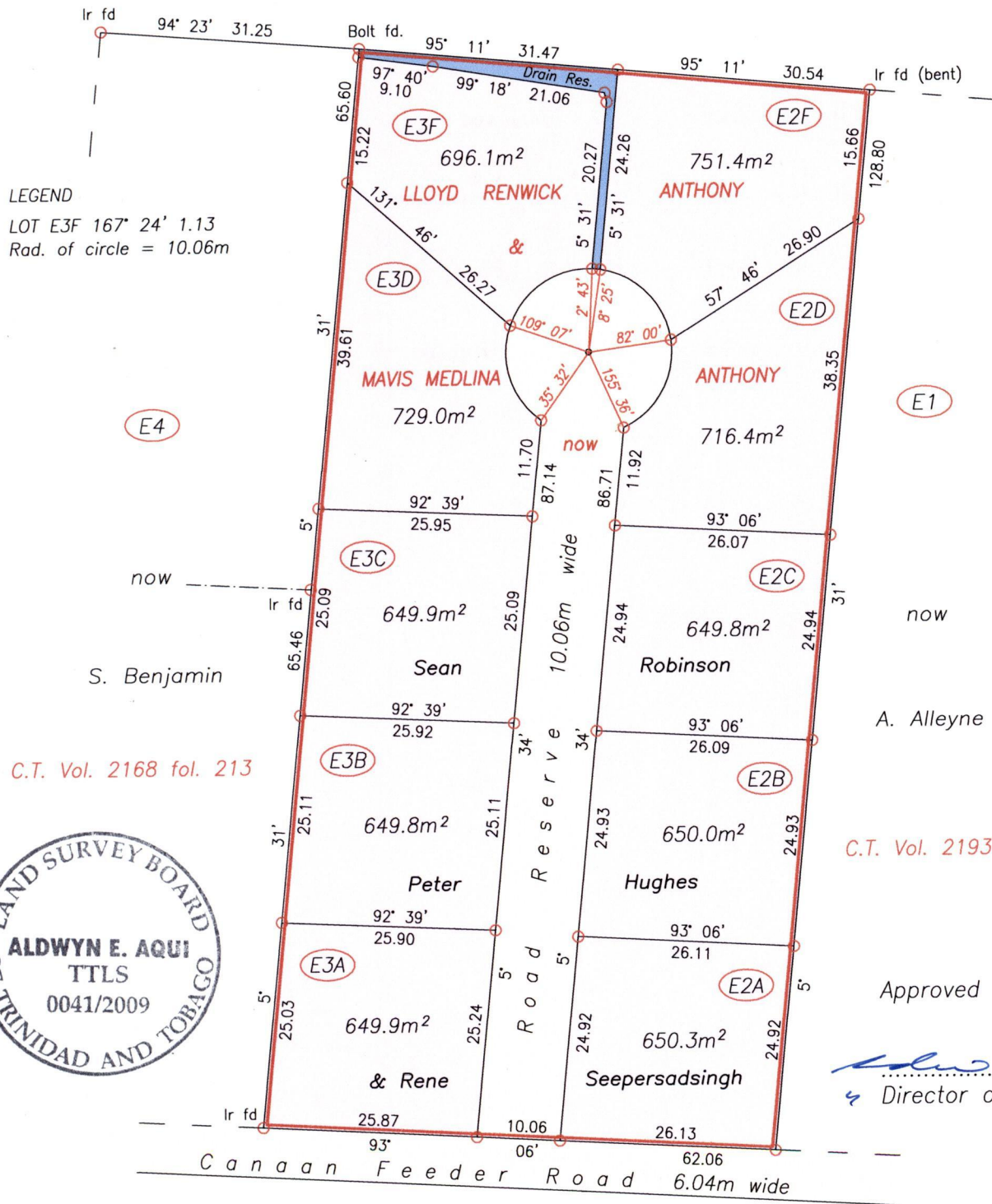

LEGEND  
LOT E3F 167° 24' 1.13  
Rad. of circle = 10.06m

C.T. Vol. 2168 fol. 213

C.T. Vol. 2193 fol 47

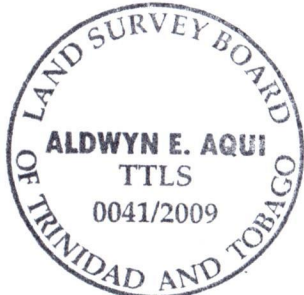

Approved  
*[Signature]*  
Director of Surveys 2010.2.2

N.B. Bearings are Cassini Grid, based on solar observations.  
N.B. ○ Denotes Iron put unless otherwise stated.

Scale = 1:750  
Distances are in metres

Plan of ten (10) parcels of land coloured pink in the Ward of Tobago containing together six thousand, seven hundred and ninety two point six sq.metres, surveyed by me, with due authority, in January 2007. In accordance with Reg. 25(1) of the Land Surveyors' Ordinance 1998, I certify that this plan is correct.

Checked by *[Signature]* 2/1/2010 ..... T.T.L.S.  
Entered on ..... Trinidad & Tobago Land Surveyor ..... 17. 12. 2009

LOT #	C.T VOL & FOLIO	NAMES
E2A	5501 fol. 281	KAMEIL MOHAMMED
E2B	5501 fol. 293	KEINO JOHN
E2C		THOMAS & LORRAINE PANTIN
E2D	5501 fol. 317	THOMAS & LORRAINE PANTIN
E2F	5501 fol. 331	DUANE LEE
E3A	5501 fol. 345	LA-VAUGHN CLARKE
E3B	5501 fol. 373	AVANT MAHARAJ
E3C	5501 fol. 387	RONNIE BOODOO
E3D	5501 fol. 413	JANICE TAYLOR
E3F		



now 1439/1  
+333/89