

To be brought under the provisions of the Real Property Ordinance

Cadastral Sheet 53F 1/c & G.3.F. S.W.

Ward of Naparima County of Victoria

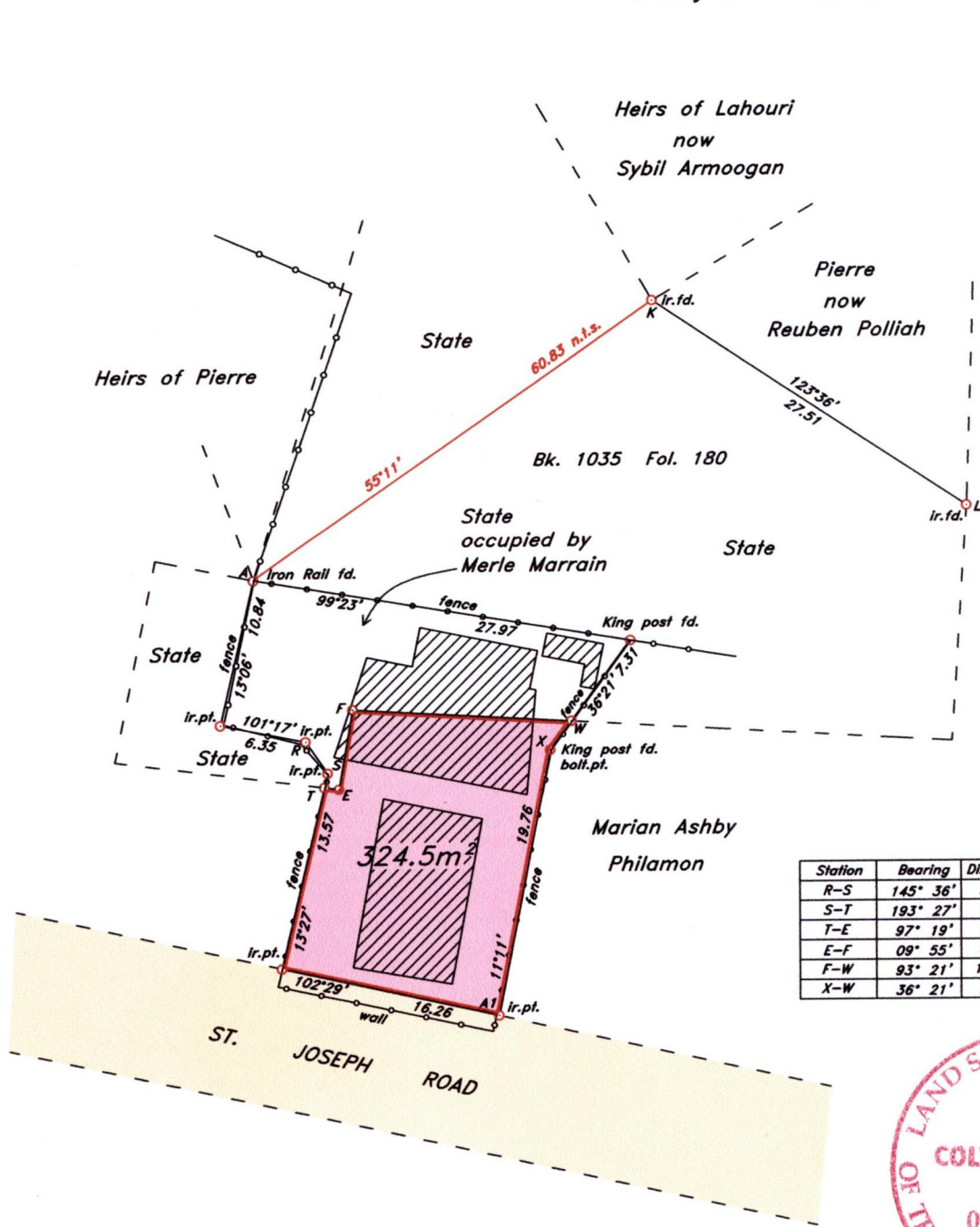

Station	Bearing	Distance
R-S	145° 36'	2.85
S-T	193° 27'	1.07
T-E	97° 19'	1.07
E-F	09° 55'	5.94
F-W	93° 21'	16.05
X-W	36° 21'	2.61



Approved *[Signature]*
 Director of Surveys
 2009.8.27

Station A1 : (0669592m E, 1137428m N)
 U.T.M (WGS 84) Coordinate
 zone. 20 (Accuracy ± 3.0m)

○ Denotes No Iron Put unless otherwise stated.
 Bearings are Cassini Grid, based on Solar Observations.

SCALE 1 : 500
 Distances are in metres.

PLAN of a Parcel of land coloured pink in the Ward of Naparima
 Containing Three Hundred and Twenty Four Point Five Square Metres
 Surveyed by me, with due authority on the 12th March 2009 for Merle Marrain
 In accordance with Regulation 25 (1) of the Land Surveyors' Regulations 1998, I certify
 that this plan is correct.

Checked by *[Signature]* 24/8/09
 Entered on

[Signature]
 Trinidad and Tobago Land Surveyor 27th April 2009.