

Ward of Naparima  
 County of Victoria  
 Cadastral Sheet ( G.4.F. ) 54.D.  
 1/b  
IERE VILLAGE

E 0676213  
 N 1137593  
 Reading taken with  
 Handheld G.P.S.  
 Garmin 76S  
 U.T.M. Zone 20  
 Naparima  
 ± 5 m.

To be brought under the Provisions  
 of the Real Property Ordinance

A - B 107° 46' 87.71

Vide Bk. 1233 fol. 188  
 Rampersad Baboolal

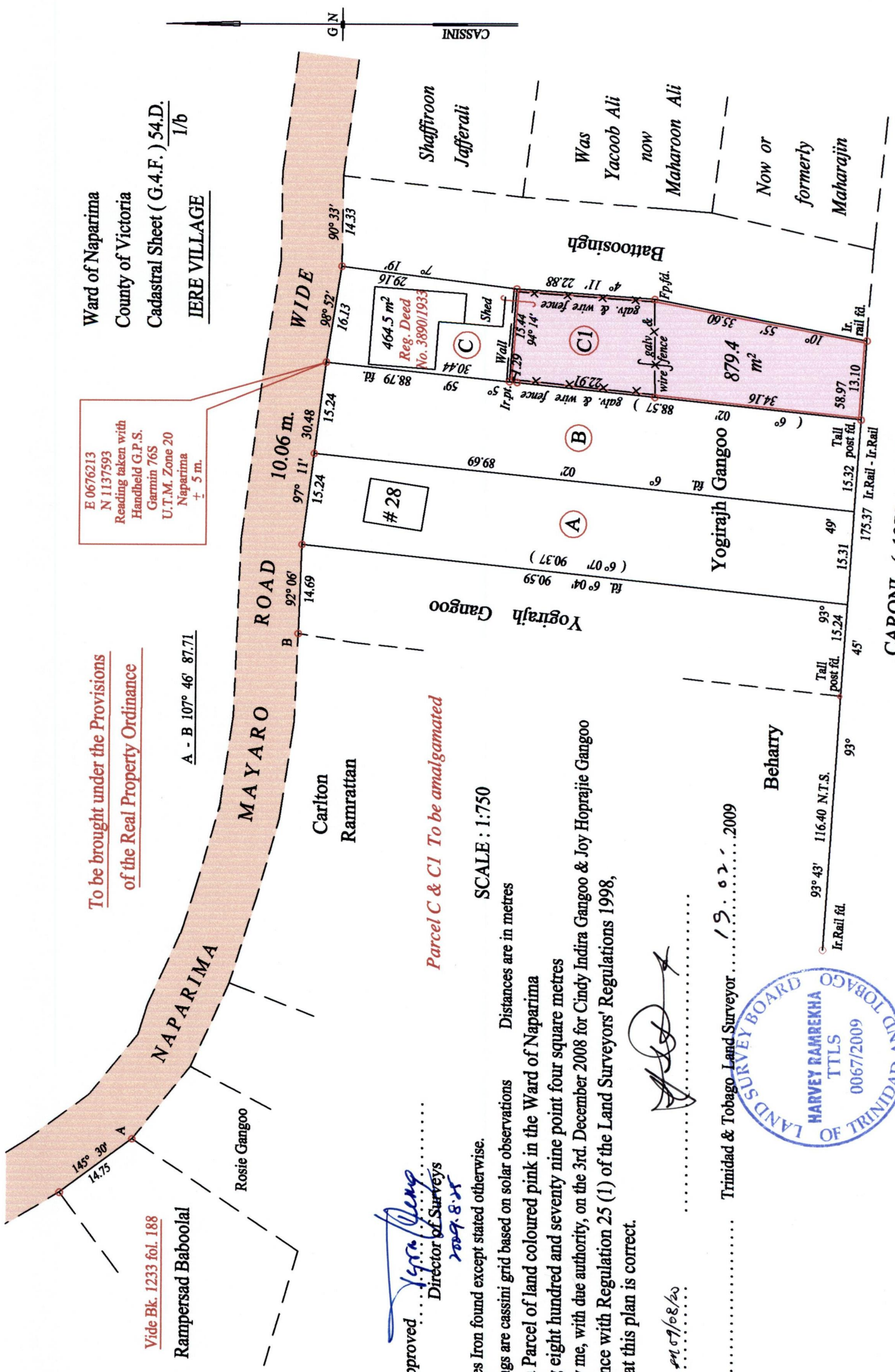

Approved .....  
 Director of Surveys  
 2009.8.25

○ Denotes Iron found except stated otherwise.

Note: Bearings are cassini grid based on solar observations Distances are in metres  
 PLAN of a Parcel of land coloured pink in the Ward of Naparima  
 Containing eight hundred and seventy nine point four square metres  
 Surveyed by me, with due authority, on the 3rd. December 2008 for Cindy Indira Gangoo & Joy Hoprajie Gangoo  
 In accordance with Regulation 25 (1) of the Land Surveyors' Regulations 1998,  
 I certify that this plan is correct.

Checked by 01/08/2009

Entered on ..... Trinidad & Tobago Land Surveyor ..... 15.02.2009



CARONI ( 1975 ) LTD.