

1436

222

Process ID#80800

Cadastral Sheet B.24.D 24C
Borough of Arima 1/d
County of St. George

To be brought under the provisions of The Real Property Ordinance

Plan CK 39
Bk. 1055/212
Bk. 1262/168
Bk. 885/93

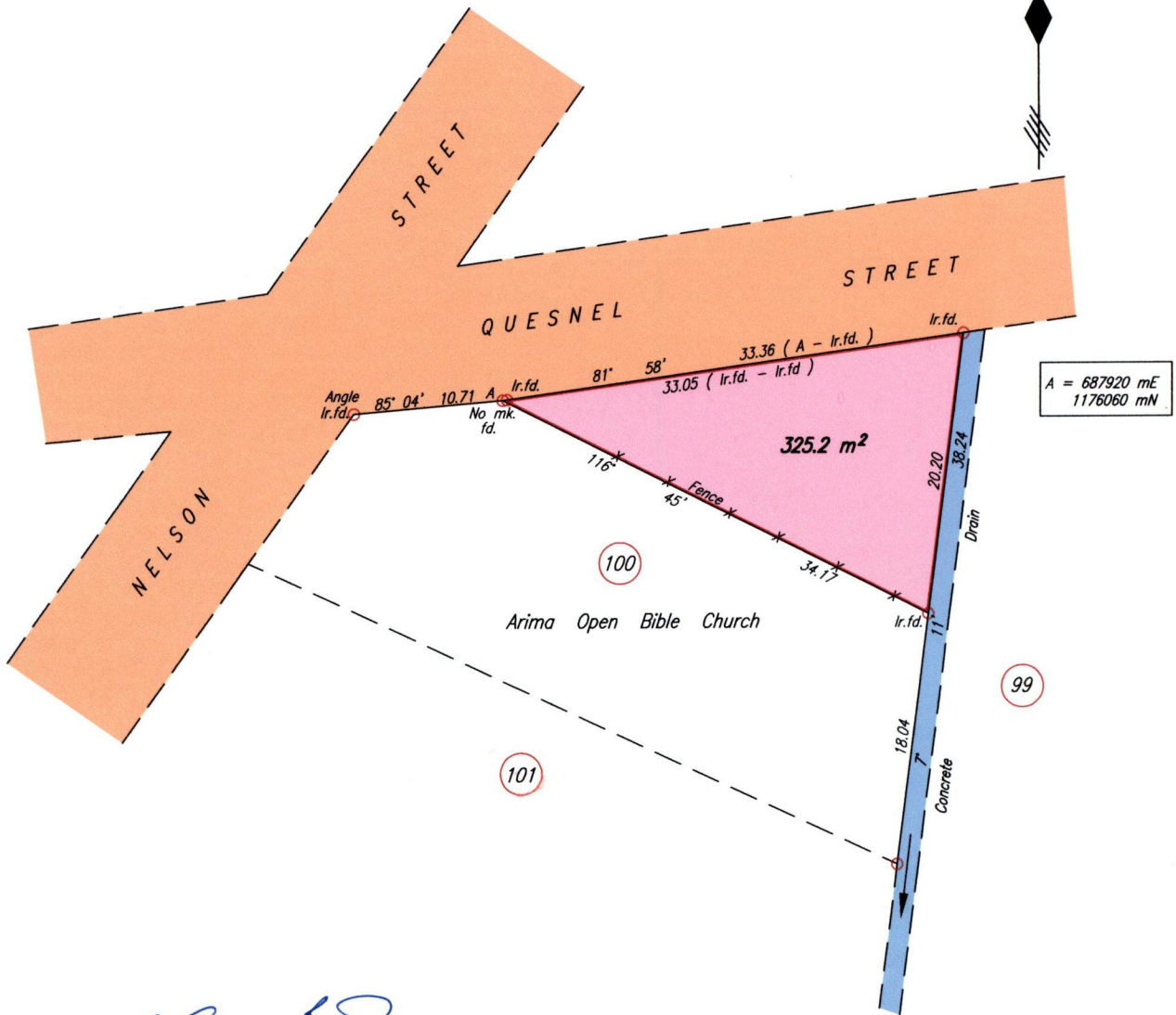

Approved: *[Signature]*
Director of Surveys 2010.8.5

SCALE 1:500

Distances are in METRES

○ Denotes Iron found

To obtain Cassini bearings add 18'

Coordinates are UTM zone 20 Naparima Datum +/-5m scaled from L&S 1/2500 Sheet

Bearings are UTM Grid based on Solar Observations

Containing three hundred and twenty five point two square metres

Surveyed by me with due authority on the 7th of June 2008 for The Incorporated Trustees of the Open Bible Standard Churches of Trinidad and Tobago

In accordance with Regulation 25 (1) of The Land Surveyors' Regulations 1998,

I certify that this plan is correct.

Checked by *[Signature]*

Camille Fortune-Rollock TTLS

Entered on

Trinidad & Tobago Land Surveyor 17th July 2008

THIS IS THE Survey Plan referred to and marked (A)
in the annexed Statutory Declaration of
Camille Fontone - Rollock.

Nancy Nicholson-Stewart
NANCY NICHOLSON-STEWART
ATTORNEY-AT-LAW



Handwritten text, possibly a signature or date, partially obscured.