

14-1436

140

Cadastral Sheet 64A (G.9.N.)  
3/b

To be brought under the provisions of the  
Real Property Ordinance

Ward of Naparima

County of Victoria

PROCESS 10# 80621

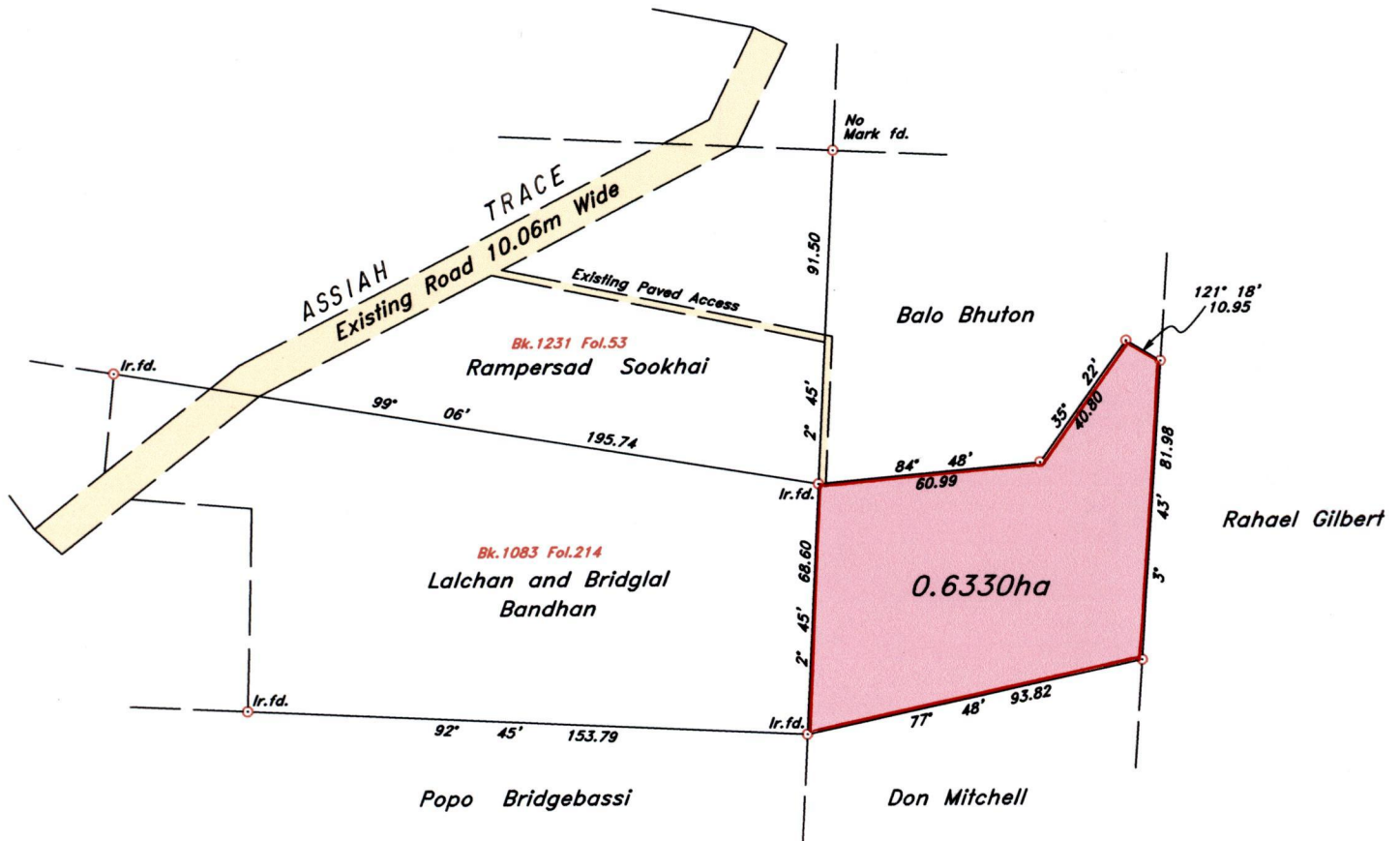

Approved   
9 Director of Surveys 2010.2.3



SCALE 1 : 2000

Distances are in metres.

○ Denotes Iron Put unless otherwise stated.  
Bearings are Cassini Grid, based on Solar Observations.

PLAN of a Parcel of land coloured pink in the Ward of Naparima

Containing Zero Point Six Three Three Zero Hectares.

Surveyed by me, with due authority on the 11th November 2003 for NORA GEORGE

In accordance with Regulation 25 (1) of the Land Surveyors' Regulations 1998, I certify  
that this plan is correct.

Checked by  26.9.07

Entered on .....

  
Trinidad and Tobago Land Surveyor 18th March 2007