

1434

1434/116

96

To be brought under the Provisions of The Real Property Ordinance.

Cadastral Sheet D.5.L.  $\frac{35A}{27a}$

Ward of Tamana.

County of St. Andrew.

PROCESS ID # 47194

See Bk.13 fol. 142  
Bk.1198 fol. 47

G. N. Cassini

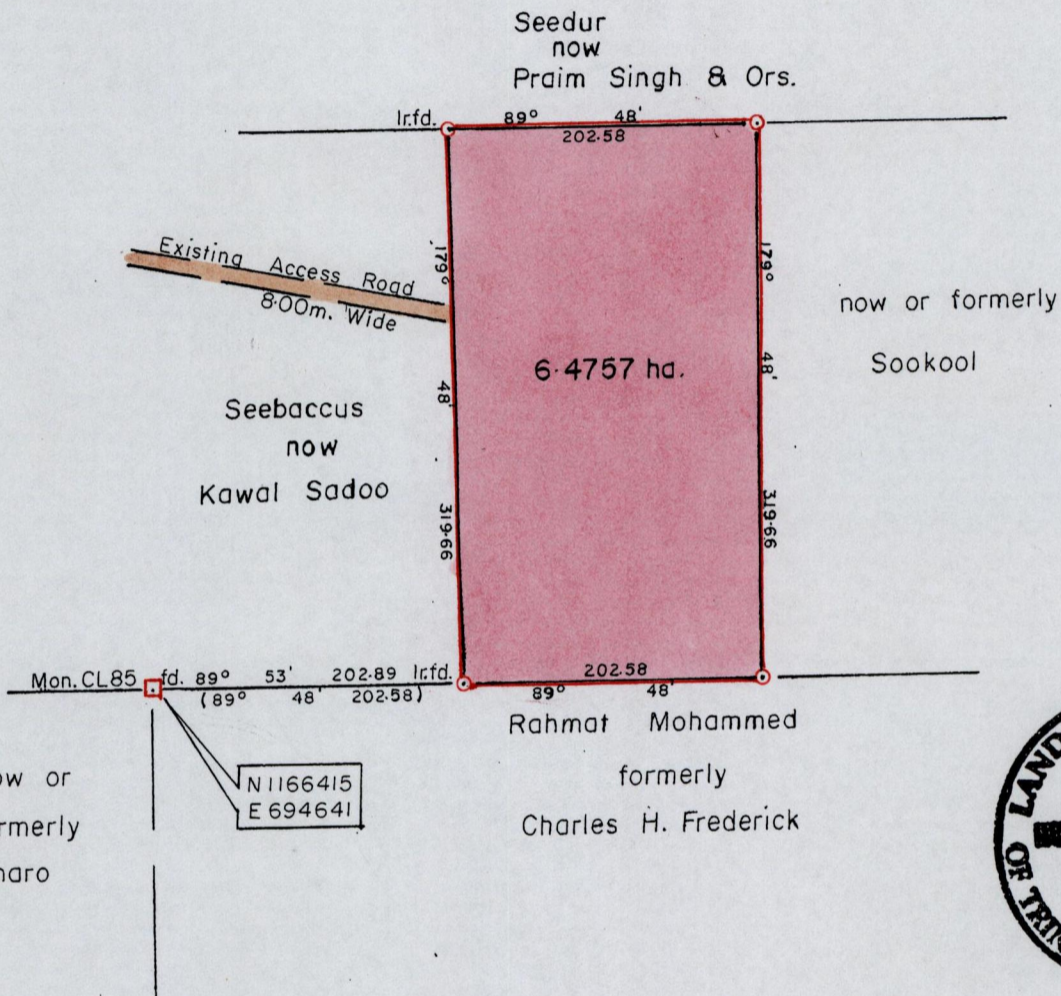

SCALE 1/5000

Distances are in metres

Approved *[Signature]*  
Director of Surveys 2013.1.7

○ Denotes Iron put except where otherwise stated

Coordinates based on hand held G.P.S. (Naparima 20) ± 5m.

Bearings are based on Solar Observations

PLAN of a Parcel of land coloured pink in the Ward of Tamana.

Containing six point four seven five seven hectares.

Surveyed by me, with due authority, on 5<sup>th</sup> November 2010 for Goorcharan Sadoo.

In accordance with Regulation 25 (1) of the Land Surveyors' Regulations 1998,

I certify that this plan is correct.

Checked by. *[Signature]* 21/1/13

*[Signature]*

Entered on. . . . .

Trinidad & Tobago Land Surveyor. 21<sup>st</sup> February 2011.