

1434

TO BE BROUGHT UNDER THE PROVISIONS OF THE REAL PROPERTY ORDINANCE

Cadastral Sheet A.20.K, 13E  
Ward of St. Anns 3/c  
County of St. George

69

GONZALES

Anthony James  
&  
Elizabeth Pivott  
Sydney

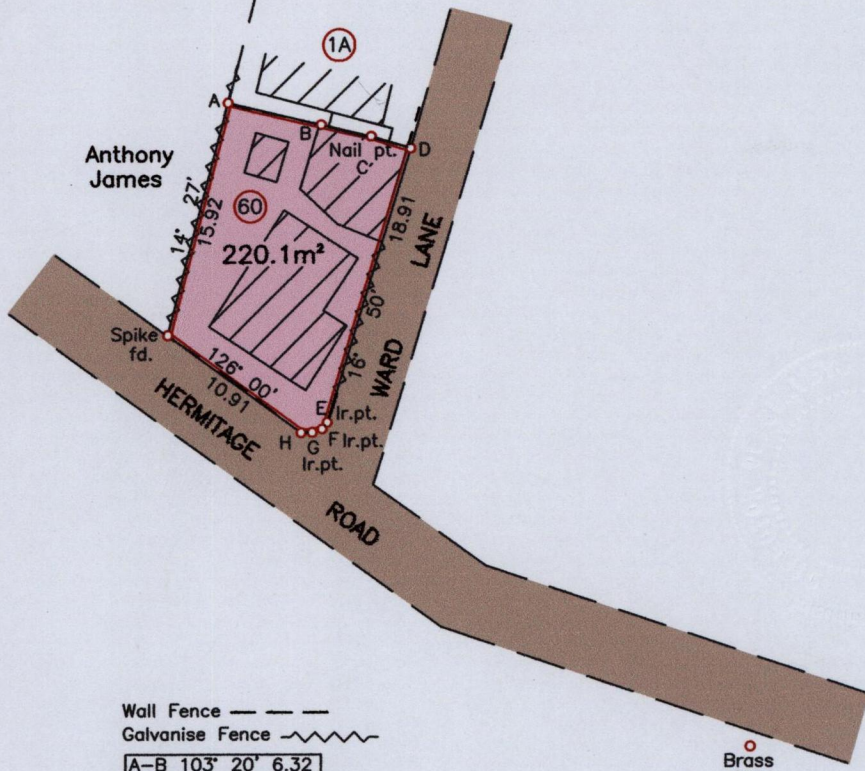

Wall Fence ---  
Galvanise Fence ~~~~~

A-B	103° 20'	6.32
B-C	103° 20'	3.40
C-D	107° 13'	2.73
E-F	217° 27'	0.56
F-G	251° 50'	0.69
G-H	268° 12'	0.73
H-Brass R20	116° 57'	64.04 (nts)

Ir.fd.=H:- N:1178741m  
E:663466m  
UTM 20, NAP Datum ± 7m  
GPS Direct Observation (Hand Held)

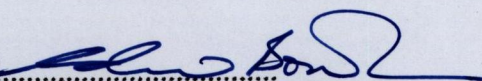

Approved:   
Director of Surveys 2012.10.9

SCALE 1/500  
Distances are in Metres

o Denotes Iron found except otherwise stated  
Bearings are Cassini Grid based on Solar Observations  
Plan of a Parcel of land coloured pink in the Ward of St. Anns  
Containing two two zero point one square metres  
Surveyed by me with due authority, on December 05, 2008 for Vanessa Holder & Fanny Plato  
In accordance with Regulation 25 (1) of the Land Surveyors' Regulations 1998,  
I certify that this plan is correct.

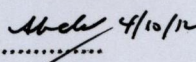
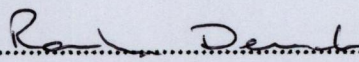
Checked by:  4/10/12 

Entered..... Trinidad & Tobago Land Surveyor December 10, 2008