

1434

688

U.P.R.N.....

Cadastral Sheet A.20.G.  $\frac{13F}{3/a}$   
City of Port of Spain  
County of St. George

To be brought under the provisions  
of The Real Property Ordinance

PROCESS ID # 53662

BELMONT

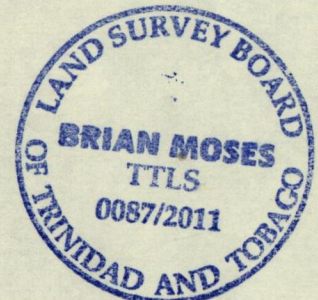
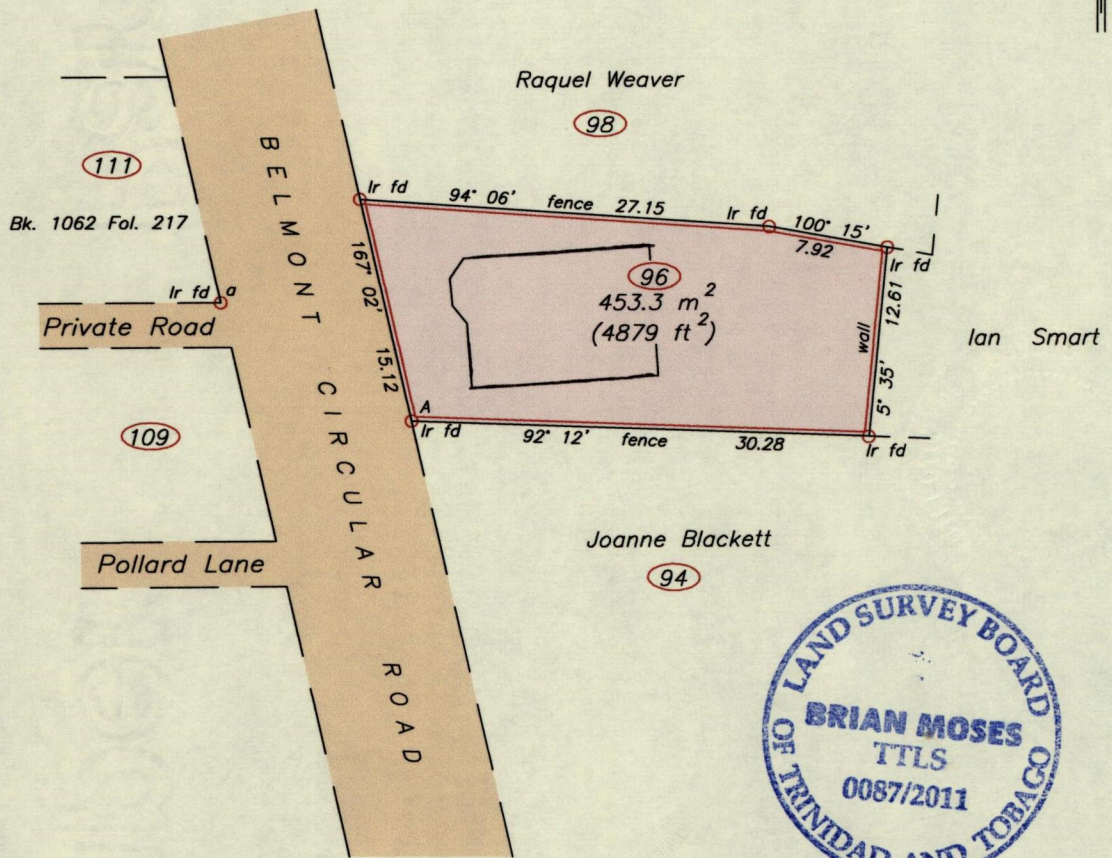
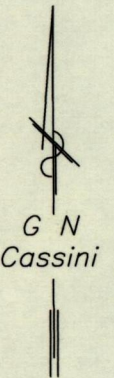

Legend

a - A 122° 10' 14.90

A - N 1179555  
E 663508

Derived From Hand-Held GPS (+/-5 m)  
UTM Zone 20 Naparima Co-ordinates

Approved   
Director of Surveys 2012.10.9

SCALE 1:500  
Distances are in METRES

Bearings are Cassini Grid based on Solar observations

PLAN of a Parcel of land coloured pink in the City of Port of Spain  
Containing four five three point three square metres  
Surveyed by me, with due authority, on 10th December, 2011 for Joyce Skinner  
In accordance with Regulation 25 (1) of the Land Surveyors' Regulations 1998,  
I certify that this Plan is correct.

Checked by 4/10/12

Trinidad & Tobago Land Surveyor (T.T.L.S.)  
29<sup>th</sup> December 2011

Entered on .....