

To be brought under the Provisions of The Real Property Ordinance

Ward of Naparima  
County of Victoria  
Cadastral Sheet G. 8 E. 54 F.  
3 / b

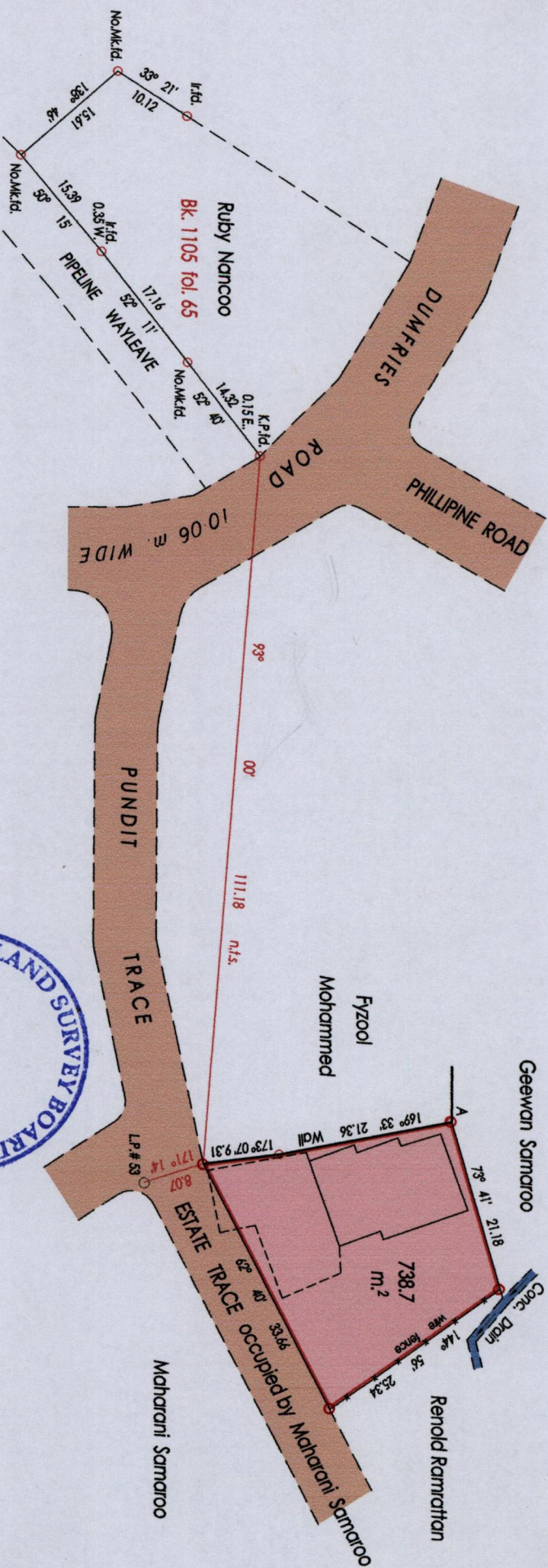

SCALE 1 : 750

A = N. 1131357 E. 668318  
U.T.M. Zone 20 Naparima +/- 5.00 m.  
Hard Held G.P.S.

Approved: *[Signature]*  
Director of Surveys 22/11/13  
Bearings are U.T.M. Grid based on Solar Observations Distances are in Metres  
PLAN of a Parcel of land coloured pink in the Ward of Naparima  
Containing seven hundred and thirty eight point seven sq. metres  
Surveyed by me, with due authority on 15<sup>th</sup> April 2012 for Peer Mohammed Khan  
Certified correct in accordance with Regulation 25 (1) of the Land Surveyors Regulations 1998,

○ Denotes Iron Put Except Stated Otherwise

Checked by.....

*[Signature]*  
Trinidad & Tobago Land Surveyor

Entered on.....

Trinidad & Tobago Land Surveyor. 15<sup>th</sup> April... 2013