

RPO Vol 152 Fol 253
CT Vol 2696 Fol 503

Cadastral Sheet G.13.C., 63F
County of Victoria 1/b
Ward of Naparima
DEBE

PROCESS ID # 56107

Ref. Bk 1124 Fol 223

Irfd A
Hand-held GPS
UTM Zone 20, Naparima
E 670880 ± 5m
N 1126460

Seon
then
Chadee
Bk 763 Fol 88

Bk 985 Fol 48
Seetul
then
& Raghunanan

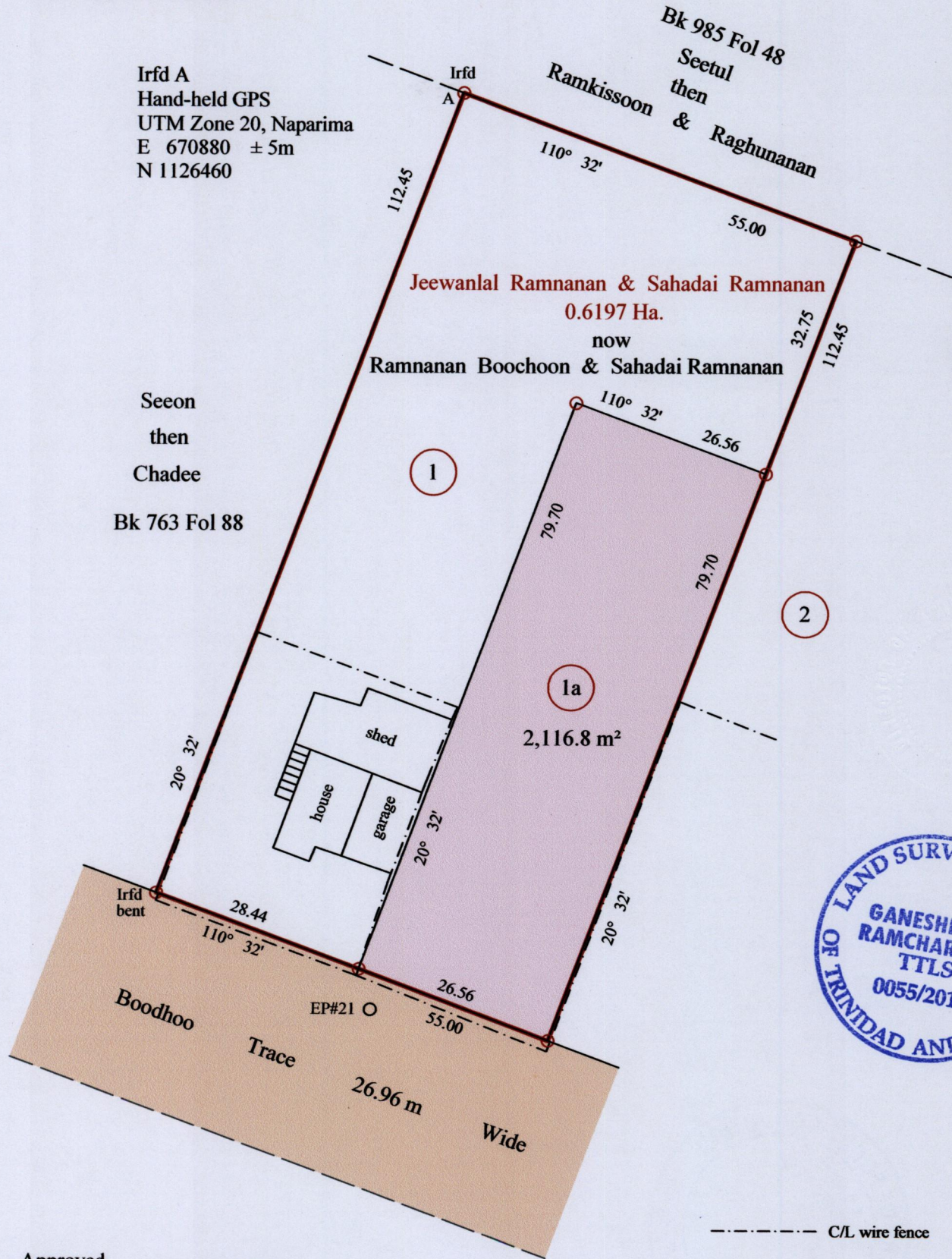
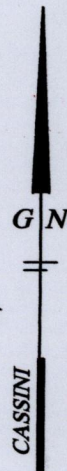

----- C/L wire fence

Approved

[Signature]
Director of Surveys 2012.8.15

o denotes Iron Put except otherwise stated
Bearings are Cassini Grid based on Solar Obs.
Distances are in Metres
SCALE 1/750

PLAN of a parcel of land coloured pink in the Ward of Naparima
Containing two thousand one hundred and sixteen point eight square metres
Surveyed by me, with due authority, in March 2012.
In accordance with Regulation 25 (1) of the Land Surveyors' Regulations 1998,
I certify that this plan is correct.

Checked by *[Signature]*
Entered on
Trinidad and Tobago Land Surveyor 13/7 2012

