

1433

834

PROCESS ID # 44531

R.P.O. Vol. 204

C.T. Vol. 1134

Fol. 119

Fol. 29

Cadastral Sheet E.12.G. 36D

Ward of Turure

County of St. Andrew

See Bk.1108 Fol.74

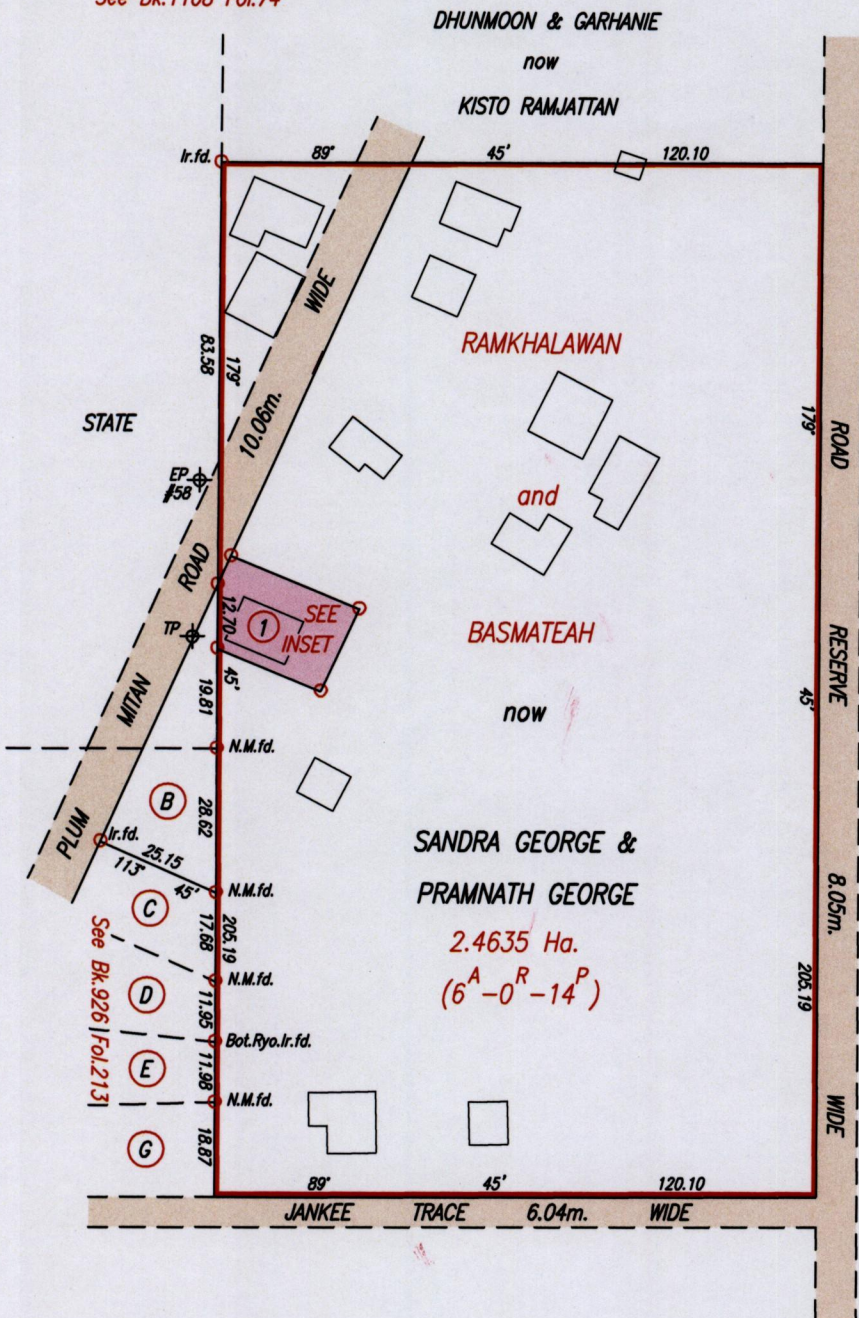

UTM (Nap.) co-ord of 'a'
 (Handheld GPS) +/-5m
 N 1156651 m
 E 708223 m

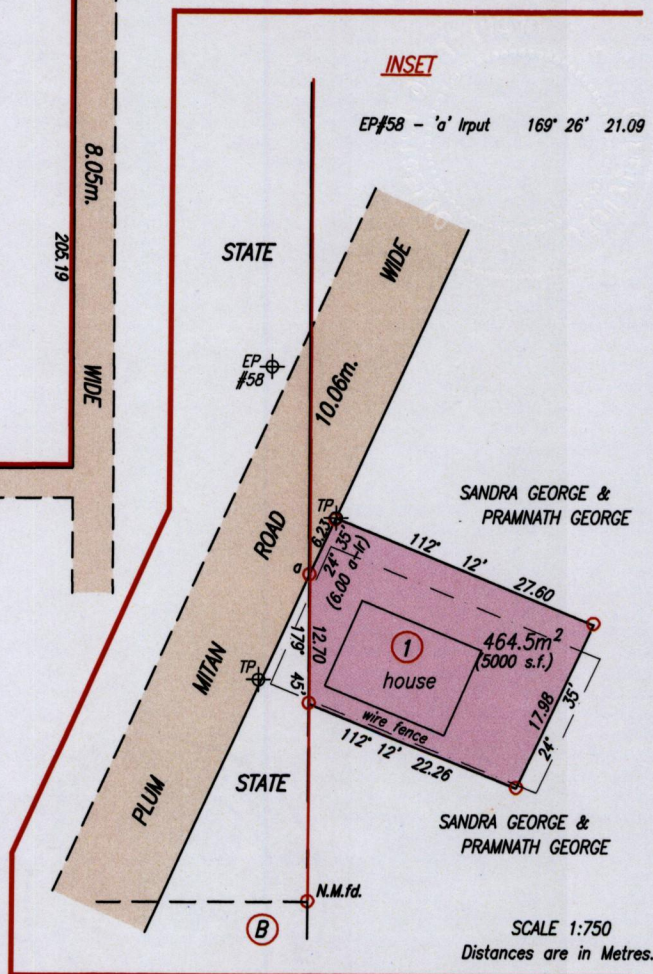

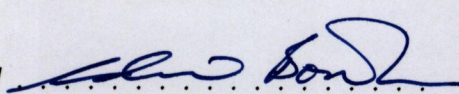
Approved 
 Director of Surveys 2012.8.15

○ Denote Iron Put unless otherwise stated
 Bearings are Cassini and based on Solar Observations

PLAN of a Parcel of land coloured pink in the Ward of Turure
 Containing four hundred and sixty four point five square metres
 Surveyed by me, with due authority, in February 2011
 In accordance with Regulation 25 (1) of The Land Surveyors' Regulations 1998,
 I certify that this plan is correct.

HR-19/08/12

Checked By

Entered On

Trinidad & Tobago Land Surveyor. . . . 10 August, 2012.

SCALE 1:1500
 Distances are in Metres.

