

R.P.O. Vol. 156 Fol. 253
C.T. Vol. 3315 Fol. 129
PROCESS ID# 48813

Ward of Siparia
County of St. Patrick
Cadastral Sheet G.13.O. 63 F
3/d

Ref Bk. 1376 fol. 45

#153 Daybidial Road Penal

CASSINI

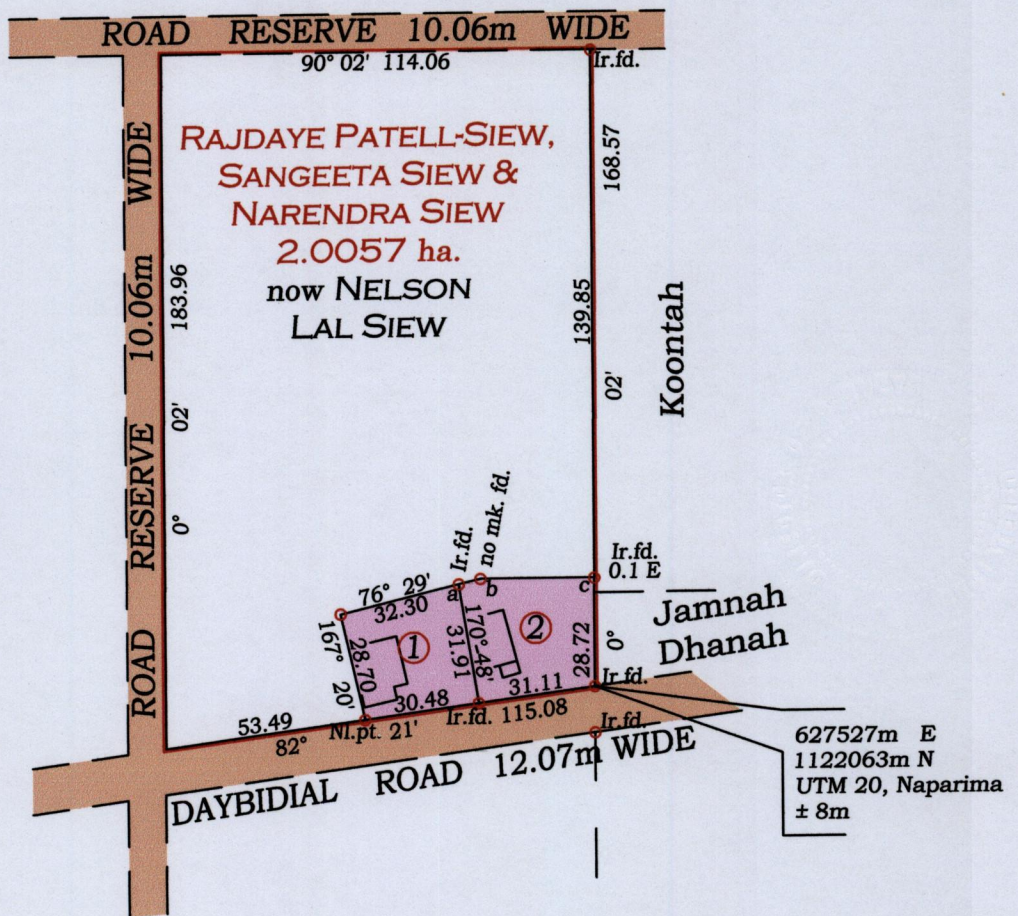

a - b	76° 29'	5.90
b - c	90° 02'	30.22 (30.32 to Ir.)

APPROVED

[Signature]
DIRECTOR OF SURVEYS
2012.8.10

Area ① - 949.5 m²
Area ② - 1033.3 m²

o Denotes Iron put except stated otherwise.

SCALE : 1:1500

Note: Bearings are cassini grid based on solar observations

Distances are in metres

PLAN of 2 Parcels of land coloured pink in the Ward of Siparia

Containing together one thousand nine hundred and eighty two point eight square metres
Re-surveyed by me, with due authority, in February 2012

In accordance with Regulation 25 (1) of the Land Surveyors' Regulations 1998,
I certify that this plan is correct.

Checked by *MM 2/8/2012*

[Signature]

Entered onTrinidad & Tobago Land Surveyor 22nd June 2012

LOT #	e.T. Vols' Folio	Names
1	5665 fol 471	Nimala Lutchman Balkaran Rosalin Lutchman, Nansa Lutchman
2		



1433/B2