

REMAINING PORTION

R.P.O Vol. 559 Fol. 559
C.T. Vol. 1191 Fol. 437
PROCESS ID # 51572

Ward of Siparia.
County of St. Patrick.
Cadastral Sheet G.14.I. 64D
3/c

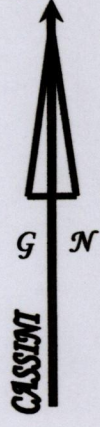
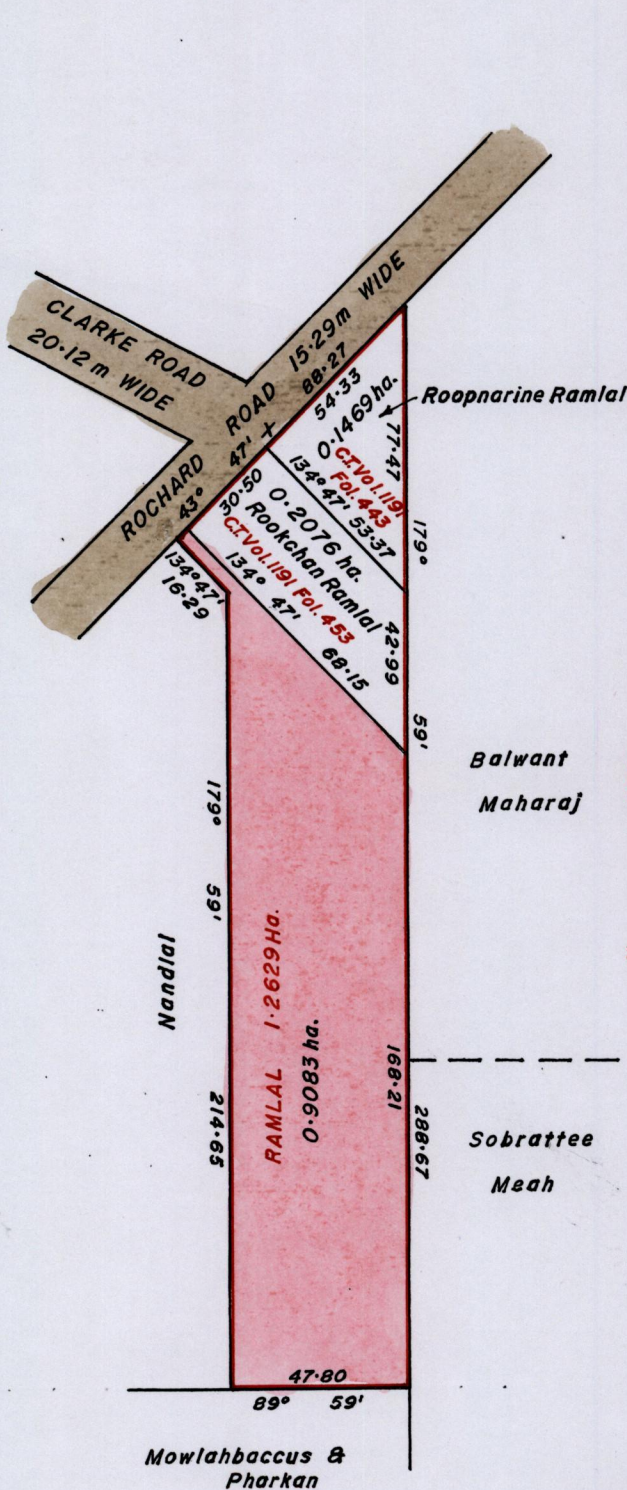

X
1123413 m N, 675428 mE.
U.T.M. 20, WGS 84 (+/- 3.0m)
GPS Handheld Direct Obs.

Bk. 1010 : 45

SCALE 1 : 2000.
Distances are in METRES

Approved *[Signature]*
Director of Surveys. 2012.7.18

This is a true copy of a diagram of one point two six two nine hectares. Originally transferred to RAMLAL showing a portion coloured pink and containing zero point nine zero eight three hectare, being the remainder, after two (2) previous transfers of another portion of the land. In accordance with Reg. 25(1) of the Land Surveyors' Regulations, 1998, I certify that this plan is correct.

Checked by *[Signature]* 2012.07.18
Entered

[Signature]
Trinidad and Tobago Land Surveyor..... 26 December 2011.



1433/68